



विद्यारत्नम् महच्छनम्

राजीव गाँधी पेट्रोलियम प्रौद्योगिकी संस्थान जायस, अमेठी,
उ. प्र.

RAJIV GANDHI INSTITUTE OF PETROLEUM TECHNOLOGY
JAIS, AMETHI (U.P.) – 229 304
Website: www.rgipt.ac.in

E-TENDER FOR INTERIOR WORKS
(CIVIL, ELECTRICAL, DUCTABLE SPLIT AC AND LAN NETWORKING)
AT 4TH FLOOR OF COMPUTER CENTER AND LIBRARY BUILDING

PART – A : TECHNICAL BID

NOTICE INVITING TENDER NO. : RGIPT/JAIS/IWD/INTERIOR/01/2020-21
DATED: 12.10.2020

Last Date & Time of Submission: 02/11/2020 (Monday) by 3:00 P.M

RAJIV GANDHI INSTITUTE OF PETROLEUM TECHNOLOGY

JAIS, AMETHI (U.P.) – 229 304

Tender Documents for Interior Works (Civil, Electrical, Ductable Split AC and LAN Networking) at 4th floor of Computer Centre & Library Building at RGIPT, Jais Campus

TABLE OF CONTENTS		
Sl. No.	Description	Page No.
	Technical Bid (Part A)	
01.	Notice Inviting Tender	3 – 4
02.	Instructions For Online Bid Submission	5 – 7
03.	Instruction to Bidders	8 – 12
04.	General Conditions of the Contract	13 – 30
05.	Special Conditions of the Contract	31 – 32
06.	Specifications	33 – 33
07.	Scope of Work	34 – 35
08.	List of Approved Makes	36 – 40
09.	Drawings	41 – 48
10.	Annexure -1 (Technical Bid Format)	49 – 50
11.	Annexure - 2 (Acceptance of Tender Conditions)	51 – 52
12.	Annexure -3 (Average Annual Financial Turnover)	53 – 53
13.	Annexure -4 [Letter of Award (LOA)of Contract]	54 – 54
14.	Annexure -5 [Proforma of Bank Guarantee (Performance)]	55 – 56
15.	Annexure -6 (Agreement Form)	57 – 59
16.	Annexure -7 (No Claim Certificate)	60 – 60
17.	Annexure -8 (Form of Declaration regarding Blacklist/ Debar/Integrity)	61 – 61
18.	Check List	62 – 62
	Price Bid (Part B)	
19.	Price Bid	64 – 102

NOTICE INVITING E-TENDER

Rajiv Gandhi Institute of Petroleum Technology (RGIPT) invites item rate (unit rate) e-tender under Two Part Bid System (Technical Bid and Financial Bid) from reputed, experienced and financially sound parties for Interior Works (Civil, Electrical, Ductable Split AC and LAN Networking) at 4th Floor of Computer Centre & Library Building at RGIPT Jais Campus.

Name of the Work	Interior Works (Civil, Electrical, Ductable Split AC and LAN Networking) at 4th Floor of Computer Centre & Library Building.
Type of Tender	Item Rate tender
Notice Inviting Tender No.	Tender No: RGIPT/JAIS/IWD/INTERIOR/01/2020-21, Date- 12/10/2020
EMD (Earnest Money Deposit)	Rs.2,50,000/- (Rupees Two Lac Fifty Thousand Only) through e-payment Gateway available on https://rgipt.euniwizarde.com
e-Tender Processing Fee (ITI LIMITED)	Rs.8,850/- through e-payment Gateway available on https://rgipt.euniwizarde.com
Work Completion Period	The work completion period of contract shall be of 150 days from date of issue of Letter of Award.
Performance Guarantee	5.00 % (Five Percent Only) of contract value within 10 days from the issue of Letter of Award.
Security Deposit / Retention Money	5.00% (Five Percent Only) of the gross value of each running/ final bill
Defect Liability Period	Twelve (12) months from the date of taking over of the works by the RGIPT.
Time allowed for starting the work	The date of start of contract shall be reckoned from 10 days after the date of issue of letter of Award.
Issue of Tender	The Tender document link can be obtained from the Institute website – www.rgipt.ac.in and https://rgipt.euniwizarde.com (e-tendering website). Please keep visiting our website for any corrigendum /amendments and submit the bid documents.
Last Date & Time of Submission of Tender (Bid due date)	Up to 3:00 P.M. on 02/11/2020 (Monday)
Contact Person (for any clarification)	Executive Engineer (Civil), e-mail: hkyadav@rgipt.ac.in , Mobile No.+91-9565993399
Pre-Bid Meeting	3:00 P.M. on 23/10/2020 (Friday)

Opening of E-Tender	Part – A – Technical Bid Technical Bid will be opened online on same day, i.e. 2 nd November 2020 at 04:00 P.M. in the presence of authorized representatives of the bidders.
	Part – B – Financial Bid Financial Bid will be open for technically qualified bidders and shall be intimated for later date for online Financial Bid opening.
ITI Helpdesk Contact Detail	Helpdesk landline No.- 011-49606060 Mobile Number - Mr. Birendra Kumar - 9205898228, Mr. Saurabh-07042643428

In case the days specified above happens to be a holiday at RGIPT, the next working day shall be implied.

E Tendering Helpdesk Number: 011-49606060/9205898228/7982696347/7042643428

E Tendering Helpdesk email ID: ewizardhelpdesk@gmail.com

ewizardhelpdesk89@gmail.com

Instructions for Online Bid Submission:

The bidders are required to submit soft copies of their bids electronically on the e-tender Portal, using valid class 3 Digital Signature Certificates. The instructions given below are meant to assist the bidders in registering on the e-tender Portal, prepare their bids in accordance with the requirements and submitting their bids online on the e-tender Portal.

More information useful for submitting online bids on the e-tender Portal may be obtained at: <https://rgipt.euniwizarde.com>.

REGISTRATION

1. Bidders are required to enroll on the e-Procurement Portal (URL: <https://rgipt.euniwizarde.com>) with clicking on the link “Online bidder Registration” on the e-tender Portal by paying the **Registration fee of Rs. 2360/- Per vendor/per year**.
2. As part of the enrolment process, the bidders will be required to choose a unique username and assign a password for their accounts.
3. Bidders are advised to register their valid email address and mobile numbers as part of the registration process. These would be used for any communication with the bidder.
4. Upon enrolment, the bidders will be required to register their valid Digital Signature Certificate (**Only Class III Certificates with signing + encryption key usage**) issued by any Certifying Authority recognized by CCA India (e.g. Sify / TCS / nCode / eMudhra etc.), with their profile.
5. Only one valid DSC should be registered by a bidder. Please note that the bidders are responsible to ensure that they do not lend their DSC’s to others which may lead to misuse.
6. Bidder then logs in to the site through the secured log-in by entering their user ID /password and the password of the DSC / e-Token.
7. **The scanned copies of all original documents should be uploaded on portal <https://rgipt.euniwizarde.com>**

SEARCHING FOR TENDER DOCUMENTS

1. There are various search options built in the e-tender Portal, to facilitate bidders to search active tenders by several parameters.
2. Once the bidders have selected the tenders they are interested in, you can pay the form fee and processing fee (NOT REFUNDABLE) by net-banking / Debit / Credit card then you may download the required documents / tender schedules, Bid documents etc. Once you pay both fee tenders will be moved to the respective ‘requested’ Tab. This would enable the e-tender Portal to intimate the bidders through SMS / e-mail in case there is any corrigendum issued to the tender document.

PREPARATION OF BIDS

1. Bidder should take into account any corrigendum published on the tender document before submitting their bids.
2. Please go through the tender advertisement and the tender document carefully to understand the documents required to be submitted as part of the bid.

3. Bidder, in advance, should get ready the bid documents to be submitted as indicated in the tender document / schedule and generally, they can be in PDF formats. Bid Original documents may be scanned with 100 dpi with Colored option which helps in reducing size of the scanned document.
4. To avoid the time and effort required in uploading the same set of standard documents which are required to be submitted as a part of every bid, a provision of uploading such standard documents (**e.g. PAN card copy, annual reports, auditor certificates etc.**) has been provided to the bidders. Bidders can use “My Documents” available to them to upload such documents.
5. These documents may be directly submitted from the “My Documents” area while submitting a bid, and need not be uploaded again and again. This will lead to a reduction in the time required for bid submission process.

SUBMISSION OF BIDS

1. Bidder should log into the website well in advance for the submission of the bid so that it gets uploaded well in time i.e. on or before the bid submission time. Bidder will be responsible for any delay due to other issues.
2. The bidder has to digitally sign and upload the required bid documents one by one as indicated in the tender document as a token of acceptance of the terms and conditions laid down by RGIPT, Jais.
3. Bidder has to select the payment option as **“e-payment” to pay the tender fee / EMD** as applicable and enter details of the instrument.
4. Bidders are requested to note that they should necessarily submit their price bid (financial bids) in the format provided and no other format is acceptable. If the price bid has been given as a standard BOQ format with the tender document, then the same is to be downloaded and to be filled by all the bidders. Bidders are required to download the BOQ file, open it and complete the white Colored (unprotected) cells with their respective financial quotes and other details (such as name of the bidder). No other cells should be changed. Once the details have been completed, the bidder should save it and submit it online, without changing the filename. If the BOQ file is found to be modified by the bidder, the bid will be rejected.
5. The server time (which is displayed on the bidders’ dashboard) will be considered as the standard time for referencing the deadlines for submission of the bids by the bidders, opening of bids etc. The bidders should follow this time during bid submission.
6. All the documents being submitted by the bidders would be encrypted using PKI encryption techniques to ensure the secrecy of the data. The data entered cannot be viewed by unauthorized persons until the time of bid opening. Data storage encryption of sensitive fields is done. Any bid document that is uploaded to the server is subjected to symmetric encryption using a system generated symmetric key. Further this key is subjected to asymmetric encryption using buyers/bid openers public keys. Overall, the uploaded tender documents become readable only after the tender opening by the authorized bid openers.
7. The uploaded tender documents become readable only after the tender opening by the authorized bid openers.
8. Upon the successful and timely submission of bid click “Complete” (i.e. after Clicking “Submit” in the portal), the portal will give a successful Tender submission acknowledgement & a bid summary will be

displayed with the unique id and date & time of submission of the bid with all other relevant details.

9. The tender summary has to be printed and kept as an acknowledgement of the submission of the tender. This acknowledgement may be used as an entry pass for any bid opening meetings.

ASSISTANCE TO BIDDERS

Any queries relating to the tender document and the terms and conditions contained therein should be addressed to the Tender Inviting Authority for a tender or the relevant contact person indicated in the tender. Any queries relating to the process of online bid submission or queries relating to e-tender Portal in general may be directed to the 24x7 Helpdesk Support. **The contact number for the helpdesk is “011-49606060, Birendra Kumar- 9205898228”**

INSTRUCTIONS TO BIDDERS

Online E- Tenders on Item Rate (Unit Rate) basis are hereby invited under 'Two Part Bid System' i.e. Technical Bid and Financial Bid for Interior Works tender, under the heading "Interior (Civil, Electrical, Ductable Split AC, and LAN Networking Works at 4th Floor of Computer Center & Library Building at RGIPT, Jais" from reputed, experienced and financially sound Contractors of Central Public Works Department (CPWD), New Delhi.

ELIGIBILITY CRITERIA:

- a) The bidder should be an enlisted Class III or above, valid CPWD contractor of building (Composite) category.
- b) The bidder must have executed single work of similar nature for a value of Rs.1.0 Crore in last 5 years.

Similar Nature of Works means, the contractor who has executed the work of internal partition wall, plaster, painting, tiling, granite, sanitary works, false ceiling, aluminium partition, LAN networking work, internal electrification work along with fixing of panels and installation of ductable split A.C. along with ducting work.

1) SUBMISSION OF TENDER:

Tenders should be submitted online in two Parts separately, i.e. "Technical bid" (Part-A) and "Price bid" (Part-B).

Tenders should be on the specified form (non-transferable) which may be obtained from website <https://rgipt.euniwizarde.com>

The total time for carrying out the work will be 150 days from date of issue of Letter of Award. The date of commencement shall be reckoned from the 10 day of issue of Letter of Award.

i) TECHNICAL BID (PART –A):

To qualify in the Technical Bid, the firm should submit the following documents-

- a) Contractor enlistment class III or above certificate with the CPWD under building (Composite) category.
- b) Completion Certificate in support of **single work of similar nature** for an amount of Rs.1.0 Crore during last 5 years.
- c) The bidder should be an Indian Registered Company under Companies Act 1956/ Proprietorship / Firm / Company of any of these. Copy of Certificate of Incorporation / Registration or any other relevant document, as applicable, should be submitted along with a copy of address proof Copy of constitution or legal status of the sole proprietorship / firm / company etc.
- d) Acceptance of Tender Conditions as per **Annexure – 2**.

- e) Average Annual Financial Turnover during the last 3 years, ending 31st March 2019, should be of Rs 50,00,000/-. The last 3 financial years means Financial Year 2016-17, 2017-18 and 2018-19.
- f) Copy of Income Tax Return Filed Acknowledgement for last 3 years ending 31st March 2019 i.e. for financial years 2016-17, 2017-18 and 2018-19.
- g) Copy of audited Annual Account of last 3 years, ending 31st March' 2019 i.e. for financial years 2016-17, 2017-18 and 2018-19.
- h) Earnest Money Deposit (EMD) for an amount of Rs.2,50,000/-.
- i) Copy of PAN Card.
- j) Copy of GSTIN registration certificate.
- k) Copy of Bank Account details.
- l) Proof of Registration of EPF, ESI.
- m) Affidavit regarding Blacklisting/Debar/Integrity- Bidder shall submit affidavit on notarised Non-Judicial stamp paper of Rs 100.00 regarding firm not being blacklisted or debarred by any Government Department in any State in the format as prescribed as **Annexure – 8**.
- n) Duly filled format of Technical Bid as per **Annexure “1”**:-
- o) Tenderer should upload the complete tender document duly signed and stamped.**

ii) PRICE BID (Part –B):

The financial bid shall be submitted online in the prescribed format only. In this bid, the bidder is required to quote his item rates in the BOQ attached in accordance with the scope of work, terms & conditions & technical specifications enclosed. The rates/price quoted by contractor should be all inclusive i.e. should include all material cost, labour, services, plant/machinery/tools & tackles, ladders & scaffolding required for work, freight, Insurance, Govt. duties & levies, all kind of statutory liabilities like GST etc., transport/cartage of materials/labour and all other expenses not specifically mentioned but reasonably implied. Nothing over and above these rates shall be payable to contractor. Further nothing extra in rates will be considered for any variations in tender quantities or due to any site difficulties. It is mandatory for bidder to quote all items rate as asked for in the BOQ/ PRICE schedule. Failure in not filling some item rates will lead to rejection of tender. **The tender job will be awarded on overall L1 basis, not on individual item basis.**

In case, any bidder encloses the price (financial) bid within technical bid, the same shall be rejected summarily.

2. Earnest Money Deposit

- i. Earnest Money Deposit (EMD) amounting to Rs.2,50,000/- (Rupees Two Lac Fifty Thousand Only) through e-payment Gateway available on <https://rgipt.euniwizarde.com> along with the tender. Tender received without EMD will be invalid and rejected. The EMD shall be valid for minimum period of 120 (One Hundred Twenty) days from the last day of submission of Tender.

- ii. The EMD shall be payable to RGIPT without any condition(s), recourse or reservations.
- iii. The bid will be rejected by RGIPT as non-responsive and shall not be considered in case EMD is not received.
- iv. The EMD of bidders other than L1 (Lowest Bidder) will be returned after finalization of tender.
- v. No interest shall be paid by RGIPT on the EMD.
- vi. The EMD may be forfeited:
 - a) if the bidder withdraws the bid after bid opening during the period of validity;
 - b) Any unilateral revision in the offer made by the tenderer during the validity of the offer.
 - c) Upon non-acceptance of LOA, if and when placed.
 - d) In the case of a successful bidder; if the bidder fails to Sign the Agreement within the 20 (Twenty) days from the date of issue of LOA (Letter of Award) or furnish the required performance guarantee within 10 days from date of issue of LOA or fails to commence the work within the stipulated time period prescribed in the contract.
 - e) If any bidder furnishes any incorrect or false statement/ information/document.
- vii. The EMD of the L1 bidder will be returned after the deposition of Performance guarantee.

3. Price bids of only those bidders will be opened, who qualify in the technical bids.

- 4. Canvassing in connection with the tenders is prohibited and the tenders submitted by the contractor who resort to canvassing are liable for rejection.

5. VALIDITY OF TENDER

The tender for the works shall remain open for acceptance for a period of 120 (One Hundred Twenty) days from the date of opening of technical tender. If any tenderer withdraws his tender before the said period or makes any modifications in the terms and conditions of the tender which are not acceptable to the RGIPT, then the RGIPT shall, without prejudice to any other right or remedy, be at liberty to forfeit the said earnest money as aforesaid. Further the tenderers shall not be allowed to participate in the retendering process of work.

6. ACCEPTANCE OF TENDER

RGIPT reserves the right to reject any or all the tenders in part or full without assigning any reason whatsoever. RGIPT does not bind itself to accept the lowest tender.

- 7. On acceptance of tender, the name of the accredited representative(s) of the contractor who would be responsible for taking instructions from Engineer-in-Charge or its authorized representative shall be intimated by the contractor within 07 days of issue date of letter of Awards by RGIPT.
- 8. The tender award, execution and completion of work shall be governed by tender documents consisting of (but not limited to) Letter of Award/Letter of Work Order, Scope of Work, Bill of Quantities, Special Conditions of Contract, General Conditions of Contract, Specifications, Drawings. The tenderers shall be deemed to have gone through the various conditions including sub-soil water conditions, topography of the land, drainage and accessibility etc. or any other condition which in the opinion of contractor will affect his price/rates before quoting their rates. No claim whatsoever against the foregoing shall be entertained.
- 9. The drawings with the tender documents are Tender Drawing and are indicative only.

10. ADDENDA/ CORRIGENDA

Addenda/Corrigenda to the tender documents may be issued prior to the date of submission of the tender to clarify or effect modification in specification and/or contract terms included in various tender documents. The tenderer shall suitably take into consideration such Addenda/Corrigenda while submitting his tender. The tenderer shall return such Addenda/ Corrigenda duly signed and stamped as confirmation of its receipt & acceptance and submit along with the tender document. All addenda/ Corrigenda shall be signed and stamped on each page by the tenderer and shall become part of the tender and contract documents.

11. SITE VISIT AND COLLECTING LOCAL INFORMATION

Before tendering, the tenderers are advised to visit the site, its surroundings to assess and satisfy themselves about the local conditions such as the working and other constraints at site, approach roads to the site, availability of water & power supply, application of taxes, duties and levies as applicable & any other relevant information required by them to execute complete scope of work. The tenderer may obtain all necessary information as to risks, weather conditions, contingencies & other circumstances (insurgencies etc.) which may influence or affect their tender prices. Tenderer shall be deemed to have considered site conditions whether he has inspected it or not and to have satisfied himself in all respect before quoting his rates and no claim or extra charges whatsoever in this regard shall be entertained / payable by the RGIPT at a later date.

12. HANDING OVER & CLEARING OF SITE

The efforts will be made by the RGIPT to handover the site to the Contractor free of encumbrances. However, in case of any delay in handing over of the site to the Contractor, the RGIPT shall only consider suitable extension of time for the execution of the work. It should be clearly understood that the RGIPT shall not consider any revision in contract price or any other compensation whatsoever viz. towards idleness of Contractor's labour, equipment etc.

13. CLARIFICATION AFTER TENDER SUBMISSION

Tenderer's attention is drawn to the fact that during the period, the tenders are under consideration, the tenderers are advised to refrain from contacting by any means, the RGIPT and/or his employees/ representatives on matters related to the tender under consideration and that if necessary, RGIPT will obtain clarifications in writing or as may be necessary. The tender evaluation and process of award of works is done by duly authorized Tender Scrutiny Committee and this committee is authorized to discuss and get clarification from the tenderers.

14. ORDER OF PRECEDENCE OF DOCUMENTS

In case of difference, contradiction, discrepancy, with regard to conditions of contract, Specifications, Drawings, Bill of quantities etc. forming part of the contract, the following shall prevail in order of precedence.

- i) Letter of Award, along with statement of agreed variations and its enclosures, if any.
- ii) Special Condition of Contract
- iii) Scope of Work
- iv) Description of Bill of Quantity / Schedule of Quantities.
- v) General Conditions of Contract.

- vi) Drawings
 - vii) CPWD specifications (as specified in specification of the Tender) update with correction slips issued up to last date of receipt of tenders.
 - viii) Relevant B.I.S. Codes
15. No Engineer of Gazetted Rank or other Gazetted Officer employed in Engineering or Administrative duties in an Engineering Department of the Government of India is allowed to work as a contractor for a period of one year after his retirement from Government service, without the prior permission of the Government of India in writing. This contract is liable to be cancelled if either the contractor or any of his employees is found any time to be such a person who had not obtained the permission of the Government of India as aforesaid before submission of the tender or engagement in the contractor's service.
 16. The pre-bid meeting will be held at Office of Dean of Students' Affairs (DoSA) on 23rd October 2020 at 03:00 PM. Corrigendum of the said pre-bid meeting, if any, will be uploaded on CPP Portal as well as on RGIPT's e-tender website. The bidders are therefore, requested to kindly check the portals before submission of their e-tender.
 17. To acquaint themselves with the work, all the bidders are requested to visit the site by contacting the IWD Office on any working day (Monday to Friday) between 11:00 Hrs. to 16:00 Hrs. from 12.10.2020 to 02.11.2020 at RGIPT Jais Campus, Amethi or call on +91-9565993399. Bidders are advised to take prior approval from the competent authority of RGIPT before visiting the RGIPT Jais Campus.

GENERAL CONDITIONS OF CONTRACT

1.0 DEFINITIONS:

The Contract means the documents forming the tender and acceptance thereof and the formal agreement executed between the competent authority on behalf of Rajiv Gandhi Institute of Petroleum Technology and the contractor together with the documents referred to therein including these conditions, the specifications, designs, drawings and instructions issued from time to time by the Engineer-In-Charge and all these documents taken together, shall be deemed to form one contract and shall be complementary to one another.

1.1 In the contract, the following expressions shall, unless the context otherwise requires, have the meanings, hereby respectively assigned to them: -

- a) **APPROVAL** means approved in writing including subsequent written confirmation of previous verbal approval.
- b) **BILL OF QUANTITIES or SCHEDULE OF QUANTITIES** means the priced and completed Bill of Quantities or Schedule of Quantities forming part of the tender.
- c) **INSTITUTE** shall mean Rajiv Gandhi Institute of Petroleum Technology (RGIPT), Jais, Amethi.
- d) **CONTRACTOR** Shall mean the individual or firm or company, whether incorporated or not undertaking the work and shall include the legal personal representative or such individual or the persons composing such firms or company or the Successor of such firm or company and the permitted assignees of such individual or firm(s) or Company.
- e) **CONTRACT VALUE** means the sum for which the tender is accepted as per the letter of Award.
- f) **DRAWINGS** mean the drawings referred to in the contract document including modifications if any and such other drawings as may from time to time be furnished and/ or approved by RGIPT.
- g) **DATE OF COMMENCEMENT OF WORK:** The date of start of contract shall be reckoned from 10 days after the date of issue of letter of Award.
- h) **ENGINEER IN CHARGE** means the Engineer of RGIPT who shall supervise and be in-charge of the work.
- i) **CPWD** means Central Public Works Department, New Delhi
- j) **LANGUAGE:** All documents and correspondence in respect of this contract shall be in English Language.
- k) **“LETTER OF AWARD”** shall mean RGIPT letter or notification conveying its acceptance of the tender subject to such conditions as may have been stated therein.

- l) **MONTH** means English Calendar month ‘Day’ means a Calendar day of 24 Hrs each.
- m) **SITE** Shall mean the site of contract works including any buildings and erection thereon and any other land adjoining thereto (inclusive) as aforesaid allotted by the Institute or the Engineer-in-Charge for the contractors use.
- n) **TENDER** means the price offered by Contractor’s for the execution and completion of the work and the remedying of any defects therein in accordance with the provisions of the Contract, as accepted by the Letter of Award or Award letter. The word TENDER is synonymous with Tender and the word TENDER DOCUMENTS with “Tendering Documents” or “offer documents”.
- o) **WRITING** means any manuscript typed written or printed statement under or over signature and/or seal as the case may be.
- p) **Works or Work** shall unless there be something either in the subject or context repugnant to such construction, be construed and taken to mean the works by or by virtue of the contract contracted to be executed whether temporary or permanent, and whether original, altered, substituted or additional.
- q) Headings in the clauses/ conditions of tender documents are for convenience only and shall not be used for interpretation of the clause/condition.
- r) Words imparting the singular meaning only also include the plurals and vice versa where the context requires. Words importing persons or parties shall include firms and corporations and organizations having legal capacities
- s) **Excepted Risk** are risks due to riots (other than those on account of contractor’s employees), war (whether declared or not) invasion, act of foreign enemies, hostilities, civil war, rebellion revolution, insurrection, military or usurped power, any acts of Government, damages from aircraft, acts of God, such as earthquake, lightening and unprecedented floods, and other causes over which the contractor has no control and accepted as such by the RGIPT or causes solely due to use or occupation by Government of the part of the works in respect of which a certificate of completion has been issued or a cause solely due to RGIPT’s faulty design of works.
- t) **Market Rate** shall be the rate as decided by the Engineer-in-Charge on the basis of the prevailing cost of materials and labour at the site where the work is to be executed plus the percentage mentioned elsewhere in the tender document to cover, all overhead and profits.

2.0 PERFORMANCE GUARANTEE:

- 2.1 “Within 10 (Ten) days from the date of issue of letter of Award, the contractor shall submit to RGIPT irrevocable performance bank guarantee in the form appended or Fixed Deposit Receipt (FDR) pledged in favour of “Rajiv Gandhi Institute of Petroleum Technology, Amethi”, from any Nationalized Bank, 5% (Five Percent) of the contract value for the due and proper execution of the Contract. In case FDR of any bank is furnished by the contractor to RGIPT as Performance Guarantee(s) and the bank is unable to make payment against the said FDR, the loss caused thereby shall fall on the contractor and the contractor shall forthwith on demand furnish additional security to RGIPT to make good the deficit. All the Performance Guarantees shall be initially valid up to the stipulated date of completion plus 60 days beyond that, including Defect Liability Period (DLP). In case the time for completion of works gets

extended, the contractor shall get the validity of Performance Guarantee extended to cover such extended time for completion of work and it shall be returned/refund to the contractor without interest.

- 2.2 In case the contractor fails to submit the performance guarantee(s) of the requisite amount within the stipulated period or extended period, letter of Award automatically will stand withdrawn and EMD of the contractor shall be forfeited.
- 2.3 In case part scope of work has been satisfactorily completed and handed over to RGIPT by the contractor and the remaining work/buildings are under hold/suspended for more than 3 months due to some hindrance beyond control of contractor or due to non-availability of site/clearance from RGIPT, the un-forfeited performance bank guarantee(s)/FDR(s) submitted by the contractor and available with RGIPT as on date, on specific request of the contractor, may be released and returned back to the contractor in lieu of submission and due verification of a fresh PBG/FDR of the equivalent amount towards balance work.

3.0 SECURITY DEPOSIT/ RETENTION MONEY

- 3.1 The Security deposit or the retention money shall be deducted from each running/ final bill of the contractor @ 5.0% (Five Percent Only) of the gross value of the Running Account/ final bill.
- 3.2 The release/refund of security deposit of the contractor shall be made with the payment of final bill.
- 3.3 RGIPT reserves the right of part or full forfeiture of security deposit in addition to other claims in the event of contractor's failure to fulfill any of the contractual obligations or in the event of termination of contract as per terms and conditions of contract.

4.0 MOBILIZATION ADVANCE

RGIPT will not pay any mobilization advance for the work.

5.0 SECURED ADVANCE AGAINST PERISHABLE AND NON-PERISHABLE MATERIALS

RGIPT will not pay any secured advance against perishable and non-perishable materials.

6.0 ESCALATION

No claim on account of any escalation on whatsoever ground shall be entertained at any stage of works. All rates as per Bill of Quantities (BOQ) quoted by contractor shall be firm and fixed for entire contract period as well as extended period for completion of the works. No escalation shall be applicable on this contract.

7.0 COMPENSATION FOR DELAY

The contractor shall pay liquidated damages an amount equal to 0.5% of the contract value, for every week, that the work remains un-commenced or unfinished or due quantity of work remains incomplete after the schedule date of completion of the work. Liquidated damages to be paid shall not exceed 10% of the contract value.

8.0 ACTION IN CASE WORK NOT DONE AS PER SPECIFICATIONS

All works under or in course of execution or executed in pursuance of the contract, shall at all times be open and accessible to the inspection and supervision of the Engineer-in-Charge, his authorized subordinates in charge of the work and all the superior officers, and the contractor shall, at all times, during the usual working hours and at all other times at which reasonable notice of the visit of such officers has been given to the contractor, either himself be present to receive orders and instructions or have a responsible agent duly accredited in writing, present for that purpose. Orders given to the Contractor's agent shall be considered to have the same force as if they had been given to the contractor himself.

If it shall appear to the Engineer-in-Charge or his authorized subordinates in-charge of the work that any work has been executed with unsound, imperfect, or unskillful workmanship, or with materials or articles provided by him for the execution of the work which are unsound or of a quality inferior to that contracted or otherwise not in accordance with the contract, the contractor shall, on demand in writing which shall be made within 12 (Twelve) months of the completion of the work from the Engineer-in-Charge specifying the work, materials or articles complained of notwithstanding that the same may have been passed, certified and paid for forthwith rectify, or remove and reconstruct the work so specified in whole or in part, as the case may require or as the case may be, remove the materials or articles so specified and provide other proper and suitable materials or articles at his own charge and cost. In the event of the failing to do so within a period specified by the Engineer-in-Charge in his demand aforesaid, then the contractor shall be liable to pay compensation at the same rate as under Clause No. 28.0 of G.C.C. for this default. Decision of the Engineer-in-Charge to be conveyed in writing in respect of the same will be final and binding on the contractor.

9.0 ACTION IN CASE OF BAD WORK

If it shall appear to the Engineer-in-Charge or his authorized representative in charge of the work where the work is being executed, that any work has been executed with unsound, imperfect, or unskillful workmanship or with materials of any inferior description, or that any materials or articles provided by him for the execution of the work are unsound or of a quality inferior to that contracted for or otherwise not in accordance with the contract, the contractor shall on demand in writing which shall be made within 12 (Twelve) months of the completion of the work from the Engineer-in-Charge specifying the work, materials or articles complained of notwithstanding that the same may have been passed, Certified and paid for forthwith rectify, or remove and reconstruct the work so specified in whole or in part as the case may require or as the case may be, remove the materials or articles so specified and provide other proper and suitable materials or articles at his own proper charge and cost, and in the event of his failing to do so within a period to be specified by the Engineer-in-Charge in his demand aforesaid while the contractor failure to do so shall continue, the Engineer-in-Charge may rectify or remove and re-execute the work or remove and replace with others, the material or articles complained of as the case may be at the risk and expense in all respects of the contractor.

10.0 CANCELLATION/DETERMINATION OF CONTRACT IN FULL OR PART

Subject to other provisions contained in this clause the Engineer-in-Charge may, without prejudice to his any other rights or remedy against the contractor in respect of any delay, inferior workmanship, any claims for damages and / or any other provisions of this contract or otherwise, and whether the date of completion has or has not elapsed, by notice in writing absolutely determine the contract in any of the following cases:

- i) If the contractor having been given by the Engineer-in-Charge a notice in writing to rectify, reconstruct or replace any defective work or that the work is being performed in an inefficient or otherwise improper or un-workmanlike manner shall omit to comply with the requirement of such notice for a period of seven days thereafter; or
- ii) If the contractor has, without reasonable cause, suspended the progress of the work or has failed to proceed with the work with due diligence so that in the opinion of the Engineer-in-Charge (which shall be final and binding) he will be unable to secure completion of the work by the date for completion and continues to do so after a notice in writing of seven days from the Engineer-in-Charge; or

- iii) If the contractor fails to complete the work within the stipulated date or items of work with individual date of completion, if any stipulated, on or before such date(s) of completion and does not complete them within the period specified in a notice given in writing in that behalf by the Engineer-in-Charge; or
- iv) If the contractor persistently neglects to carry out his obligations under the contract and / or commits default in complying with any of the terms and conditions of the contract and does not remedy it or take effective steps to remedy it within 7 days after a notice in writing is given to him in that behalf by the Engineer-in-Charge; or
- v) If the contractor shall offer or give or agree to give to any person in RGIPT service or to any other person on his behalf any gift or consideration of any kind as an inducement or reward for doing or forbearing to do or for having done or forborne to do any action relation to the obtaining or execution of this or any other contract for RGIPT; or
- vi) If the contractor shall obtain a contract with RGIPT as a result of wrong tendering or other non-bona-fide methods of competitive tendering or commits breach of Integrity Pact; or
- vii) If the contractor assigns, transfers, sublets (engagement of labour on a piece-work basis or of the labour with materials not to be incorporated in the work, shall not be deemed to be subletting) or otherwise parts with or attempts to assign, transfer sublet or otherwise parts with the entire works or any partition thereof without and prior written approval of the Engineer-in-Charge.

Under such condition, when the contractor has made himself liable for action, the Engineer in Charge shall have the power

- a) To determine or rescind the contract as aforesaid in full or part and get the same executed at the risk and cost of the contractor. Under such condition, Performance Guarantee shall be liable to be forfeited and unused material shall be taken over and shall be absolutely at the disposal of the RGIPT Or
- b) After giving notice to the contractor to measure the work of the contractor and to take such whole or the balance or part thereof as shall be un executed or delayed and to give it to another contractor to complete.

11.0 TIME OF CONTRACT & EXTENSION FOR DELAY

11.1 The time allowed for execution of the Works as specified in the Notice Inviting Tender or the extended time in accordance with these conditions shall be the spirit of the contract. The execution of the works shall commence from such time period as mentioned in Notice Inviting Tender or the date on which the Engineer-in-Charge issues written orders to commence the work. If the Contractor commits default in commencing the execution of the work as aforesaid, the RGIPT shall without prejudice to any other right or remedy available in law, be at liberty to forfeit the earnest money & performance guarantee absolutely.

11.2 Within 10 (Ten) days of Letter of Award, the Contractor shall submit a Time and Progress Chart (CPM/ PERT/ Quantified Bar Chart) and get it approved by the Engineer in-Charge. The Chart shall be prepared in direct relation to the time stated in the contract documents for completion of items of the works. It shall indicate the forecast (mile-stones) of the dates of commencement and completion of

various items, trades, sections of the work and may be amended as necessary by agreement between the Engineer-in-Charge and the Contractor within the limitations of time stipulated in the Contract documents and further to ensure good progress during the execution of the work.

11.3 If the work(s) be delayed by:

- i) force-majeure or
- ii) Abnormally bad weather, or
- iii) Serious loss or damage by fire, or
- iv) Civil commotion, local commotion of workmen, strike or lockout, affecting any or the trades employed on the work, or
- v) Delay on the part of other contractors or tradesmen engaged by Engineer-in-Charge in executing work not forming part of the
- v) Any other cause which, in the absolute discretion of the RGIPT, is beyond the Contractor's control, then upon the happening of any such event causing delay, the Contractor shall immediately give notice thereof in writing to the Engineer-in-Charge within 07 days but shall nevertheless use constantly his best endeavor to prevent or make good the delay and shall do all that may be reasonably required to the satisfaction of the Engineer-in-Charge to proceed with the works.

11.4 Request for extension of time, to be eligible for consideration, shall be made by the Contractor in writing within fourteen days of the happening of the event causing delay in the prescribed form. The Contractor may also, if practicable, indicate in such a request the period for which extension is desired. In any such case, Engineer-In-Charge will take decision on the merit of the case. However, it is not necessary that on each case request for extension of time by the contractor will be entertained by RGIPT. All extension of time shall be communicated to the Contractor by the Engineer-in-Charge in writing within a reasonable time from the receipt of such request. Non application by the contractor for extension of time shall not be a bar for giving a fair and reasonable extension by the Engineer-in-Charge and the extension of time so given by the Engineer-in-Charge shall be binding on the contractor.

12.0 TIME SCHEDULE & PROGRESS

12.1 Time allowed for carrying out all the works as entered in the tender shall be as mentioned in the Notice Inviting Tender, which shall be reckoned from the 10th day from the date on which the letter of Award is issued to the Contractor. Time shall be the essence of the contract and the Contractor shall ensure the completion of the entire work within the stipulated time of completion.

12.2 The contractor shall also furnish within 10 days of date of issue of letter of Award a CPM network/ PERT chart/ Bar Chart for completion of work within stipulated time. This will be duly got approved from RGIPT. This approved Network/ PERT/Bar Chart shall form a part of the agreement. Achievement of milestones as well as total completion has to be within the time period allowed.

12.3 Contractor shall mobilize and employ sufficient resources for completion of all the works as indicated in the agreed BAR CHART/PERT Network. No additional payment will be made to the contractor for any multiple shift work or other incentive methods contemplated by him in his work schedule even though the time schedule is approved by the Engineer-in-Charge.

12.4 During the currency of the work the contractor is expected to adhere to the time schedule on mile stone and total completion and this adherence will be a part of Contractor's performance under the contract. During the execution of the work contractor is expected to participate in the review and updating of the

Network/BAR CHART undertaken by the RGIPT. These reviews may be undertaken at the discretion of Engineer-in-Charge either as a periodical appraisal measure or when the quantum of work order on the contractor is substantially changed through deviation orders or amendments. The review shall be held at RGIPT, Jais. The contractor will adhere to the revised schedule thereafter. The approval to the revised schedule resulting in a completion date beyond the stipulated date of completion shall not automatically amount to a grant of extension of time to the contractor.

13.0 TAXES AND DUTIES

- 13.1 The contract price is inclusive of all taxes, duties, cess and statutory levies payable under any law (as applicable on the date of submission of bid) by the contractor in connection with execution of the contract.

The contract price will be adjusted prospectively for any increase / decrease in the GST rate on works contract notified by Government of India.

In case, if any new taxes is imposed by Central Government / State Government, which will have the impact on this tender, will be dealt accordingly on the submission of valid proof of the challan / receipts.

- 13.2 Notwithstanding anything contained in clause payment of appropriate tax on the supplies made under the contract. The contractor shall take registration under the applicable enactment levying tax on supply of goods or services under the contract and issue invoice having all the particulars prescribed under the applicable provisions of the law, including, description of goods/services, rate and amount of tax paid or payable on the supplies made under the contract, so that RGIPT can avail credit of such tax, wherever applicable. The contractor shall comply with all applicable provision of Goods and Service Tax (GST) levied by Union Government and State Governments (CGST, UTGST, SGST and IGST). The contractor shall get himself registered and discharge his obligations for payment of taxes, filing of returns etc. under the appropriate provisions of law in respect of all the duties, levies, cess, etc. RGIPT would have right to seek necessary evidence that the contractor is registered under the law and duly discharging its obligations under the tax law, enabling RGIPT to avail input tax credit.

Whenever interest is payable on reversal of Input Tax Credit (ITC) for non-fulfillment of payment of value and tax of supply under GST Act, due to any default on contractor's part (i.e due to poor performance/quality or non-fulfillment of terms of contract), the amount of interest so levied on RGIPT shall be recovered from the contractor.

- 13.3 In case the contractor does not deposit the tax payable on execution of the contract, or has not provided the tax invoice to RGIPT showing the amount of tax, or has not uploaded the document in computerized tax network as per prevailing law, leading to non-availability of inputs credit of the tax to RGIPT, the amount equivalent to such tax shall be deducted from the contract price.
- 13.4 Stamp duty and registration charges, if any, payable on the executed contract document, shall be borne by the contractor.
- 13.5 Tax deduction at source, if any, shall be made by RGIPT as per law applicable from time to time from the amount payable to the contractor.

14.0 INCOME TAX DEDUCTION (TDS)

Income tax deductions shall be made from all payments made to the contractor including advances, in respect of the work/ project undertaken by the contractor, in accordance with the provisions of the Income Tax Act and Rules made thereunder prevailing and in force from time to time.

15.0 ROYALTY ON MATERIALS:

- 15.1 The contractor shall deposit royalty and obtain necessary permit for supply of bajri, stone, kankar, sand and other materials etc. from the local authorities and quoted rates shall be inclusive of royalty.
- 15.2 The contractor shall be deemed to have inspected the site, its surrounding and acquainted itself with the nature of the ground, accessibility of the site and full extent and nature of all operations necessary for the full and proper execution of the contract, space for storage of materials, constructional plant, temporary works, restrictions on the plying of heavy vehicles in area, supply and use of labour, materials, plant, equipment and laws, rules and regulations, if any, imposed by the local authorities.
- 15.3 The rates and prices to be tendered in the bill of quantities are for completed and finished items of works and complete in all respects. It will be deemed to include all constructional plant, labour, supervision, materials, transport, all temporary works, erection, maintenance, contractor's profit and establishment/overheads, together with preparation of designs & drawings pertaining to casting yard, shop drawing, fabrication drawing (if required), staging form work, stacking yard, etc. all general risk, all taxes, royalty, duties, cess, octroi and other levies, insurance liabilities and obligations set out or implied in the tender documents and contract.
- 15.4 If any temporary/ permanent structure is encountered or safety of such structure in the vicinity is endangered due to execution of the project, the contractor has to protect the structures by any means as per direction of Engineer-in-Charge. If any damage is caused to any temporary or permanent structure(s) in the vicinity due to execution of the project, the contractor has to make good the same by any means as per direction of Engineer-in-Charge. The contractor should inspect the site of work from this point of view. The cost to be incurred in this regard shall be deemed to be included in his quoted rates of BOQ items and the contractor shall not be entitled for any extra payment in this regard.

16.0 PAYMENTS

- 16.1 All running payments shall be regarded as payments by way of advance against the final payment only and not as payments for work actually done and completed and/or accepted by RGIPT and shall not preclude the recovery for bad, unsound and imperfect or unskilled work to be removed and taken away and reconstructed or re-erected or be considered as an admission of the due performance of the Contract, or any part thereof, in this respect, or the accruing of any claim, nor shall it conclude, determine or affect in any way the powers of the RGIPT under these conditions or any of them as to the final settlement and adjustments of the accounts or otherwise, or in any other way vary/ affect the contract. The final bill shall be submitted by the contractor within three months of the completion of work, otherwise RGIPT's certificate of the measurement and of the total amount payable for the work accordingly shall be final and binding on contractor. Each Running Bills should be accompanied by Monthly Progress Report and tax invoices as per applicable tax laws. No payment of running account bill shall be released unless it is accompanied by Monthly Progress Report and tax invoices as above.
- 16.2 It is clearly agreed and understood by the Contractor that notwithstanding anything to the contrary that may be stated in the agreement between RGIPT and the contractor; the contractor shall not slow down or stop the progress of work, if any, delay in the release of corresponding payment of Running Account

Bill by RGIPT. The contractor shall not entitle to any compensation/ interest from RGIPT for such kind of delay.

16.3 All payments shall be released by way of e-transfer through RTGS in India directly at their Bank account by RGIPT. The payment of final bill shall be made to the contractor after obtaining the work completion certificate from RGIPT.

16.4 No Running Account Bill shall be paid for the work till the applicable labour licenses is submitted by the contractor to the Engineer-in-Charge.

17.0 MEASUREMENTS OF WORKS

Engineer-in-charge shall, except as otherwise provided, ascertain and determine by measurement, the value of work done in accordance with the contract.

Except where any general or detailed description of the work expressly shows to the contrary, measurement shall be taken in accordance with the procedure set forth in the CPWD Specification. In the case of items which are not covered by specifications, mode of measurement as specified in the Technical Specifications of the contract and if for any item no such technical specification is available, then a relevant standard method of measurement issued by the Bureau of Indian Standard shall be followed.

Provided further that, In case of Cancellation/Determination of Contract in Full or in Part, following methodology shall be adopted in respect of measurements in addition to what has been mentioned in foregoing: -

- All measurements and levels shall be taken jointly by the Engineer-in-Charge or his authorized representative and by the contractor or his authorized representative from time to time during the progress of the work and such measurements shall be signed and dated by the Engineer-in Charge and the contractor or their representatives in token of their acceptance. If the contractor objects to any of the measurements recorded, a note shall be made to that effect with reason and signed by both the parties.
- If for any reason the contractor or his authorized representative is not available and the work of recording measurements is suspended by the Engineer-in-Charge or his representative, the Engineer-in-Charge and RGIPT shall not entertain any claim from contractor for any loss or damages on this account. If the contractor or his authorized representative does not remain present at the time of such measurements after the contractor or his authorized representative has been given a notice in writing three (3) days in advance or fails to countersign or to record objection within a week from the date of the measurement, then such measurements recorded in his absence by the Engineer-in-Charge or his representative shall be deemed to be accepted by the Contractor. The contractor shall, without extra charge, provide all assistance with every appliance, labour and other things necessary for measurements and recording levels.

18.0 COMPUTERISED MEASUREMENT BOOKS

Engineer-in-Charge shall, except as otherwise provided, ascertain and determine by measurement the value of work done in accordance with the contract. All measurements of all items having financial value shall be entered by the contractor and compiled in shape of the Computerized Measurement Book as per the format of RGIPT so that a complete record is obtained of all the items of works performed under the contract. All such measurements and levels recorded by the contractor or his authorized representative from time to time, during the progress of the work, shall be got checked by

the contractor from the Engineer-in-Charge or his authorized representative as per interval or program fixed in consultation with Engineer-in-Charge or his authorized representative.

After the necessary corrections made by the Engineer-in-Charge, the measurement sheets shall be returned to the contractor for incorporating the corrections and for resubmission to the Engineer-in-Charge for the dated signatures by the Engineer-in-Charge and the contractor or their representatives in token of their acceptance.

Whenever bill is due for payment, the contractor would initially submit draft computerized measurement sheets and these measurements would be got checked/test checked from the Engineer-in-Charge and /or his authorized representative. The contractor will, thereafter, incorporate such changes as may be done during these checks/test checks in his draft computerized measurements, and submit it to RGIPT. All the required documents e.g. measurement sheet, ESIC/EPF challans, Tax invoice. No payment of RA bills shall be released until all obligations and documents as above as per direction of Engineer In-charge are submitted to RGIPT.

It is also a term of this contract that checking and/or test checking the measurements of any item of work in the measurement book and/or its payment in the interim, on account of final bill shall not be considered as conclusive evidence as to the sufficiency of any work or material to which it relates nor shall it relieve the contractor from liabilities from any over measurement or defects noticed till completion of the defects liability period.

19.0 WORK TO BE EXECUTED IN ACCORDANCE WITH SPECIFICATIONS, DRAWINGS, AND ORDERS ETC.

All items of work in the bill of quantities/ schedule of quantities shall be carried out as per the CPWD (as the case may be) specification, drawings and instructions of the Engineer-in-Charge of RGIPT and the rates shall include for supply of required materials including proper storage, consumables, skilled & unskilled labour, supervision and tools, tackles, plant and machinery complete as called for in the detailed specifications and conditions of the contract. Latest updated CPWD specification shall be followed for execution of work.

The contractor shall execute the whole and every part of the work in the most substantial and workman like manner both as regards materials and otherwise in every respect in strict accordance with the specifications. The contractor shall also conform exactly, fully and faithfully to the design, drawings and instructions in writing in respect of the work assigned by the Engineer-in-Charge.

The contractor shall comply with the provisions of the contract and execute the works with care and diligence and maintain the works and provide all labour and materials, tools and plants including the measurements and supervision of all works, structural plans and other things of temporary or permanent nature required for such execution and maintenance in so far as the necessity for providing these, is specified or is reasonably inferred from the contract. The contractor shall take full responsibility for adequacy, suitability and safety of all the works and methods of construction.

20.0 MATERIALS TO BE PROVIDED BY THE CONTRACTOR

The contractor shall, at his own expense, provide all materials, required including Cement & Steel for the works. **The contractor shall at his own expense and without delay; supply to the Engineer-in-Charge samples of materials to be used on the work and shall get the same approved in advance.** All such materials to be provided by the Contractor shall be in conformity with the specifications laid down or referred to in the contract. The contractor shall, if requested by the Engineer-in-Charge furnish

proof, to the satisfaction of the Engineer-in-Charge regarding compliance of the material so procured. The Engineer-in-Charge or his authorized representative shall at all times have access to the works and to all workshops and places where work is being prepared or from where materials, manufactured articles or machinery are being obtained for the works and the contractor shall afford every facility and every assistance and cost in obtaining the right and visit to such access. The Engineer-in-Charge shall have full powers to require the removal from the premises of all materials which in his opinion are not in accordance with the specifications and in case of default, the Engineer-in-Charge shall be at liberty to employ at the expense of the contractor, other persons to remove the same without being answerable or accountable for any loss or damage that may happen or arise to such materials. The Engineer-in-Charge shall also have full power to require other proper materials to be substituted thereof and in case of default, the Engineer-in-Charge may cause the same to be supplied and all costs which may require such removal and substitution shall be borne by the contractor.

The contractor shall ensure that the materials are brought to site in original sealed containers or packing bearing manufacturer's making and brands (except where the quantity required is a fraction of the smallest packing). Materials not complying with this requirement shall be rejected. The empty containers of such materials shall not be destroyed/disposed-off without the permission of RGIPT.

The contractor shall produce receipted vouchers showing quantities of the materials to satisfy Engineer-in-Charge that the materials comply with the specifications. These vouchers shall be endorsed, dated and signed by the contractor. A certified copy of each such vouchers signed both by RGIPT and the Contractor shall be kept on record.

21.0 MATERIALS AND SAMPLES

- 21.1 The materials/products used on the works shall be one of the approved make/ brands out of list of manufacturers / brands /makes given in the tender documents. The contractor shall submit samples/ specimens out of approved makes of materials/ products to the Engineer-in-Charge for prior approval. In exceptional circumstances Engineer-in-Charge may allow alternate equivalent make/brands of products/ materials at his sole discretion. The final choice of brand / make shall remain with the Engineer in-Charge, whose decision in this matter shall be final and binding and nothing extra on this account shall be payable to the Contractor. In case single brand/ make are mentioned, other equivalent makes/brands may be considered by the Engineer-in-Charge depending upon the circumstances. In case of variance in CPWD/IS/BIS Specifications from approved products/makes specification, the specification of approved product/make shall prevail for which nothing shall be paid extra to the Contractor. In case no make or brand of any materials, articles, fittings and accessories etc. is specified, the same shall comply with the relevant Indian Standard Specifications and shall bear ISI/BIS mark. The Engineer-in-Charge of RGIPT shall have the discretion to check quality of materials and equipment's to be incorporated in the work, at source of supply or site of work and even after incorporation in the work. They shall also have the discretion to check the workmanship of various items of work to be executed in this work. The contractor shall provide the necessary facilities and assistance for this purpose.
- 21.2 The above provisions shall not absolve the contractor from the quality of final product and in getting the material and workmanship quality checked and approved from the Engineer-in-Charge of RGIPT.
- 21.3 The contractor shall well in advance, produce samples of all materials, articles, fittings, accessories etc. that he proposes to use and get them approved in writing by RGIPT. The materials, articles etc. as approved shall be labelled as such and shall be signed by RGIPT and the Contractor's representative.

- 21.4 The approved samples shall be kept in the custody of the Engineer-in-Charge of RGIPT till completion of the work. Thereafter the samples except those destroyed during testing shall be returned to the contractor. No payment will be made to the contractor for the samples or samples destroyed in testing.
- 21.5 The brands of all materials, articles fittings etc. approved together with the names of the manufacturers and firms from which supplies have been arranged shall be recorded in the site order book.

22.0 CONTRACTOR TO SUPPLY TOOLS & PLANTS

The contractor shall provide at his own cost all materials, machinery, tools & plants as require for completion of work. In addition to this, appliances, implements, other plants, ladders, cordage, tackle, scaffolding and temporary works required for the proper execution of the work, whether original, altered or substituted and whether included in the specifications or other documents forming part of the contract or referred to in these conditions or not, or which may be necessary for the purpose of satisfying or complying with the requirements of the Engineer-in-Charge as to any matter as to which under these conditions he is entitled to be satisfied, or which he is entitled to require together with carriage therefore to and from the work. The contractor shall also supply without charge the requisite number of persons with the means and materials, necessary for the purpose of setting out works, and counting, weighing and assisting the measurement or examination at any time and from time to time of the work or materials. Failing his so doing, the same may be provided by the Engineer-in-Charge at the expense of the contractor and the expenses may be deducted, from any money due to the contractor, under this contract or otherwise and/or from his security deposit or the proceeds of sale thereof, or of a sufficient portions thereof.

23.0 MOBILIZATION OF MEN, MATERIALS AND MACHINERY:

- 23.1 All expenses towards mobilization at site and de-mobilization including bringing in equipment, work force, materials, dismantling the equipment's, clearing the site etc. shall be deemed to be included in prices quoted and no separate payment on account of such expenses shall be entertained.
- 23.2 It shall be entirely the Contractor's responsibility to provide, operate and maintain all necessary construction equipments, scaffoldings and safety, gadget, lifting tackles, tools and appliances to perform the work in a workman like and efficient manner and complete all jobs as per the specifications and within the schedule time of completion of work. RGIPT will provide free water during execution of work at one point. However, single point source metered supply for the electricity will be provided on chargeable basis @ Rs.8.06 per unit. The contractor has to make his own arrangements for supplying power and water from that point onwards as per his requirements.
- 23.3 All materials, construction plants and equipments etc. once brought by the contractor within the project area, will not be allowed to be removed from the premises without the written permission of the Engineer-in-Charge. Similarly, all enabling works built by the contractor for the main construction undertaken by him, shall not be dismantled and removed without the written authority of the RGIPT.
- 23.4 All contractors' plant, machinery and equipment shall be kept in perfect condition during currency of the contract.

24.0 CONTRACTOR COORDINATION MEETINGS AND PROGRESS REPORTING

The Contractor shall have to attend all the meetings at RGIPT, Jais campus at his own cost with RGIPT officials, during the tenure of the Contract, as and when required. During the execution of work, Contractor shall submit at his own cost a detailed Monthly Progress & Programme Report to the Engineer-in-charge of RGIPT by 5th of every month. The format of Monthly Progress & Programme report shall be as approved by Engineer-In-Charge of RGIPT.

25.0 COMPLETION CERTIFICATE

The Contractor shall be responsible for handing over of project including signing of inventories by the client and shall obtain final work completion from RGIPT. Necessary support for the same, shall however, be provided by RGIPT. No payment of final bill shall be released to the contractor until final work completion certificate is obtained from RGIPT.

26.0 PROHIBITION OF UNAUTHORISED CONSTRUCTION & OCCUPATION

No unauthorized buildings, construction of structures should be put up by the contractor anywhere on the project site, neither any building built by him shall be occupied in un-authorized manner by him or his staff.

27.0 FORCLOSURE OF CONTRACT BY RGIPT

If at any time after the commencement of the work the RGIPT shall for any reason whatsoever is required to abandon the work or is not require the whole work thereof as specified in the tender to be carried out, the Engineer-in-Charge shall give notice in writing of the fact to the contractor, who shall have no claim to any payment of compensation whatsoever on account of any profit OR advantage which he might have derived from the execution of the work in full, but which he did not derive in consequence of the foreclosure of the whole or part of the works.

28.0 DEFECTS LIABILITY PERIOD

The contractor shall be responsible for the rectification of defects in the works for a period twelve (12) months from the date of taking over of the works by the RGIPT. Any defects discovered and brought to the notice of the contractor forthwith shall be attended to and rectified by him at his own cost and expense. In case the contractor fails to carry out these rectifications, the same may without prejudice to any other right or remedy available, be got rectified by RGIPT at the cost and expense of the contractor.

29.0 SUBLETTING / SUB-CONTRACTING

The subletting/ sub-contracting shall not be allowed in any condition.

30.0 FORCE MAJEURE

Conditions beyond control of either parties like war, hostility, acts of public enemy, civil commotion, sabotage, serious loss or damage by fire, explosions, epidemics, strikes, lockouts or acts of God come under the legal concept of Force Majeure (FM). Delays in performance of contractual obligations under influence of FM conditions are condonable by the other party without any right to termination or damages, provided, notice of the happening of any such event is given by the affected party to the other within 30 (thirty) days from the date of occurrence. Works under the contract shall be resumed as soon as practicable after such event has come to an end or ceased to exist. However, if such event continues for a period exceeding 120 days, either party may at its option terminate the contract by giving notice to the other party.

31.0 NO COMPENSATION CLAUSE

The contractor shall have no claim whatsoever for compensation or idle charges against RGIPT on any ground or for any reason, whatsoever.

32.0 DIRECTION FOR WORKS

32.1 All works under the contract shall be executed under the direction and to approval in all respect of the Engineer-in-Charge of RGIPT who shall be entitled to direct at whatever point or points and in whatever manner works are to be commenced and executed.

32.2 The Engineer-in-Charge and his representative shall communicate or confirm their instructions to the contractor in respect of the execution of work during their site inspection in a 'Works Site Order Book' maintained at the site office of Engineer-in-Charge. The contractor or his authorized representative shall confirm receipt of such instructions by signing against the relevant orders in the book.

33.0 WORK IN MONSOON AND RAIN

The execution of the work may entail working in the monsoon also. The contractor must maintain labour force as may be required for the job and plan and execute the construction and erection according to the prescribed schedule. No special/ extra rate will be considered for such work in monsoon. The contractors' rate shall be considered inclusive of cost of dewatering due to rains required if any and no extra rate shall be payable on this account. The stipulated period for completion of project includes the monsoon period, holidays & festivals.

34.0 WORK ON SUNDAYS, HOLIDAYS AND DURING NIGHT

For carrying out work on Sunday and Holidays or during night, the contractor will approach the Engineer-in-Charge or his representative at least two days in advance on his discretion he can refuse such permission. The contractor shall have no claim on this account whatsoever. If work demand, the contractor shall make arrangements to carry out the work on Sundays, Holidays and in two, three shifts with the approval of Engineer-in-Charge at no extra cost to RGIPT.

35.0 WATER AND ELECTRICITY

RGIPT will provide free water during execution of work at one point. However, single point source metered supply for the electricity will be provided on chargeable basis @ Rs.8.06 per unit The contractor has to make his own arrangements for supplying power and water from that point onwards as per his requirements.

36.0 WATCH, WARD AND LIGHTING OF WORK PLACE

The contractor shall at his own cost take all precautions to ensure safety of life and property by providing necessary barriers, OBSTRUCTIONS, lights, supervisor etc. during the progress of work as directed by Engineer.

37.0 CEMENT

Cement shall be procured by Contractor confirming to BIS: 8112 and / or BIS: 1489 Specification latest edition or higher Grade as per approved list attached. The cement shall be procured directly from the reputed manufacturers/ stockiest as per approved list of RGIPT. Relevant vouchers and test certificate will be produced as and when required. Cement bags shall be used on first in first out basis. Cement stored for beyond 90 days will be required to be tested at contractors cost, before use in works.

38.0 STEEL

Steel confirming to BIS specifications (latest edition) shall be procured by the contractor directly from reputed manufacturers/producers as per approved list of RGIPT. Relevant vouchers & test certificates will be produced by the contractor.

39.0 SCHEDULE OF QUANTITIES / BILL OF QUANTITIES

The quantities shown against the various items of work are only approximate quantities which may vary as per the actual requirement at site. No item which is not covered in the bill of quantities shall be executed by the Contractor without the approval of the RGIPT. In case any Extra/Substituted item is carried out without specific approval, the same will not be paid.

40.0 INDIAN STANDARDS

Wherever any reference is made to any IS in any particular specifications, drawings or bill of quantities, it means the Indian Standards editions with up to date amendments issued till last date of receipt of tender documents.

41.0 WORKS TO BE OPEN TO INSPECTION

All works executed or under the course of execution in pursuance of this contract shall at all times be open to inspection and supervision of the RGIPT.

42.0 CARE OF WORKS

From the commencement to the completion of works and handing over, the contractor shall take full responsibility for care thereof all the works and in case of any damage/loss to the works or to any part thereof or to any temporary works due to lack of precautions or due to negligence on part of Contractor, the same shall be made good by the Contractor.

43.0 SETTING OUT OF THE WORKS

The contractor shall be responsible for the true and proper setting out of the works and for the correctness of the position, levels, dimensions and alignment of all parts of the works. If at any time during the progress of works, shall any error appear or arise in the position, levels, dimensions or alignment of any part of the works, the contractor shall at his own expenses rectify such error to the satisfaction of Engineer-in-Charge. The checking of any setting out or of any line or level by the engineers of RGIPT shall not in any way relieve the contractor of his responsibility for the correctness.

44.0 NOTICE BEFORE COVERING UP THE WORK

The contractor shall give not less than seven day notice before covering up or otherwise placing beyond the reach of measurement any work, to the Engineer-in-charge in order that the same may be inspected and measured. If any work is covered up or placed beyond the reach of inspection/measurement without such notice or his consent being obtained the same shall be uncovered at the contractor expenses and he shall have to make it good at his own expenses.

45.0 SITE CLEARANCE

45.1 The contractor shall ensure that the working site is kept clean and free of obstructions for easy access to job site and also from safety point of view. Before handing over the work to the RGIPT the contractor shall remove all temporary structures like the site offices, cement go-down, stores etc., scaffolding rubbish, debris etc. left over materials tools and plants, equipments etc., clean the site to the entire satisfaction of the Engineer-in-charge. If this is not done the same will be got done by RGIPT at his risk and cost.

45.2 The contractor shall clean all floors, remove cement/ lime/ paint drops and deposits, clean joinery, glass panes etc., touching all painter's works and carry out all other necessary items of works to make the premises clean and tidy before handing over the building, and the rates quoted by the contractor shall be deemed to have included the same.

46.0 SET-OFF OF CONTRACTOR'S LIABILITIES

RGIPT shall have the right to deduct or set off the expenses incurred or likely to be incurred by it in rectifying the defects and/or any claim under this agreement against the Contractor from any or against any amount payable to the contractor under this agreement including security deposit and proceeds of performance guarantee.

47.0 EMPLOYMENT OF PERSONNEL

- 47.1 The contractor shall employ only Indian Nationals as his representatives, servants and workmen after verifying their antecedents and loyalty. He shall ensure that no personnel of doubtful antecedents and any other nationality in any way is associated with the works.
- 47.2 In case RGIPT observed misconduct negligence or incompetence etc. on the part of any representative, agent, servant and workmen or employees etc. Of the contractor, the RGIPT shall have full power and without giving any reason to the contractor, instruct the contractor to remove such engineer/ staff / worker from site and provide suitable replacements. The decision of the Engineer-in-charge shall be final and binding on the contractor. The contractor shall not be allowed any compensation on this account.

48.0 TECHNICAL STAFF FOR WORK

- 48.1 The contractor shall employ at his cost the adequate number of technical staff during the execution of this work depending upon the requirement of work. For this purpose, the numbers to be deployed, their qualification, experience as decided by RGIPT shall be final and binding on contractor. The contractor shall not be entitled for any extra payment in this regard. The technical staff should be available at site, whenever required by RGIPT to take instructions.
- 48.2 Within 15 days of Letter of Award, the contractor shall submit a details of technical team proposed to be deputed by him at site including details of experience and should be taken approval from Engineer-in-Charge in this regard.

49.0 ADHERENCE TO LABOUR LAW AND REGULATIONS

The Contractors, who are working in the establishments through Contract Labour and/or employing labour themselves directly should get themselves registered with the Assistant Labour Commissioner concerned as required under Contract Labour (Regulation and Abolition) Act 1971 and obtain a license from the Assistant Labour Commissioner concerned and produce the same to Engineer-in-charge. However, a copy of application for obtaining labour license may be submitted to Engineer-in-charge within the 10 days from the date of issue of Letter of Award.

49.1 LABOUR SAFETY PROVISION

The contractor shall be fully responsible to observe the labour safety provisions. The contractor shall at his own cost take all precautions to ensure safety of life and property by providing necessary barriers, lights, watchmen etc. During the progress of work as directed by Engineer-in-Charge.

49.2 EPF & ESI

The Contractor shall submit proof of having valid EPF & ESIC registration certificate. EPF and ESI, if applicable, will be reimbursed on actual basis after due verification.

- 49.3 The contractor will abide by all the rules and regulations related to labour laws, accident, workmen compensation act, workmen insurance etc. This will be the sole responsibility of the contractor. RGIPT will not be a party at any stage in any of the dispute relating to the above. In case, RGIPT has to bear any expenditure due to non-conformance of the above provisions by the contractor, the same will be recovered from the contractor's bill.

In case any accident (threatening of life, physical disability etc.) occur during the period of contract, the contractor will be sole responsible for the same and RGIPT will be not be a party for consequences thereof.

50.0 LABOUR CESS

The rates of the contractor shall be inclusive of labour cess. RGIPT shall make a recovery @ 1% on account of labour cess from each RA bill of the contractor and labour cess so recovered/deducted shall be deposited with the Labour Board of the concerned state.

51.0 CHANGE IN FIRM'S CONSTITUTION TO BE INTIMATED

Where the contractor is a partnership firm, the prior approval in writing of the Engineer-in-Charge shall be obtained before any change is made in the constitution of the firm. Where the contractor is an individual or a Hindu undivided family business concern such approval as aforesaid shall likewise be obtained before the contractor enters into any partnership agreement where under the partnership firm would have the right to carry out the works hereby undertaken by the contractor.

52.0 LAW COVERING THE CONTRACT

This contract shall be governed by the Indian laws for the time being in force.

53.0 LAWS, BYE-LAWS RELATING TO THE WORK

The contractor shall strictly adhere by the provisions, for the time being in force, of law relating to works or any regulations and bylaws made by any local authority or any water & lighting agencies or any undertakings within the limits of the jurisdiction of which the work is proposed to be executed. The contractor shall be bound to give to the authorities concerned such notices and take all approvals as may be provided in the law, regulations or bylaws as aforesaid, and to pay all fees and taxes payable to such authorities in respect thereof.

54.0 CONTRACT AGREEMENT

The Contractor shall enter into a Contract Agreement with the RGIPT within 20 (Twenty) days from the date of Letter of Award failing which no payment shall be released to the contractor. The cost of stamp papers, stamp duty, registration, if applicable on the contract, shall be borne by the contractor. In case, the contractor does not sign the agreement as above or start the work within 10 (Ten) days of the issue of letter of Award, his earnest money is liable to be forfeited and Letter of award consequently will stand withdrawn.

55.0 MANNER OF EXECUTION OF AGREEMENT

- i. The agreement as per prescribed Performa as enclosed shall be signed at the office of the RGIPT within 20 (Twenty) days from the date of issue of Letter of Award. The Contractor shall provide for signing of the Contract, appropriate Power of Attorney and the requisite documents/ materials. Unless and until a formal contract is prepared and executed, the Letter of Award read in conjunction with the Tendering Documents will constitute a binding contract.
- ii. The agreement will be signed in two originals and the Contractor shall be provided with one signed original and the other originals will be retained by the RGIPT.
- iii. **The Contractor shall provide free of cost to the RGIPT all the Engineering data, drawings and descriptive materials submitted along with the tender, in at least two (2) copies to form an integral part of the Agreement within 15 days after issuing of Letter of Award.**

56.0 ARBITRATION:

All disputes or differences whatsoever arising among the parties under and/or in connection with and/or in respect of this tender shall be referred to and decided by a sole arbitrator, who shall be appointed by the Director, RGIPT. The arbitration shall be conducted in accordance with Arbitration

and Conciliation Act of 1996, along with its relevant amendments and the venue of the arbitration shall be in RGIPT, Jais, Amethi. The proceedings of arbitration shall be in English language.

57.0 JURISDICTION

The agreement shall be executed on non-judicial stamp paper and jurisdiction to deal with any matters arising there from will be in Rae Bareli Court.

SPECIAL CONDITIONS OF CONTRACT

1. Architectural Design being supplied by RGIPT for all purposes. However, if any, further detailing is required, the same will be got done by the bidder and got approved from RGIPT. Nothing extra beyond the item rate bid price quoted by the bidder shall be payable on this account.
2. Contractor has to submit detailed drawing for Ductable Split AC as complete air distribution system with required duct size, selection of grills / air diffusers with detailed calculation for air flow rate for all the areas. Drawing will be got approved by the bidder from RGIPT before starting the work. Nothing extra beyond the item rate bid price quoted by the bidder shall be payable on this account.
3. The whole of the works included in the Contract shall be executed by the contractor and the contractor shall not directly or indirectly transfer, assign or underlet the contract or any part, share or interest therein without the written consent of the Engineer-in-Charge.
4. The contractor has to engage specialized agencies depending upon the nature and complexity of the work with the prior approval of the Engineer-in-Charge for works and any other specialized works. To this regard, the contractor has to submit the completion certificates / required documents of similar type of works executed by the sub-contractor / specialized agencies to establish the sub-contractor's / specialized agencies' workmanship. Also the contractor has to submit shop drawings done by the specialized agency for approval of Engineer-in-Charge before procuring and installing the item. This does not in any way relieve the contractor of his obligations to get the quality work and architectural design as desired by the RGIPT.
5. The drawing, specification and other related documents shall be considered as part of the contract. Any work or material shown on the drawings but not included in the specifications, or vice versa shall be executed as if called for in both.
6. Vehicles hired for bringing construction material to the site and other machinery to be used during construction should be in good conditions and should conform to applicable air and noise emission standards.
7. Ambient noise levels should conform to prescribed standards both during day and night, Incremental pollution loads on the ambient air and noise quality should be closely monitored during construction phase.
8. Any item can be omitted, substituted or added as per actual requirement of the Engineer-in-charge. No claim in this regard will be entertained.
9. Nothing extra will be paid due to loss/damage caused by rains, floods, war, strike of the departmental officials or any other act of god or any other cause whatsoever.
10. Nothing extra shall be paid for unforeseen delay on account of non-availability of any kind of material, drawing or designs.
11. The work will be executed strictly in accordance with the CPWD specifications (latest edition corrected upto date of the tender) to the entire satisfaction of the Engineer-in-charge.
12. No claim on account of paucity of funds or any other caused what so ever will be entertained and the contractor/firm will have no right to go on for Arbitration or in the court.

13. In case any dispute/ambiguity, the decision of the Engineer-in-charge, RGIPT shall be final and binding.
14. Nothing extra shall be paid if any local carriage of material is done irrespective of lead and lift.
15. All electrical work shall be carried out in compliance with compliance with the Indian Electricity Act and rules in force.
16. Electrical installation work shall comply with all currently applicable standards and all materials, fitting and fixtures used in electrical works shall be ISI marked and confirm to the Indian Standard specification wherever these exist. The materials shall be approved by the Engineer in Charge.
17. In case of any leftover of condition in the tender document, then for any such specific condition and requirement, CPWD Works Manual and Manual for Procurement of Works 2019 with its amendments, from time to time will be referred for necessary reference, clarity and adherence.
18. It is the sole responsibility of the contractor to get the approval of drawings from the RGIPT, as per the need and requirement to maintain the speed of work. In case, if there is any delay observed because of non-approval of drawings from RGIPT, it will be concluded on the head of the contractor and no extra time will be given for the same. RGIPT will give the approval within 7 days from the submission of design.

SPECIFICATIONS

The work in general shall be executed as per the description of the item, C.P.W.D specifications (Including latest updated amendments), and Bureau of Indian Standards (BIS) as indicated below: -

- a) C.P.W.D specifications 2019 volume I (Civil Works)
- b) C.P.W.D specifications 2019 volume II (Civil Works)
- c) C.P.W.D specifications 2013 volume I (Electrical Works)
- d) Ductable Split AC work shall be carried out by CPWD Specification.
- e) LAN Networking will be done as per BOQ Serial No. 81 to 84.

SCOPE OF WORK

Scope of work shall include but is not limited to the following head:

- a) PCC & RCC
- b) Steel Reinforcement
- c) Brickwork & Plaster
- d) Water Proofing work in sunken area of toilets
- e) Flooring, Paint
- f) Door, Aluminium Partition with Glass
- g) Sanitary Fittings & Fixtures
- h) False Ceiling
- i) Electrical Conduit Work, Distribution Board, Cable Laying
- j) Switches & Sockets
- k) Wiring, LED Lighting

l) Ductable Split AC Unit

Supply, installing, testing and commissioning of ceiling mounted AIR COOLED SPLIT AIR CONDITIONING UNITS with hermetic/semi-hermetic type scroll compressors, single or Multiple Compressors and first charge of R22/ R134a/R410a etc. The unit shall be complete with cabinet type fan coil unit and external condensing unit, including Air distribution system comprising of ducting, valves, dampers, grilles & diffusers as complete.

- i) Supply, installation, testing and commissioning of Indoor and Outdoor Units.
- ii) Supply and installation of control and transmission wiring between indoor and outdoor units complete in all respect. Power cable for indoor units are excluded from the scope.
- iii) Supply, Installation and testing of Interconnecting refrigerant Copper piping with nitrile rubber insulation with proper clamping.
- iv) Site Fabricated Duct: Supply, Fabrication, Installation and testing of sheet metal ducts in accordance with the approved drawings. The duct shall be fabricated at site to suit pieces, and as per site requirements. Supply, installation, testing and commissioning of G.I. ducts with Acoustic Insulation as per latest Indian Standards / CPWD Guidelines with necessary support, fittings and thermal duct insulation of Nitrile rubber /XLPE /closed cell polyethylene, 12mm thick as required complete in all respect..
- v) Supply and installation of Dampers, valves, Powder coated extruded Aluminum grilles of approved shade and color with VCD / square shape air diffuser etc. to meet required flow (CFM) after considering air change rate as per latest CPWD Guidelines / Indian Std for noise less operation of respective areas.

- vi) Supply and installation of canvas connection wherever required.
- vii) Supply and installation of common drain pipe of rigid heavy duty UPVC drain piping (20/25/32 mm dia) suitable for 10 kg/ sqcm pressure rating for indoor units complete with necessary elbow, tees, reducers, brass connector between GI and PVC pipe etc. All drain piping shall be insulated with 6mm thick sleeve of nitrile rubber.
- viii) Supply and fixing of MS Stand for outdoor unit.
- ix) LAN Wiring with PO switches.
- x) Fire Fighting (Fire Extinguisher).

LIST OF APPROVED MAKES

List of Makes of materials approved by the Engineer in charge/Owner are listed below (Refer materials whichever are applicable for the scope of work). However, approved equivalent materials of any other specialized firms confirming to relevant IS may be used, in case it is established that the brands specified below are not available in the market subject to approval of the alternate brand by the Engineer in charge.

LIST OF MAKES FOR CIVIL WORKS		
SL.NO.	MATERIALS	MANUFACTURER/SUPPLIER/MAKE
MISC. ITEMS		
1	CEMENT(OPC / PPC)	A.C.C.,ULTRATECH,BIRLA,GUJARATAMBUJA,VIKRAM,JP REWA,LAFARGE,CCI,JAYPEECEMENT,SHREECEMENT, J.K. CEMENT, L&T
2	WHITE CEMENT	J. K., BIRLA WHITE
3	WATER PROOFING COMPOUND	PIDLITE, FOSROC, CICO, SIKA
4	REINFORCEMENT STEEL	TISCO, SAIL, RINL, JINDAL, ESSAR, JSW STEEL LTD, ISPAT
5	STRUCTURAL STEEL	TISCO, SAIL, RINL, JINDAL, JSW STEEL LTD, ISPAT
6	PIGMENT	SUDERSHAN, CHEMICAL INDUSTRIES LTD., TATA PIGMENT
7	STAINLESS STEEL SCREWS	GKW, KUNDAN, PRIYA, ATUL, PUJA
8	ANCHOR FASTENERS	HILTI, FISCHER
9	POLYSULPHIDE/ SILICON SEALANT	PIDILITE,FOSROC,DOWCORNING,GE, CHEMETALL-RAI,WACKER,CICO,CHOKSEYCHEMICALS, SIKA, DOW CORNING
10	BITUMEN	INDIAN OIL, HINDUSTAN PETROLEUM, BHARAT PETROLEUM
11	BACKER ROD	SUPREME IND LTD., SYSTRANS POLYMERS, RACHTR CHEMICALS

12	ADHESIVES & GROUTS	KERAKOLL, BAL ENDURA, LATICRETE, FOSROC, PIDILITE
13	SS CLAMPS, PINS (CLADDING)	HALFEN, FISCHER, HILTI
14	BLINDS	VISTA/ DECOREX /ELEGANT DÉCOR/ HUNTER DOUGLAS
15	FIRE EXTINGUISHERS	NEWAGE, SPAGO, CEASE FIRE, MINIMAX
FLOOR/WALL FINISHING		
16	VITRIFIED TILES, CERAMIC TILES	KAJARIA, EURO, H&R JOHNSON, NITCO, RAK, SOMANY, RESTILE, ORIENT
17	PLASTER OF PARIS (POP)	J. K., BIRLA WHITE
18	PUTTY	BIRLA WHITE, JK CEMENT, ASIAN
19	CEMENT PRIMER	NEROLAC/BP WHITE (BERGER)/DECOPRIME-WT (ASIAN)/WHITE PRIMER (ICI)
20	ACRYLIC/ PLASTIC EMULSION	ASIAN PAINTS/ DULUX / NEROLAC/BERGER/ICI
21	POLISHING ON WOODWORK	ASIAN PAINTS, SHALIMAR PAINTS
FALSE CEILING		
22	GYPSUM BOARD	LAFARGE BORAL/ SAINT GOBAIN GYPROC/ ARMSTRONG
23	CALCIUM SILICATE BOARDS / TILES	HILUX (RAMCO INDUSTRIES LTD.), AEROLITE, PROMAT
WOOD WORK		
24	FLUSH DOOR, BLOCK BOARD, PLYWOOD	DUROPLY INDUSTRIES LTD., GREEN PLY, CENTURY,NATIONAL
25	PRELAMINATED PARTICLE BOARD	CENTURY, MERINO, ACTION TESA, ARCHID, NATIONAL, ECOBOARD, ANCHOR
26	DECORATIVE LAMINATE	FORMICA/ GREENLAM/ MERINOLAM/DURO/ CENTURY

DOORS AND WINDOWS		
27	ALUMINIUM EXTRUDED PROFILES	HINDALCO/ JINDAL/INDAL
28	EPDM GASKET	MANU, ANAND, RAVEN, ROOP, LESCUYER
29	FIBER REINFORCED PLASTIC (FRP) DOORS	ROOFFIT OR APPROVED EQUIVALENT
30	FROSTED GLASS	GOLD PLUS, PILKINGTON, AIS
31	MORTICE LOCK, CYLINDRICAL LOCK, SS HANDLES, TOWER BOLTS, HINGES, HYDRAULIC DOOR CLOSER, DOOR STOPPER	GODREJ/ DORMA/ OZONE/ DORSET/ HETTICH
SANITARY FIXTURES AND FITTINGS		
32	VITREOUS CHINA SANITARYWARE	PARRYWARE, HINDWARE, KOHLER, CERA
33	WC CONNECTORS	MULTIKWIK (UK), PRINCE, SUPREME, VIEGA, ASTRAL, SUPREME
34	CONCEALED CISTERN	PARRYWARE, HINDWARE, KOHLER
35	SEAT COVER (HEAVY DUTY)	PARRYWARE, HINDWARE, KOHLER
36	AUTO (INFRA RED BASED) URINAL FLUSH SYSTEM (BATTERY OPERATED)	PARRYWARE, HINDWARE, KOHLER
37	SANITARY FIXTURES AND CP FITTINGS	JAQUAR, PLUMBER, KOHLAR, HINDWARE
38	COCKROACH PROOF GRATING	CHILLY, VIKING, CAPRI
39	FACE MIRROR	SAINT GOBIN, MODIGUARD, AIS, GOLDEN, PILKINGTON
40	PVC PIPES AND FITTINGS	ASTRAL,PRINCE,SUPRME,FINOLEX, AKG
41	CPVC PIPES AND FITTINGS	ASTRAL,PRINCE,SUPRME,FINOLEX, AKG
LIST OF MAKES FOR ELECTRICAL WORKS		
Sl. No.	MATERIALS	MANUFACTURER/SUPPLIER/MAKE
1	FINAL DISTRIBUTION BOARD	LEGRAND, L&T, ABB, SIEMENS, SCHNEIDER ELECTRIC, GE, HAVELLS.

2	MOULDED CASE CIRCUIT BREAKER (MCCB)	LEGRAND, L&T, ABB, SIEMENS, SCHNEIDER ELECTRIC, GE, HAVELLS.
3	MINIATURE CIRCUIT BREAKERS (MCB)	LEGRAND, L&T, ABB, SIEMENS, SCHNEIDER ELECTRIC, GE, HAVELLS.
4	RESIDUAL CURRENT CIRCUIT BREAKER (RCCB)	LEGRAND, L&T, ABB, SIEMENS, SCHNEIDER ELECTRIC, GE, HAVELLS.
5	LT JOINTING KIT / TERMINATION	BIRLA-3M, RAYCHEM, MAHINDRA, SAFE KIT
6	CABLE GLANDS WITH EARTHING LINKS	BRACO,COMET (COMEX), HEX BRASS
7	BIMETTALIC CABLE LUG	BRACO, COMET, DOWELL'S (BILLER INDIA), HEX BRASS (COPPER ALLOY INDIA)
8	PVC INSULATED COPPER CONDUCTOR STRANDED FLEXIBLE WIRES	HAVELLS, KEI, POLYCAB, R R KABEL, FINOLEX
9	LEAD COATED FLEXIBLE GI CONDUIT	PLICA INDIA PVT. LTD., FLEXICON
10	PVC ,MS CONDUIT & ACCESSORIES (ISI APPROVED)	AKG, BEC, PRECISION, D-PLAST, POLYCAB
11	SWITCH , SOCKET,POWER UNITS,ACCESORIES	CLIPSAL (OPAL SERIES), CRABTREE, LEGRAND (MOAIC), WIPRO (NORTHWEST), ANCHOR ROMA, HAVELLS, SCHNEIDER
12	LED LIGHTING FXITURE	PHILIPS, CROMPTON, HAVELLS, COMPACT, WIPRO, OSRAM
13	CABLE TRAYS (FACTORY FABRICATED) / RACEWAYS	PROFAB ENGINEER, RICCO STEEL, SLOTCO, MAHESHWARI ELECTRTRICAL, NEEEDO, MEM
14	TERMINAL BLOCK/CONNECTOR	ELMEX, CONNECTWELL, WAGO
15	SEALING COMPOUND	HILTI, 3M, M SEAL

LIST OF MAKES FOR DUCTABLE SPLIT AC WORKS

Sl. No.	MATERIALS	MANUFACTURER/SUPPLIER/MAKE
1	DUCTABLE SPLIT AIR CONDITIONING UNIT	BLUE STAR/ VOLTAS/ CARRIER/ HITACHI/DAIKIN/MITSUBISHI

2	GSS SHEET	JINDAL / SAIL / TATA
3	CONTROL CABLES	GLOSTER/ POLYCAB/ NICCO /KEI / HPL
4	POWER CABLES	CCI/ GLOSTER/POLYCAB/ NICCO / KEI / HPL
5	GRILLES/ FIRE DAMPERS/DIFFUSERS/ VCD	CARYAIRE/PREMIER/ DYNACRAFT / RAVISTAR
6	EXPANDED POLYSTYRENE	THERMOLLOYD/ BEARDSELL/ ASTHA POLYMER
7	GI SHEET	JINDAL / SAIL / TATA
8	MS PIPE	TATA/ JINDAL
9	DUCT THERMAL INSULATION	ARMAFLEX/ K-FLEX/ A-FLEX/ UP TWIGA
10	DUCT ACOUSTIC INSULATION	ARMAFLEX/ K-FLEX/ UP TWIGA
11	VALVES	ADVANCE/C&R/ AUDCO/ LEADER
12	STRAINER	SANT/ DS ENGINEERING
13	3/2WAY MIXING VALVES	JOHNSON / BELIMO / HONEYWELL

LIST OF APPROVED MAKE FOR LAN NETWORKING

Sl. No.	MATERIALS	MANUFACTURER/SUPPLIER/MAKE
1	UTP 4 pair CAT-6 LAN CABLE	DLINK / SCHNEIDER / BELDEN / TETABYTE / DLINK / DIGISOL
2	RJ 45 CONNECTOR	DLINK / SCHNEIDER / BELDEN / TETABYTE / DLINK / DIGISOL
3	LAN I/O NETWORK PORT	DLINK / SCHNEIDER / BELDEN / TETABYTE / DLINK / DIGISOL
4	POE NETWORK SWITH	CISCO

DRAWINGS

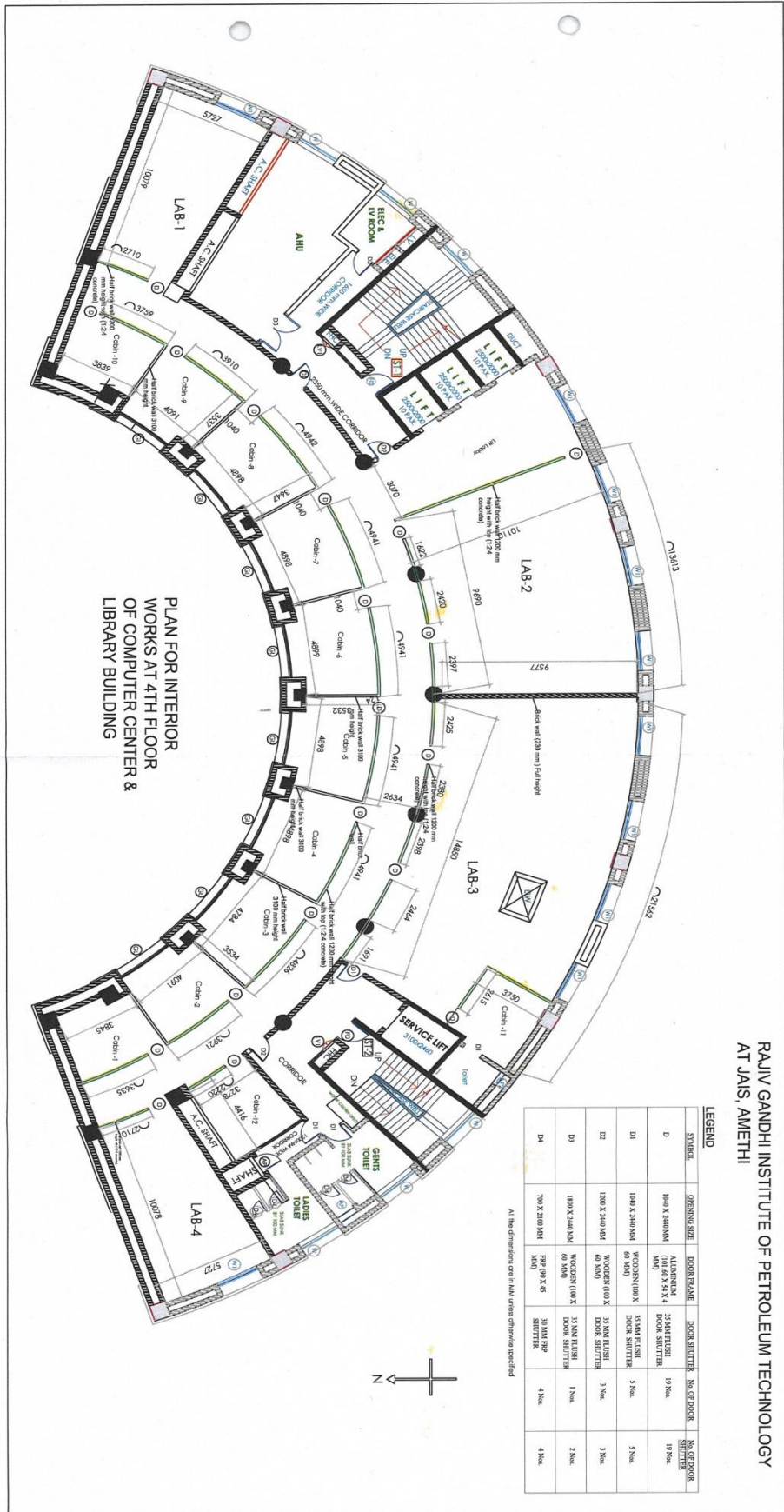

PLAN FOR INTERIOR WORKS AT 4TH FLOOR OF COMPUTER CENTER & LIBRARY BUILDING

Signature
Work books

RAJIV GANDHI INSTITUTE OF PETROLEUM TECHNOLOGY
AT JAIS, AMETHI

LEGEND

SYMBOL	OPENING SIZE	DOOR FRAME	DOOR SHUTTER	NO. OF DOOR	NO. OF DOOR
D	1800 X 2400 MM	ALUMINIUM 100 X 40	35 MM FLUSH DOOR SHUTTER	19 Nos.	17 Nos.
D1	1800 X 2400 MM	WOODEN (100 X 40 X 20)	35 MM FLUSH DOOR SHUTTER	5 Nos.	5 Nos.
D2	1200 X 2400 MM	WOODEN (100 X 40 X 20)	35 MM FLUSH DOOR SHUTTER	3 Nos.	3 Nos.
D3	1800 X 2400 MM	WOODEN (100 X 40 X 20)	35 MM FLUSH DOOR SHUTTER	1 Nos.	2 Nos.
D4	700 X 2100 MM	STEEL 90 X 50	30 MM RFP SHUTTER	4 Nos.	4 Nos.

All the dimensions are in MM unless otherwise specified

RAJIV GANDHI INSTITUTE OF PETROLEUM TECHNOLOGY
AT JAIS, AMETHLI

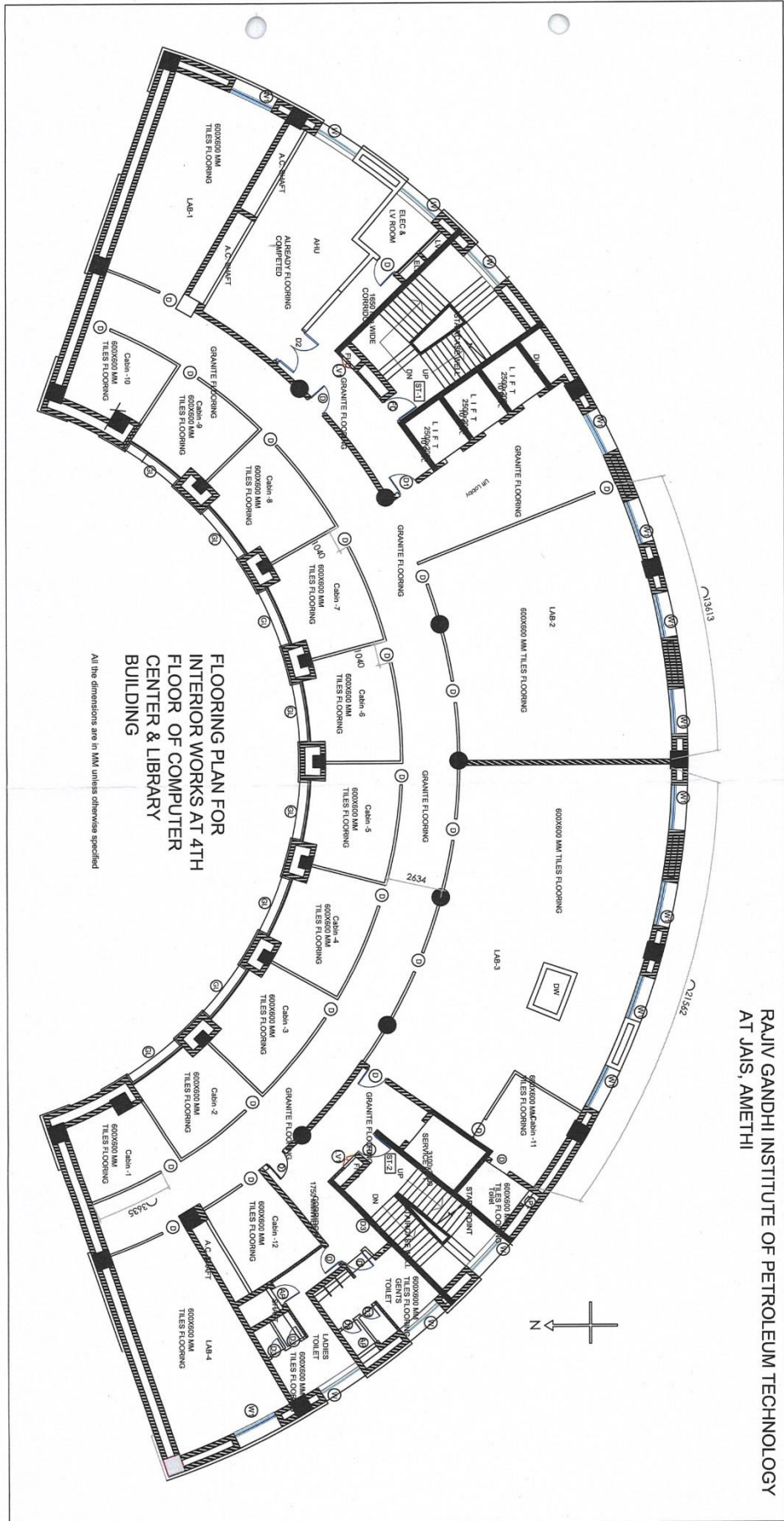

FLOORING PLAN FOR
INTERIOR WORKS AT 4TH
FLOOR OF COMPUTER
CENTER & LIBRARY
BUILDING

All the dimensions are in MM unless otherwise specified

Shiraj
Mark Labels

Boyer
Paint Papers

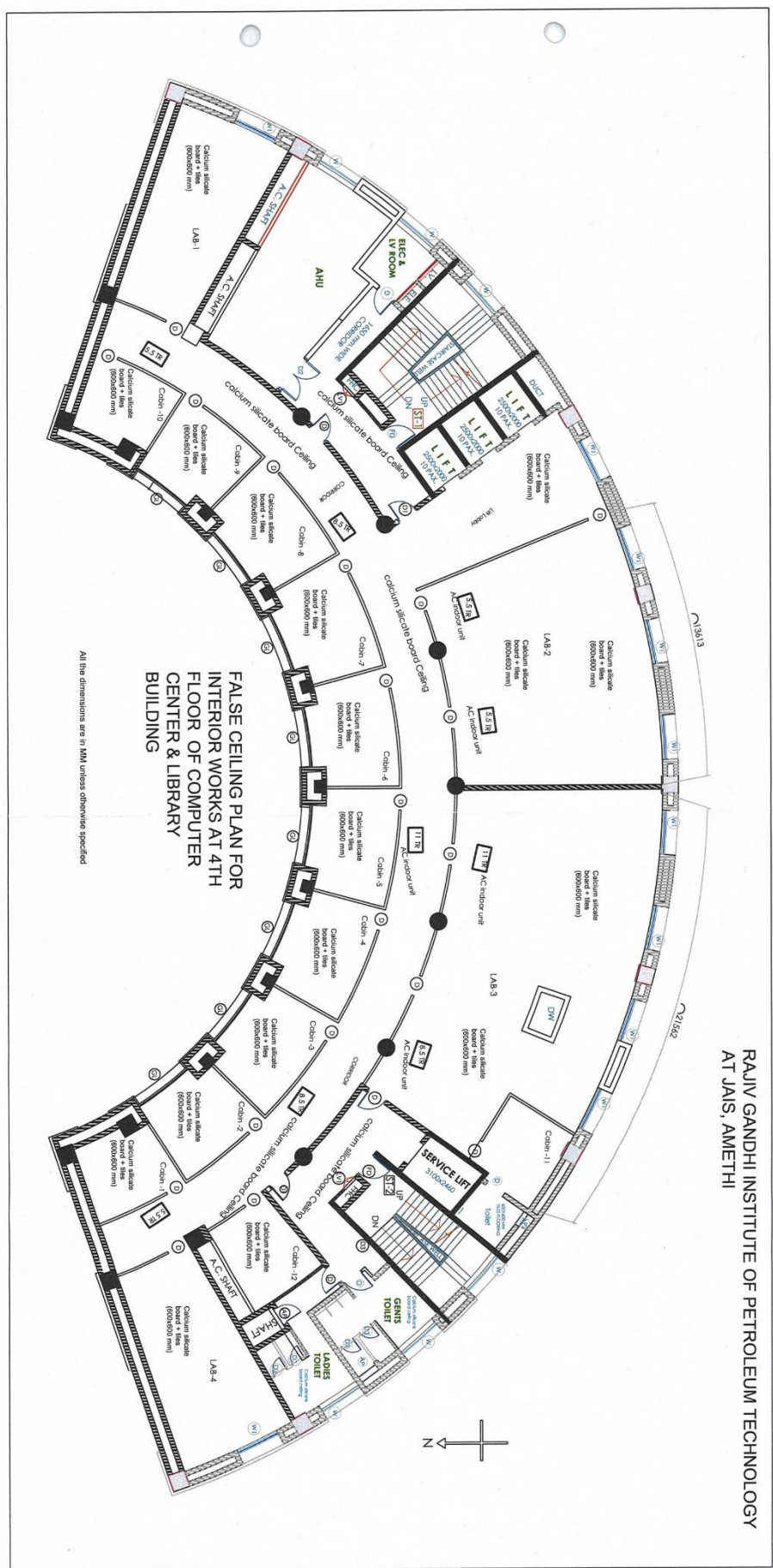

RAJIV GANDHI INSTITUTE OF PETROLEUM TECHNOLOGY
 AT JAIS, AMETHI

RAJIV GANDHI INSTITUTE OF PETROLEUM TECHNOLOGY
AT JAIS, AMETHI

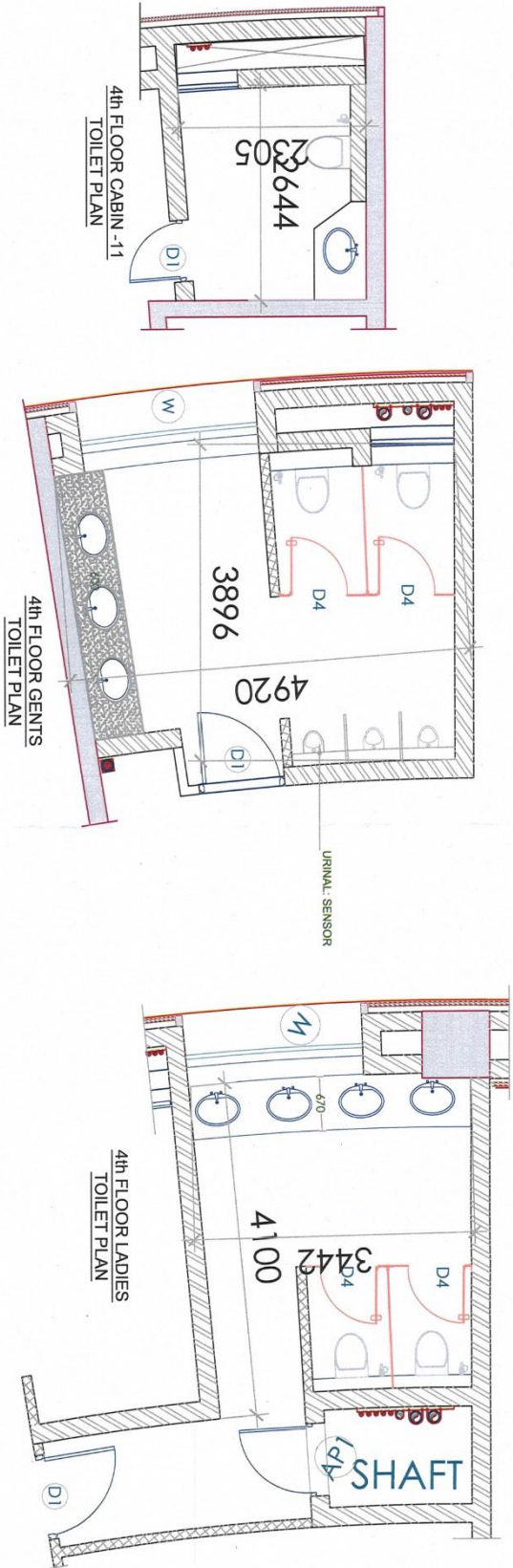

TOILET PLAN FOR INTERIOR WORKS AT 4TH
FLOOR OF COMPUTER CENTER & LIBRARY
BUILDING

All the dimensions are in MM unless otherwise specified

Sharma

Harish Chandra

RAJIV GANDHI INSTITUTE OF PETROLEUM TECHNOLOGY
AT JAIS, AMETHLI

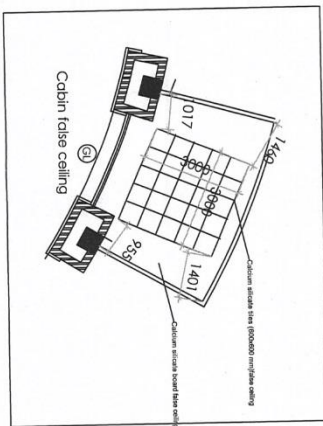
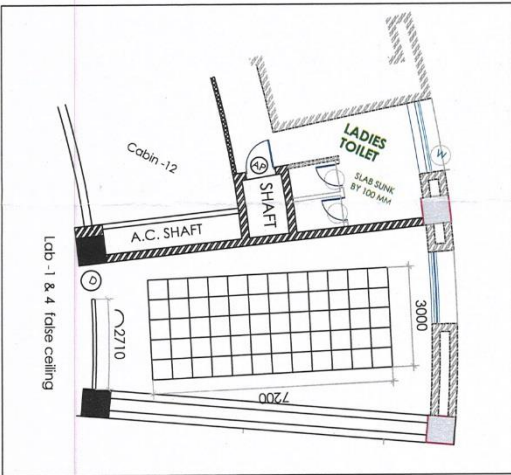
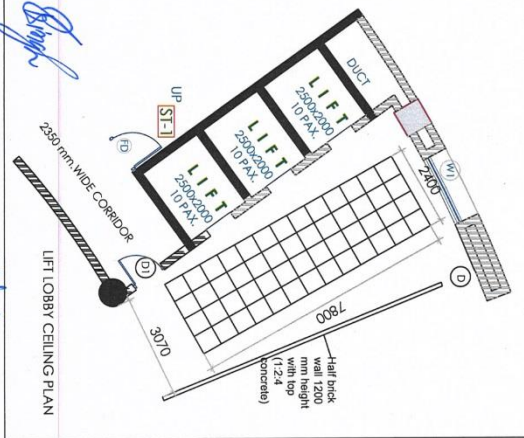
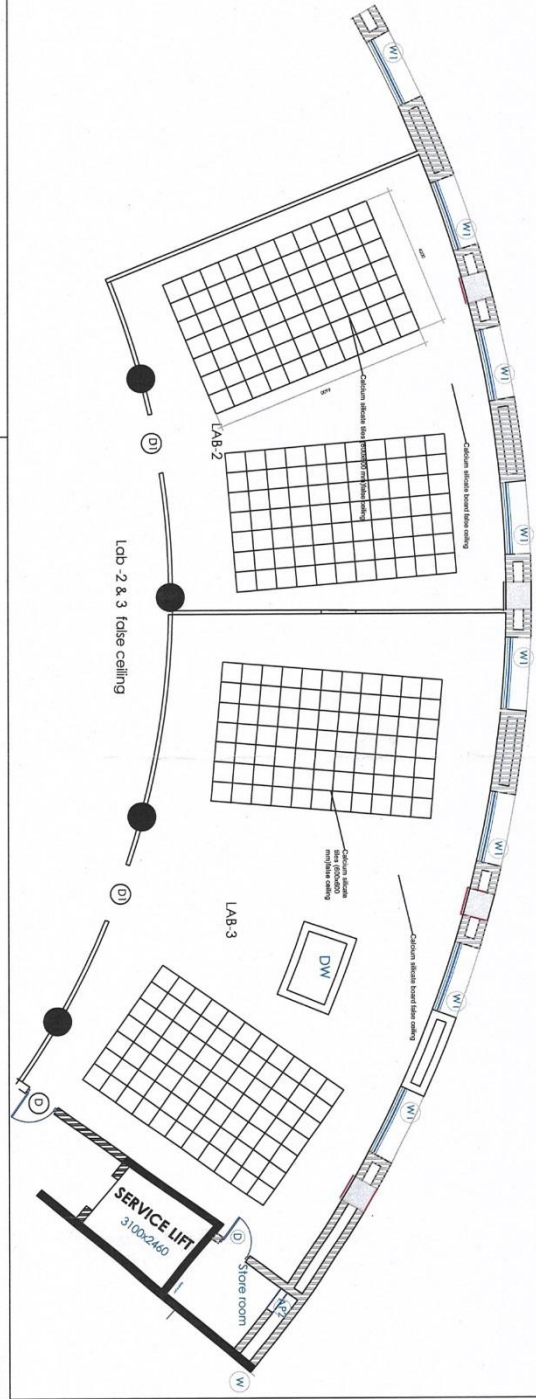

DETAILS OF FALSE
CEILING FOR INTERIOR
WORKS AT 4TH FLOOR
OF COMPUTER CENTER &
LIBRARY BUILDING

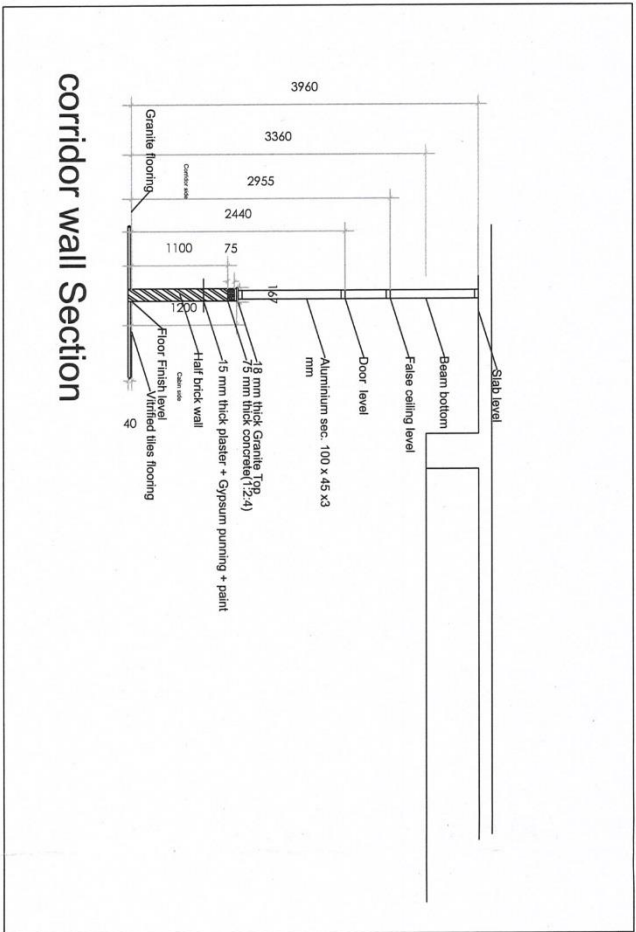

corridor wall Section

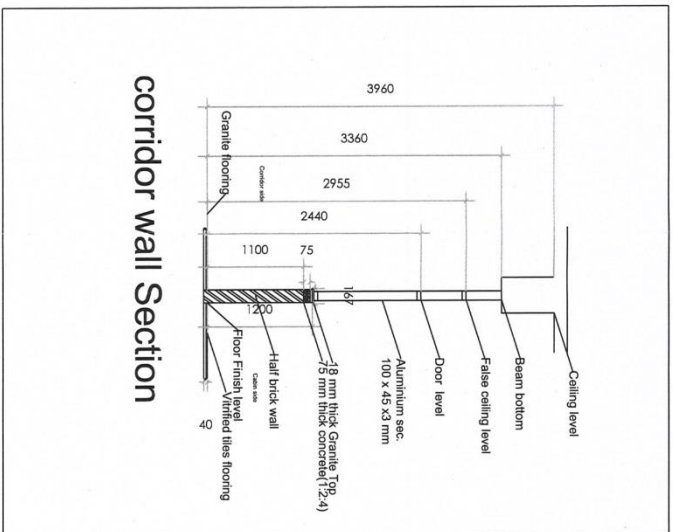

corridor wall Section

**SECTIONAL DETAILS FOR 4TH FLOOR
INTERIOR WORKS OF COMPUTER
CENTER & LIBRARY BUILDING**

Signature

Kamal Jadhav

All the dimensions are in MM unless otherwise specified

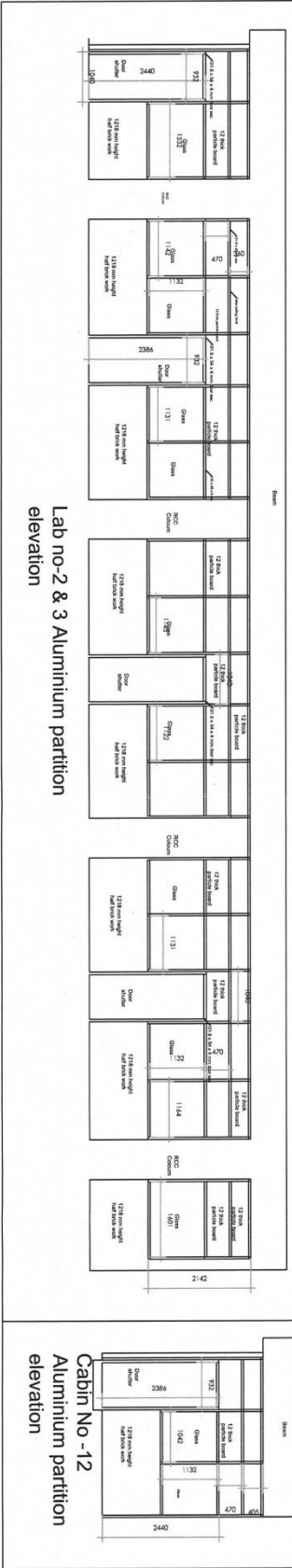
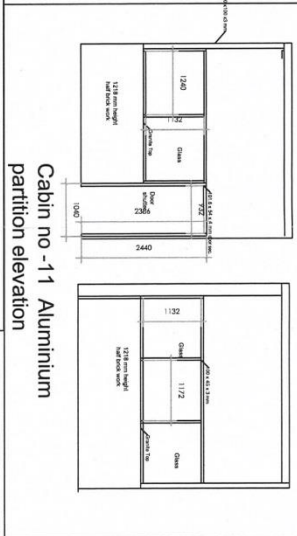
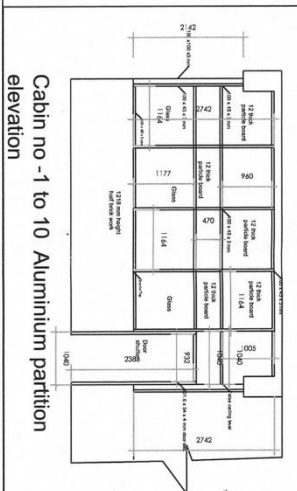
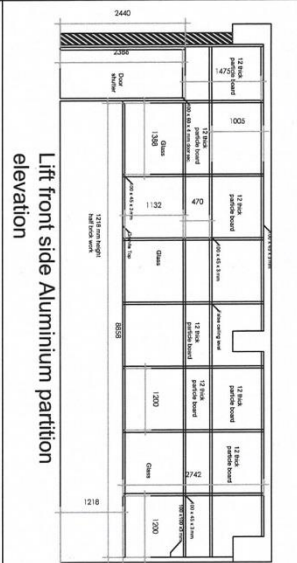

DETAILS OF ALUMINIUM PARTITION FOR INTERIOR WORKS AT 4TH FLOOR OF COMPUTER CENTER & LIBRARY BUILDING

All the dimensions are in MM unless otherwise specified

- NOTE:**
- 1) Partition Sec - 101.6 X 45 X 3 mm
 - 2) Carrier Sec - 100 X 100 X 3 mm
 - 3) Door Sec - 101.60 X 54 X 4 mm

Shree
Prashant

PLAN FOR INSTALLATION OF DUCTABLE SPLIT AIR CONDITIONING UNITS

DRAWING NO. : RGIPT/DUCTIBLE SPLIT AC LAYOUT 2020-21/01

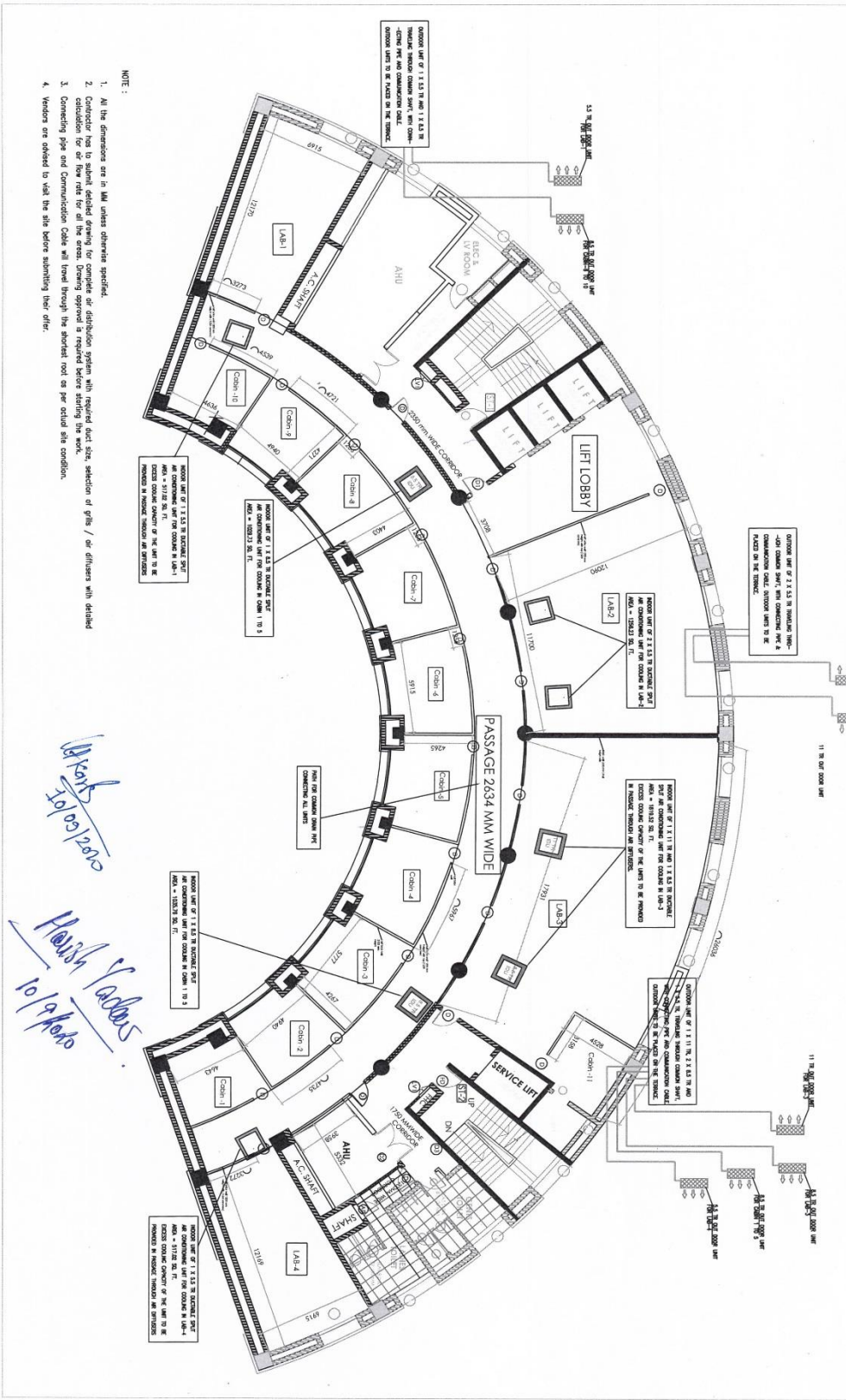

- NOTE :
1. All the dimensions are in MM unless otherwise specified.
 2. Contractor has to submit detailed drawing for complete air distribution system with required duct size, selection of pipes / air diffusers with detailed calculation for air flow rate for all the areas. Drawing approval is required before starting the work.
 3. Connecting pipe and Communication Cable will travel through the shaftwell roof as per actual site condition.
 4. Vendors are advised to visit the site before submitting their offer.

Handwritten notes:
 10/19/2020
 Hersh Vaidya
 10/19/2020

TECHNICAL BID FORMAT

1	Name and Registered Office Address of the firm/ Company/ Proprietorship. Copy of Certificate of Incorporation / Registration or any other relevant document, as applicable, should be submitted along with a copy of address proof Copy of constitution or legal status of the sole proprietorship / firm / company etc.	
2	Telephone Nos./ Mobile Nos.	
3	E-mail ID	
4	Earnest Deposits money (EMD) (Yes/No) Proof of submission of EMD should be submitted by the bidder.	
5	PAN Number Copy of PAN Card should be submitted by the bidder.	
6	Bank Account details Copy of cancelled cheque should be submitted by the bidder.	
7	a) EPF Registration Number b) ESI Registration Number Copy of registration certificate should be submitted by the bidder.	
8	GSTIN Registration Number Copy of GST Registration Certificate should be submitted by the bidder.	
9	Contractor's Enlistment Certificate with the CPWD (Yes / No). Copy of enlistment certificate should be submitted by the bidder.	
10	Completion Certificate in support of single work of similar nature for an amount of Rs.1.0 Cr. during last 5 years (Yes / No). Copy of work completion certificate should be submitted by the bidder.	

11	<p>Average Annual Financial Turnover during last 3 financial years i.e. for 2016-17, 2017-18 & 2018-19 in the format as prescribed in Annexure - 3 (Yes / No)</p> <p>Copy of profit and loss account of the balance sheet and CA Certificate of annual reports should be submitted by the bidder.</p>	
12	<p>Income Tax Return filed acknowledgement for last 3 years i.e. for 2016-17, 2017-18 & 2018-19. (Yes / No)</p> <p>Copy of ITRs should be submitted by the bidder.</p>	
13	<p>Audited Annual Account of last 3 years i.e. for Financial Years 2016-17, 2017-18 & 2018-19. (Yes / No)</p> <p>Copy of same should be submitted by the bidder.</p>	
14	<p>Notarized Affidavit on Non-Judicial stamp paper of Rs 100.00 regarding firm not being blacklisted or debarred by any Government Department in any State in the format as prescribed in Annexure-8 (Yes / No)</p> <p>Copy of the same should be submitted by the bidder.</p>	
15	<p>Acceptance of Tender Conditions (Yes / No):</p> <p>Bidders should submit the Annexure – 2 duly signed and after putting the company stamp.</p>	

(Signatures of the authorized signatory
with seal of tendering firm)

ACCEPTANCE OF TENDER CONDITIONS

From: (To be submitted in Original on the letter head of the company by the authorized officer having power of attorney)

RAJIV GANDHI INSTITUTE OF PETROLEUM TECHNOLOGY
Mubarakpur, Mukhetia, Bahadurpur, Post : Harbanshganj,
Jais, Amethi- 229304

Sub: Interior Works (Civil, Electrical, Ductable Split AC and LAN Networking) at 4th floor of Computer Centre & Library Building & RGIPT/JAIS/IWD/INTERIOR/01/2020-21:

Sir,

- i) This has reference to above referred tender. I/We are pleased to submit our tender for the above work and I/We hereby unconditionally accept the tender conditions and tender documents in its entirety for the above work.
- ii) I/We are eligible to submit the tender for the subject tender and I/We are in possession of all the documents required.
- iii) I/We have viewed and read the terms and conditions of this GCC/SCC carefully. I/We have downloaded the following documents forming part of the tender document:
 - a) Table of contents
 - b) Notice Inviting E-Tender
 - c) Instructions For Online Bid Submission
 - d) Instruction to Bidders
 - e) General Conditions of the Contract
 - f) Special Conditions of the Contract
 - g) Specifications
 - h) Scope of Work
 - i) List of Approved Makes
 - j) Drawings
 - k) Addendum/Corrigendum, if any- Duly signed by authorized person
 - l) Pre-bid clarifications, if any
 - m) Annexure – 1 (Technical Bid Format)
 - n) Annexure - 2 (Acceptance of Tender conditions)

- o) Annexure - 3 (Average Annual Financial Turnover)
 - p) Annexure -4 [Letter of Award (LOA)of Contract]
 - q) Annexure -5 [Proforma of Bank Guarantee (Performance)
 - r) Annexure -6 (Agreement Form)
 - s) Annexure -7 (No Claim Certificate)
 - t) Annexure -8 (Form of Declaration regarding Blacklist / Debar / Integrity)
- iv) I/we have uploaded the mandatory scanned documents such as EMD, e-Tender Processing Fee and other documents as per Notice Inviting e-tender AND I/We agree to pay the cost of EMD, e-Tender Processing Fee (only receipt/proof of online payment).
- v) Should this tender be accepted, I/We agree to abide by and fulfill all terms and conditions referred to above and as contained in tender documents elsewhere and in default thereof, to forfeit and pay RGIPT, or its successors or its authorized nominees such sums of money as are stipulated in the notice inviting tenders and tender documents.
- vi) If I/we fail to commence the work within 10 days of the date of issue of Letter of Award and/or I/we fail to sign the agreement as per Clause 54 of Clauses of General Conditions of Contract and/or I/we fail to submit performance guarantee as per Clause 02 of Clauses of General Conditions of Contract, I/we agree that RGIPT shall, without prejudice to any other right or remedy, be at liberty to cancel the Letter of Award and to forfeit the said earnest money as specified above.

Yours faithfully,
(Signature of the tenderer with rubber stamp)

Dated _____

AVERAGE ANNUAL FINANCIAL TURNOVER

Turnover of the Bidder in last 3 years (Please submit CA certified copy of Annual Reports)

Year	Annual Report Submitted (Yes / No)	Turnover in Rs. (Lakh)	Profit/ Loss
2016-2017			
2017-2018			
2018-2019			
Total			
Average			

LETTER OF AWARD (LOA) OF CONTRACT

RAJIV GANDHI INSTITUTE OF PETROLEUM TECHNOLOGY

Mubarakpur, Mukhetia, Bahadurpur, Post : Harbanshganj,
Jais, Amethi- 229304

Contract No:

Contract Title:

To,

M/ s. [Insert name & address]

Sub: Award of contract for contract no: [insert contract number] and contract title: [insert contract title]

Reference: Your offer against our tender no. [Insert tender no] opened on [insert date of opening of tender]

Dear Sir/ Madam

I am directed to inform you that after evaluating the bid documents submitted by you on [enter date] RGIPT is pleased to inform you that you have been selected as the successful bidder for the work of [enter description]. The total cost of work shall be [enter amount] as indicated in your financial bid submitted on [enter date], in accordance with the procedures intimated in the bid documents.

You/ your authorized representative(s) are requested to be personally present at [insert address] for the signing of the contract agreement of this work within 20 days from the date of issue of this allotment letter.

In this respect, we also request you to submit the performance bank guarantee / FDR in favour of 'Rajiv Gandhi Institute of Petroleum Technology, Amethi for an amount of equal to 5% of the amount of contract value [insert amount of Rupees in words] and which should be valid for one year and 60 days after the completion of work otherwise no payment will be made on account of this work.

This letter of award concludes the legally binding contract between you and the RGIPT, till issue of a formal contract.

Yours truly,

.....

.....

RGIPT, Jais, Amethi

PROFORMA OF BANK GUARANTEE (PERFORMANCE)

(Judicial Stamp paper of appropriate value as per stamp Act-of respective state)

To,

RAJIV GANDHI INSTITUTE OF PETROLEUM TECHNOLOGY
Mubarakpur, Mukhetia, Bahadurpur, Post : Harbanshganj,
Jais, Amethi- 229304

Whereas the Rajiv Gandhi Institute of Petroleum Technology, Jais , Amethi, Uttar Pradesh – 229304 (hereinafter called "RGIPT" which expression include its successors and assigns) having awarded a work order/contract order No..... dated (hereinafter called the contract) to M/s. (hereinafter called the contractor) at a total price of Rs..... subject to the terms and conditions contained in the contract.

WHEREAS, the terms and conditions of the contract require the contractor to furnish a bank guarantee for Rs..... (Rupees.....) being% of the total value of the contract for proper execution and due fulfillment of the terms and conditions contained in the contract.

We, the Bank, (hereinafter called the "Bank") do hereby unconditionally and irrevocably undertake to pay to RGIPT immediately on demand in writing and without protest/or demur all moneys payable by the contractor to RGIPT in connection with the execution of and performance of the works, inclusive of any loss, damages, charges, expenses and costs caused to or suffered by or which would be caused to or suffered by RGIPT by reason of any breach by the contractor of any of the terms and conditions contained in the contract as specified in the notice of demand made by RGIPT to the bank. Any such demand made by RGIPT on the bank shall be conclusive evidence of the amount due and payable by the bank under this guarantee. However, the Bank's liability under this guarantee, shall be limited to Rs.....in the aggregate which shall be valid up to and the bank hereby agrees to the following terms and condition:-

- (i) This guarantee shall be a continuing guarantee and irrevocable for all claims of RGIPT as specified above and shall be valid during the period specified for the performance of the contract.
- (ii) We, the said bank further agree with RGIPT that RGIPT shall have the fullest liberty without our consent and without affecting in any manner our obligations and liabilities hereunder to vary any of the terms and conditions of the said contract or to extend time for performance of contract by the contractor from time to time or to postpone for any time or from time to time any of the powers exercisable by RGIPT against the contractor under the contract and forbear or enforce any of the terms and conditions relating to the said contract and we shall not be relieved from our liability by reason of any such variations or extension being granted to the contractor or for any forbearance, act or omission on the part of RGIPT or any indulgence by RGIPT to the contractor or by any such matter or thing whatsoever, which under the law relating to the sureties would, but for this provision, have effect of so relieving us.

- (iii) This guarantee/undertaking shall be in addition to any other guarantee or security whatsoever RGIPT may now or at any time have in relation to the performance of the works/equipment and the company shall have full re-course to or enforce this security in performance to any other security or guarantee which the RGIPT may have or obtained and there shall be no forbearance on the part of the company in enforcing or requiring enforcement of any other security which shall have the effect of releasing the Bank from its full liability. It shall not be necessary for RGIPT to proceed against the said contractor before proceeding against the Bank.
- (iv) This guarantee/ undertaking shall not be determined or affected by the liquidation or winding up, dissolution or change of constitution or insolvency of the contractor, but shall in all respects and for all purposes be binding and operative until payment of all moneys payable to RGIPT in terms thereof are paid by the Bank.
- (v) The Bank hereby waives all rights at any time inconsistent with the terms of this Guarantee and the obligations of the bank in terms hereof, shall not be otherwise effected or suspended by reasons of any dispute or disputes having been raised by the contractor (whether or not pending before any Arbitrator, Tribunal or Court) or any denial of liability by the contractor stopping or preventing or purporting to stop or prevent any payment by the Bank to RGIPT in terms hereof.

We, the said Bank, lastly undertake not to revoke this guarantee during its currency except with the previous consent of RGIPT in writing upon expiry of which, we shall be relieved from all liabilities under this guarantee thereafter.

Signed this day of at.....

FOR AND ON BEHALF OF BANK

PLACE:

DATED:

WITNESS.

1

2

AGREEMENT FORM

This agreement made this day of (Month) (Year), between **the Rajiv Gandhi Institute of Petroleum Technology**, Jais, Amethi- 229304 (hereinafter referred to as the “RGIPT” which expression shall include its administrators, successors, executors and assigns) of the one part and **M/s (NAME OF CONTRACTOR)** (hereinafter referred to as the ‘Contractor’ which expression shall unless the context requires otherwise include its administrators, successors, executors and permitted assigns) of the other part.

WHEREAS, RGIPT, has desirous of construction of **(NAME OF WORK)** (hereinafter referred to as the “PROJECT”), had invited tenders as per Tender documents vide NIT No. _____.

AND WHEREAS **(NAME OF CONTRACTOR)** had participated in the above referred tender vide their tender dated _____ and RGIPT has accepted their aforesaid tender and award the contract for (Name of Project) on the terms and conditions contained in its Letter of Award No. _____ and the documents referred to therein, which have been unequivocally accepted by **(NAME OF CONTRACTOR)** acceptance letter dated _____ resulting into a contract.

NOW THEREFORE THIS DEED WITNESSETH AS UNDER:

ARTICLE 1.0 – AWARD OF CONTRACT

1.1 SCOPE OF WORK

RGIPT has awarded the contract to **(NAME OF CONTRACTOR)** for the work of **(NAME OF WORK)** on the terms and conditions in its letter of award No. _____ dated _____ and the documents referred to therein. The award has taken effect from **(DATE)** i.e. the date of issue of aforesaid letter of award. The terms and expressions used in this agreement shall have the same meanings as are assigned to them in the “Contract Documents” referred to in the succeeding Article.

ARTICLE 2.0 – CONTRACT DOCUMENTS

2.1 The contract shall be performed strictly as per the terms and conditions stipulated herein and in the following documents attached herewith (hereinafter referred to as “Contract Documents”).

- a) RGIPT Notice Inviting Tender vide No. _____ date _____ and RGIPT’s tender documents consisting of:
 - i) Letter of award
 - ii) Contractor's bid
 - iii) Special Conditions of Contract (SCC)
 - iv) General Conditions of Contract (GCC)
 - iv) Bill of Quantities
 - v) Drawings

vi) Any other documents listed in the contact data as forming part of the contract

2.2 All the aforesaid contract documents referred to in Para 2.1 above shall form an integral part of this Agreement, in so far as the same or any part thereof column, to the tender documents and what has been specifically agreed to by RGIPT in its Letter of Award. Any matter inconsistent therewith, contrary repugnant thereto or deviations taken by the Contractor in its “TENDER” but not agreed to specifically by RGIPT in its Letter of Award, shall be deemed to have been withdrawn by the Contractor without any cost implication to RGIPT. For the sake of brevity, this Agreement along with its aforesaid contract documents and Letter of Award shall be referred to as the “Contract”.

ARTICLE 3.0 – CONDITIONS & CONVENANTS

3.1 The scope of Contract, Consideration, terms of payments, advance, security deposits, taxes wherever applicable, insurance, agreed time schedule, compensation for delay and all other terms and conditions contained in RGIPT’s Letter of Award No. _____ dated _____ are to be read in conjunction with other aforesaid contract documents. The contract shall be duly performed by the contractor strictly and faithfully in accordance with the terms of this contract.

3.2 The scope of work shall also include all such items which are not specifically mentioned in the Contract Documents but which are reasonably implied for the satisfactory completion of the entire scope of work envisaged under this contract unless otherwise specifically excluded from the scope of work in the Letter of Award.

3.3 Contractor shall adhere to all requirements stipulated in the Contract documents.

3.4 Time is the essence of the Contract and it shall be strictly adhered to. The progress of work shall conform to agreed works schedule/contract documents and Letter of Award.

3.5 This agreement constitutes full and complete understanding between the parties and terms of the presents. It shall supersede all prior correspondence to the extent of inconsistency or repugnancy to the terms and conditions contained in Agreement. Any modification of the Agreement shall be effected only by a written instrument signed by the authorized representative of both the parties.

3.6 The total contract price for the entire scope of this contract as detailed in Letter of Award is Rs. _____ (Rupees _____ only), which shall be governed by the stipulations of the contract documents.

ARTICLE 4.0 – GOVERNING LAW AND JURISDICTION

4.1 The Laws applicable to this contract shall be the laws in force in India and jurisdiction of Rae Bareli Court (s) only.

4.2 Notice of Default

Notice of default given by either party to the other party under the Agreement shall be in writing and shall be deemed to have been duly and properly served upon the parties hereto, if delivered against acknowledgment due or by FAX or by registered mail duly addressed to the signatories at the address mentioned herein above.

IN WITNESS WHEREOF, the parties through their duly authorized representatives have executed these presents (execution whereof has been approved by the Competent Authorities of both the parties) on the day, month and year first above mentioned at RGIPT, Jais, Amethi.

For and on behalf of:

(NAME OF CONTRACTOR)

WITNESS:

1.

For and on behalf of:

M/s RGIPT

WITNESS:

1.

NO CLAIM CERTIFICATE
(On company letterhead)

To,

(Contract Executing Officer)

Procuring Entity

Sub: Contract Agreement no. dated for the work of.....

We have received the sum of Rs..... (Rupees only) in full and final settlement of all the payments due to us for the work of under the above-mentioned contract agreement, between us and Rajiv Gandhi Institute of Petroleum Technology. We hereby unconditionally, and without any reservation whatsoever, certify that with this payment, we shall have no claim whatsoever, of any description, on any account, against Procuring Entity, against aforesaid contract agreement executed by us. We further declare unequivocally, that with this payment, we have received all the amounts payable to us, and have no dispute of any description whatsoever, regarding the amounts worked out as payable to us and received by us, and that we shall continue to be bound by the terms and conditions of the contract agreement, as regards performance of the contract.

Yours faithfully,

Signatures

Name of Contractor or Officer Authorised
to sign the contract documents on behalf of contractor
(Company stamp)

Date:

Place:

Form of Declaration regarding Blacklist / Debar / Integrity

(To be executed in the Non Judicial Stamp Paper of Rs.100/- and duly notarised)

This is to certify that _____ (Name of the organization), having registered office at _____ (Address of the registered office) has never been blacklisted or restricted to apply for any such activities by any Central / State Government Department /Semi Government department/ PSU/ Autonomous bodies or Court of law anywhere in the country.

Yours faithfully,
Signatures

Name of Contractor or Officer Authorised
to sign the contract documents on behalf of Contractor

(Company stamp)

Date:

Place:

Check List

Sl. No.	Particulars	Documents uploaded (Bidders to tick Yes/No)
1	Technical Bid (Part A)	
1.1	Copy of Certificate of Incorporation / Registration or any other relevant document, as applicable, should be submitted along with a copy of address proof Copy of constitution or legal status of the sole proprietorship / firm / company etc.	Yes / No
1.2	Proof of submission of EMD of Rs 2,50,000/- through e-payment Gateway available on https://rgipt.euniwizarde.com .	Yes / No
1.3	Copy of PAN Card	Yes / No
1.4	Copy of cancelled Cheque for bank details	Yes / No
1.5	Copy of EPF & ESI Registration Certificate	Yes / No
1.6	Copy of GST Registration Certificate	Yes / No
1.7	Copy of enlistment certificate with CPWD	Yes / No
1.8	Acceptance of Tender Conditions	Yes / No
1.9	Copy of Completion Certificate in support of single work of similar nature for an amount of Rs.1.0 Crore during last 5 years.	Yes / No
1.10	Copy of profit and loss account of the balance sheet and CA Certificate of annual reports for Average Financial Turnover during last 3 financial years i.e. for 2016-17, 2017-18 & 2018-19.	Yes / No
1.11	Income Tax Return filed acknowledgement for last 3 years i.e. for 2016-17, 2017-18 & 2018-19.	Yes / No
1.12	Audited Annual Account of last 3 years i.e. for Financial Years 2016-17, 2017-18 & 2018-19.	Yes / No
1.13	Notarized Affidavit on Non-Judicial stamp paper of Rs 100.00 regarding firm not being blacklisted or debarred by any Government Department in any State	Yes / No
2	Price Bid (Part B)	
2.1	BOQ	Yes / No

Note: - Scanned copy of entire NIT is to be attached duly signed & stamped by the bidder.



विद्यारत्नम् महच्छनम्

राजीव गाँधी पेट्रोलियम प्रौद्योगिकी संस्थान जायस, अमेठी,
उ. प्र.

RAJIV GANDHI INSTITUTE OF PETROLEUM TECHNOLOGY

JAIS, AMETHI (U.P.) – 229 304

Website: www.rgipt.ac.in

E-TENDER FOR INTERIOR WORKS

(CIVIL, ELECTRICAL, DUCTABLE SPLIT AC AND LAN NETWORKING)

AT 4TH FLOOR OF COMPUTER CENTER AND LIBRARY BUILDING

PART – B : PRICE BID

NOTICE INVITING TENDER NO. : RGIPT/JAIS/IWD/INTERIOR/01/2020-21

DATED: 12.10.2020

Last Date & Time of Submission: 02/11/2020 (Monday) by 3:00 P.M

S.no.	Description of Items	Unit	Quantity	Rate (Rs.)	Amount in Figure (Rs.)	Amount in Words (Rs.)
Civil Works						
	Dismantling/ Demolishing Work					
1	"Demolishing brick work manually/ by mechanical means including stacking of serviceable material and disposal of unserviceable material within 50 metres lead as per direction of Engineer-in-charge. In cement mortar"	cum	15.30			
	Steel Reinforcement					
2	"Steel reinforcement for R.C.C. work including straightening, cutting, bending, placing in position and binding all complete above plinth level. Thermo-Mechanically Treated bars of grade Fe-500D or more."	kg	485.50			
	Form Work					
3	"Centering and shuttering including strutting, propping etc. and removal of form work for : Lintels, beams, plinth beams, girders, bressumers and cantilevers"	sqm	5.24			
4	"Centering and shuttering including strutting, propping etc.	sqm	21.96			

	and removal of form work for : Small lintels not exceeding 1.5 m clear span, moulding as in cornices, window sills, string courses, bands, copings, bed plates, anchor blocks and the like"					
	Plain Cement Concrete (PCC)					
5	Providing and laying cement concrete in retaining walls, return walls, walls (any thickness) including attached pilasters, columns, piers, abutments, pillars, posts, struts, buttresses, string or lacing courses, parapets, coping, bed blocks, anchor blocks, plain window sills, fillets, sunken floor etc., up to floor five level, excluding the cost of centering, shuttering and finishing: 1:2:4 (1 Cement : 2 coarse sand (zone-III) : 4 graded stone aggregate 20 mm nominal size)	cum	1.98			
6	"Providing and laying cement concrete in retaining walls, return walls, walls (any thickness) including attached pilasters, columns, piers, abutments, pillars, posts, struts, buttresses, string or lacing courses, parapets, coping, bed blocks, anchor blocks, plain window sills, fillets, sunken floor etc., up to floor five level, excluding the cost of centering, shuttering and finishing:	cum	22.20			

	1:5:10 (1 cement : 5 coarse sand (zone-III) : 10 graded stone aggregate 40 mm nominal size)."					
	Reinforced Cement Concrete (RCC)					
7	Reinforced cement concrete work in beams, suspended floors, roofs having slope up to 15° landings, balconies, shelves, chajjas, lintels, bands, plain window sills, staircases and spiral stair cases above plinth level up to floor five level, excluding the cost of centering, shuttering, finishing and reinforcement, with 1:1.5:3 (1 cement : 1.5 coarse sand(zone-III) : 3 graded stone aggregate 20 mm nominal size).	cum	1.19			
	Water Proofing					
8	"Providing and laying water proofing treatment to vertical and horizontal surfaces of depressed portions of W.C., kitchen and the like consisting of: (i) Ist course of applying cement slurry @ 4.4 kg/sqm mixed with water proofing compound conforming to IS 2645 in recommended proportions including rounding off junction of vertical and horizontal surface. (ii) IInd course of 20 mm cement plaster 1:3 (1 cement : 3	sqm	61.44			

	coarse sand) mixed with water proofing compound in recommended proportion including rounding off junction of vertical and horizontal surface. iii) IIIrd course of applying blown or residual bitumen applied hot at 1.7 kg. per sqm of area (iv) IVth course of 400 micron thick PVC sheet. (Overlaps at joints of PVC sheet should be 100 mm wide and pasted to no. other with bitumen @ 1.7 kg/sqm)."					
	Masonry Work					
9	"Brick work with common burnt clay F.P.S. (non modular) bricks of class designation 7.5 in superstructure above plinth level up to floor V level in all shapes and sizes in : Cement mortar 1:4 (1 cement : 4 coarse sand)"	cum	10.76			
10	"Half brick masonry with common burnt clay F.P.S. (non modular) bricks of class designation 7.5 in superstructure above plinth level up to floor V level Cement mortar 1:3 (1 cement :3 coarse sand)"	sqm	228.25			
	Finishing					
11	"12 mm cement plaster of mix : 1:4 (1 cement: 4 fine sand)"	sqm	389.72			
12	"15 mm cement plaster on the rough side of single or half	sqm	312.46			

	brick wall of mix : 1:4 (1 cement: 4 fine sand)"					
13	Providing and applying plaster of paris putty of 2 mm thickness over plastered surface to prepare the surface even and smooth complete.	sqm	1428.96			
14	Providing and applying white cement based putty of average thickness 1 mm, of approved brand and manufacturer, over the plastered wall surface to prepare the surface even and smooth complete.	sqm	2184.56			
15	"Applying one coat of water thinnable cement primer of approved brand and manufacture on wall surface : Water thinnable cement primer"	sqm	2184.56			
16	"Wall painting with acrylic emulsion paint of approved brand and manufacture to give an even shade : Two or more coats on new work"	sqm	2184.56			
	Flooring					
17	"Providing and laying vitrified floor tiles in different sizes (thickness to be specified by the manufacturer) with water absorption less than 0.08% and conforming to IS: 15622, of approved make, in all colours and shades, laid on 20mm thick cement mortar 1:4 (1 cement : 4 coarse sand),	sqm	605.36			

	jointing with grey cement slurry @ 3.3 kg/ sqm including grouting the joints with white cement and matching pigments etc., complete. Size of Tile 600x600 mm"					
18	"Providing and laying Vitrified tiles in different sizes (thickness to be specified by manufacturer), with water absorption less than 0.08 % and conforming to I.S. 15622, of approved make, in all colours & shade, in skirting, riser of steps, over 12 mm thick bed of cement mortar 1:3 (1 cement: 3 coarse sand), jointing with grey cement slurry @ 3.3 kg/ sqm including grouting the joint with white cement & matching pigments etc. complete. Size of Tile 600x600 mm"	sqm	34.01			
19	"Providing and laying antiskid vitrified floor tiles in different sizes (thickness to be specified by the manufacturer) with water absorption less than 0.08% and conforming to IS: 15622, of approved make, in all colours and shades, laid on 20mm thick cement mortar 1:4 (1 cement : 4 coarse sand), jointing with grey cement slurry @ 3.3 kg/ sqm including grouting the joints with white	sqm	40.42			

	<p>cement and matching pigments etc., complete. Size of Tile 600x600 mm"</p>					
20	<p>"Providing and fixing 1st quality ceramic glazed wall tiles conforming to IS : 15622 (thickness to be specified by the manufacturer) of approved make in all colours, shades except burgundy, bottle green, black of any size as approved by Engineer-in-Charge in skirting, risers of steps and dados (Walls) over 12 mm thick bed of cement Mortar 1:3 (1 cement: 3 coarse sand) and jointing with grey cement slurry @ 3.3kg per sqm including pointing in white cement mixed with pigment of matching shade complete. Size of Tile 300x450 mm"</p>	sqm	206.83			
21	<p>"Providing and laying Polished Granite stone flooring in required design and patterns, in linear as well as curvilinear portions of the building all complete as per the architectural drawings with 18 mm thick stone slab over 20 mm (average) thick base of cement mortar 1:4 (1 cement : 4 coarse sand) laid and jointed with cement slurry and pointing with white cement slurry admixed with pigment of matching shade including rubbing , curing and polishing etc.</p>	sqm	249.55			

	<p>all complete as specified and as directed by the Engineer-in-Charge.</p> <p>Polished Granite stone slab jet Black, Cherry Red, Elite Brown, Cat Eye or equivalent."</p>					
22	<p>"Polished Granite Stones 18 mm thick in risers of steps, skirting, dado and pillars laid on 12 mm (average) thick cement mortar 1:3 (1 cement: 3 coarse sand) and jointed with grey cement slurry mixed with pigment to match the shade of the slabs, including rubbing and polishing complete.</p> <p>Polished Granite stone slab jet Black, Cherry Red, Elite Brown, Cat Eye or equivalent."</p>	sqm	36.57			
23	<p>"Providing and fixing 18 mm thick gang saw cut, mirror polished, premoulded and prepolished, machine cut for kitchen platforms, vanity counters, window sills, facias and similar locations of required size, approved shade, colour and texture laid over 20 mm thick base cement mortar 1:4 (1 cement : 4 coarse sand), joints treated with white cement, mixed with matching pigment, epoxy touch ups, including rubbing, curing, moulding and polishing to edges to give high gloss finish etc. complete at all levels.</p>	sqm	39.68			

	Granite of any colour and shade Area of slab over 0.50 sqm"					
24	"Providing edge moulding to 18 mm thick marble stone counters, Vanities etc., including machine polishing to edge to give high gloss finish etc. complete as per design approved by Engineer-in-Charge. Granite work"	meter	228.35			
25	Extra for providing opening of required size & shape for wash basin/ kitchen sink in kitchen platform, vanity counter and similar location in marble/ Granite/ stone work, including necessary holes for pillar taps etc. including moulding, rubbing and polishing of cut edges etc. complete.	no	7.00			
26	"Providing and fixing stone slab with table rubbed, edges rounded and polished, of size 75x50 cm deep and 1.8 cm thick, fixed in urinal partitions by cutting a chase of appropriate width with chase cutter and embedding the stone in the chase with epoxy grout or with cement concrete 1:2:4 (1 cement : 2 coarse sand : 4 graded stone aggregate 6 mm nominal size) as per direction of Engineer-incharge and finished smooth. Granite Stone of approved shade"	sqm	0.75			
	Wood Work					

27	<p>"Providing wood work in frames of doors, windows, clerestory windows and other frames, wrought framed and fixed in position with hold fast lugs or with dash fasteners of required dia & length (hold fast lugs or dash fastener shall be paid for separately). Second class teak wood"</p>	cum	0.85			
28	<p>"Providing and fixing ISI marked flush door shutters conforming to IS : 2202 (Part I) decorative type, core of block board construction with frame of 1st class hard wood and well matched teak 3 ply veneering with vertical grains or cross bands and face veneers on both faces of shutters. 35 mm thick including ISI marked 4 no. Stainless Steel ball bearing butt hinges with necessary screws"</p>	sqm	65.95			
29	<p>Providing and fixing Fiber Glass Reinforced plastic (FRP) Door Frames of cross-section 90 mm x 45 mm having single rebate of 32 mm x 15 mm to receive shutter of 30 mm thickness. The laminate shall be moulded with fire resistant grade unsaturated polyester resin and chopped mat. Door frame laminate shall be 2mm thick and shall be filled with suitable wooden block in all the three legs. The frame shall be covered with fiber glass from all sides. M.S. stay shall be</p>	meter	20.20			

	provided at the bottom to steady the frame.					
30	"Providing and fixing to existing door frames 30 mm thick Glass Fibre Reinforced Plastic (FRP) panelled door shutter of required colour and approved brand and manufacture, made with fire - retardant grade unsaturated polyester resin, moulded to 3 mm thick FRP laminate for forming hollow rails and styles, with wooden frame and suitable blocks of seasoned wood inside at required places for fixing of fittings, cast monolithically with 5 mm thick FRP laminate for panels conforming to IS: 14856, including fixing to frames."	sqm	5.88			
31	Extra for providing lipping with 2nd class teak wood battens 25 mm minimum depth on all edges of flush door shutters (over all area of door shutter to be measured).	sqm	65.10			
32	"Providing and fixing wooden moulded beading to door and window frames with iron screws, plugs and priming coat on unexposed surface etc. complete : 2nd class teak wood 50x12 mm"	meter	59.96			
33	Melamine polishing on wood work (one or more coat).	sqm	150.54			
34	Providing and fixing brush finish SS mortice dead lock with	no	27.00			

	cylinder 70 mm, one side key and other side knob without pair of handles of approved quality, with necessary screws etc., all complete as per direction of Engineer in charge.					
35	Providing and fixing stainless steel cylindrical lock of approved quality for FRP door shutter, with necessary screws etc complete as per direction of Engineer- in-charge.	no	5.00			
36	Providing and fixing aluminium extruded section body tubular type universal hydraulic door closer (having brand logo with ISi, IS : 3564, embossed on the body, door weight upto 36 kg to 80 kg and door width from 701 mm to 1000 mm), with double speed adjustment with necessary accessories and screws etc. complete.	no	27.00			
37	"Providing and fixing SS 304 Grade 19 mm dia door handles with necessary screws etc. complete: 150 mm long (D Type) "	pair	32.00			
38	"Providing and fixing stainless steel tower bolt of approved quality for door shutter, with necessary screws etc complete as per direction of Engineer- in-charge. 300x10 mm"	no	12.00			
39	"Providing and fixing aluminium hanging floor door stopper, ISI marked, anodised (anodic coating not less than grade AC 10 as per IS : 1868) transparent or dyed to	no	27.00			

	required colour and shade, with necessary screws etc. complete. Twin rubber stopper"					
	Aluminium / Glass Work					
40	"Providing and fixing aluminium work for doors, windows, ventilators and partitions with extruded built up standard tubular sections/ appropriate Z sections and other sections of approved make conforming to IS: 733 and IS: 1285, fixing with dash fasteners of required dia and size, including necessary filling up the gaps at junctions, i.e. at top, bottom and sides with required EPDM rubber/ neoprene gasket etc. Aluminium sections shall be smooth, rust free, straight, mitred and jointed mechanically wherever required including cleat angle, Aluminium snap beading for glazing / paneling, C.P. brass / stainless steel screws, all complete as per architectural drawings and the directions of Engineer-in-charge. (Glazing, paneling and dash fasteners to be paid for separately) : For fixed portion Powder coated aluminium (minimum thickness of powder coating 50 micron)"	kg	2225.15			

41	<p>"Providing and fixing 12 mm thick prelaminated particle board flat pressed three layer or graded wood particle board conforming to IS: 12823 Grade I Type II, in panelling fixed in aluminum doors, windows shutters and partition frames with C.P. brass / stainless steel screws etc. complete as per architectural drawings and directions of engineer-in-charge.</p> <p>Pre-laminated particle board with decorative lamination on both sides"</p>	sqm	129.93			
42	<p>"Providing and fixing glazing in aluminium door, window, ventilator shutters and partitions etc. with EPDM rubber / neoprene gasket etc. complete as per the architectural drawings and the directions of engineer-in-charge. (Cost of aluminium snap beading shall be paid in basic item):</p> <p>With frosted glass panes of 5.0 mm thickness (weight not less than 12.50 kg/sqm)"</p>	sqm	104.72			
43	<p>"Filling the gap in between aluminium frame & adjacent RCC/ Brick/ Stone work by providing weather silicon sealant over backer rod of approved quality as per architectural drawings and direction of Engineer-in-charge complete.</p>	meter	76.72			

	Upto 5mm depth and 5 mm width"					
	Sanitary Fixtures And Fittings					
44	"Providing, fixing, testing and commissioning of white coloured vitreous china wall mounting European type water closet with CP bolts, nuts, CI chair or other hanging arrangement, with concealed PVC flushing cistern, 3/6 liters flushing capacity of Hindware- Concealo Neo(80 Mm) or approved equivalent including flush plates, internal fittings, slow falling seat cover with lid, C.P. brass hinges rubber buffers, with all accessories, including cutting and making good the wall and floors wherever required. Gap between fixtures and walls shall be filled up with approved polysulphide sealant, all complete as per specifications and direction of Engineer-In-Charge. Hindware Model No. ENIGMA 92024 / Parryware make or approved equivalent"	no	5.00			
45	"Providing, fixing, testing and commissioning of first quality white vitreous china wash basin with 32 mm dia C.P brass waste of standard pattern, 32mm dia C.P cast brass bottle trap Jaquar Model no. ALD-CHR-769L250X190 or approved equivalent, 32 mm dia C.P brass pipe to wall and CP wall	no	7.00			

	<p>flange, and rubber acceptors for waste connection, R.S. or C.I. painted brackets bolts, nuts, including making provision for faucets etc. cutting & making good the wall and floor, wherever required. Gap shall be filled with silicon sealant wherever required. All accessories shall be of Jaquar make or approved equivalent, all complete as per specifications and direction of Engineer-In-Charge.</p> <p>Hindware Model No- OPTRA 91008 / Parryware make or approved equivalent"</p>					
46	<p>"Providing, fixing, testing and commissioning of first quality white vitreous china wall mounted wash basin with pedestal , with 32mmdia C.P brass waste coupling of standard pattern, 32mmdia C.P cast brass bottle trap of Jaquar Model No ALD-CHR-769L250X190, 32mmdia C.P brass pipe to wall and CP wall flange and rubber acceptors for waste connection, C.I. painted brackets bolts, nuts, including making provision for pillar taps / Basin Mixers etc., cutting & making good the wall and floor, wherever required. Gap shall be filled with silicon sealant of approved equivalent wherever required. All complete as per standard design, specifications and direction of Engineer-in-charge.</p>	no	1.00			

	Hindware Model No- VIKING 10008 / Parryware make or approved equivalent"					
47	<p>"Providing, fixing, testing and commissioning of white coloured vitreous china large flat back battery based infrared sensor operated urinal basin having pre & post flushing capacity of 250 ml & 500 ml respectively, 32mm dia C.P cast brass bottle trap Jaquar Model no. ALD-CHR-769L250X190 or approved equivalent including C.I. hangers, 15mm dia inlet to built in spreaders with inbuilt waste with C.P flange, C.P Brass union and all accessories for fixing the urinal basin, cutting and making the walls and floors, wherever required. Gap between fixtures and walls shall be filled up with approved polysulphide sealant, all complete as per specifications and direction of Engineer-In-Charge.</p> <p>Hindware Model No. 60018 / Parryware make or approved equivalent"</p>	no	3.00			
48	"Providing, fixing, testing and commissioning of C.P brass single lever wash basin mixer with connecting legs & flanges including required accessories and fittings, all	no	7.00			

	complete as per specifications and direction of Engineer-In-Charge. Jaquar Model No. KUP-CHR-35011BPM / Plumber or Approved Equivalent"					
49	"Providing, fixing, testing and commissioning of C.P brass wash basin mixer with connecting legs & flanges including required accessories and fittings, all complete as per specifications and direction of Engineer-In-Charge. Jaquar Model No.CON-CHR-167KNB / Plumber or Approved Equivalent"	no	1.00			
50	"Providing & Fixing 15mm dia C.P. brass angle valves, as per IS: 8931 with C.P. nuts and washers, C.P. brass wall flange with any other items, all complete including cutting and making good the walls wherever required,all complete as per specifications and direction of Engineer-In-Charge. Jaquar Model No.CON-CHR-053KN / Plumber or Approved Equivalent"	no	22.00			
51	Providing and fixing 950 x 450 mm beveled edge mirror of superior glass (of approved quality) complete with 6 mm thick hard board ground fixed to wooden cleats with C.P.	no	4.00			

	brass screws and washers complete.					
52	Providing and fixing 2100 x 1200 mm beveled edge mirror of superior glass (of approved quality) complete with 6 mm thick hard board ground fixed to wooden cleats with C.P. brass screws and washers complete.	no	1.00			
53	"Providing and fixing health faucet with 1.2 meter long CP flexible pipe & wall hook as per approved brand as per direction of Engineer in Charge. Jaquar Model No. ALD-CHR-573/ Plumber or Approved Equivalent"	no	5.00			
54	Providing and fixing in position heavy duty SS floor drain grating of 100mm x 100mm size and anti cockroach trap type with cleanout facility and all fixed to the drainage system, all complete as per specifications and direction of Engineer-In-Charge.	no	11.00			
	Water Supply					
55	"Providing and fixing Chlorinated Polyvinyl Chloride (CPVC) pipes, having thermal stability for hot & cold water supply, including all CPVC plain & brass threaded fittings, including fixing the pipe with clamps at 1.00 m spacing. This includes jointing of pipes & fittings with one step CPVC solvent	meter	35.30			

	<p>cement and testing of joints complete as per direction of Engineer in Charge.</p> <p>Internal work - Exposed on wall</p> <p>25 mm nominal outer dia Pipes"</p>					
56	<p>"Providing and fixing Chlorinated Polyvinyl Chloride (CPVC) pipes, having thermal stability for hot & cold water supply, including all CPVC plain & brass threaded fittings, i/c fixing the pipe with clamps at 1.00 m spacing. This includes jointing of pipes & fittings with one step CPVC solvent cement and the cost of cutting chases and making good the same including testing of joints complete as per direction of Engineer in Charge.</p> <p>Concealed work, including cutting chases and making good the walls etc.</p> <p>20 mm nominal outer dia Pipes"</p>	meter	64.00			
57	<p>"Providing and fixing Polyvinyl Chloride (PVC) pipes, having thermal stability for cold water supply including all PVC plain threaded fittings This includes jointing of pipes & fittings with one step PVC solvent cement, trenching, refilling & testing of joints complete as per direction of Engineer in Charge.</p>	meter	24.00			

	External work 40 mm nominal outer dia Pipes"					
58	"Providing and fixing Polyvinyl Chloride (PVC) pipes, having thermal stability for cold water supply including all PVC plain threaded fittings This includes jointing of pipes & fittings with one step PVC solvent cement, trenching, refilling & testing of joints complete as per direction of Engineer in Charge. External work 110 mm nominal outer dia Pipes"	meter	14.40			
	False Ceiling Work					
59	"Providing and fixing false ceiling at all heights with integral densified calcium silicate reinforced with fibre and natural filler false ceiling tiles of Size 595x595mm of approved texture, design and patterns having NRC (Noise Reduction coefficient) of 0.50 (minimum) as per IS 8225:1987, Light reflectance of 85% (minimum). Non-combustible as per BS:476 (part-4), fire performance as per BS:476 (part 6 &7), humidity resistance of 100%, thermal conductivity <n0.043 W/m K as per ASTM 518:1991,in true horizontal level suspended on interlocking metal T-Grid of hot dipped	sqm	289.44			

	galvanized iron section of 0.33mm thick (galvanized @ 120 grams per sqm including both sides) comprising of main- T runners of size 24x38 mm of length 3000 mm, cross - T of size 24x32 mm of length 1200 mm and secondary intermediate cross-T of size 24x32 mm of length 600mm to form grid module of size 600 x 600 mm, suspended from ceiling using galvanized mild steel items (galvanizing @ 80 grams per sqm) i.e. 50 mm long, 8 mm outer diameter M-6 dash fasteners, 6 mm dia fully threaded hanger rod up to 1000 mm length and L-shape level adjuster of size 85x25x25x2 mm. Galvanized iron perimeter wall angle of size 24x24x0.40 mm of length 3000 mm to be fixed on periphery wall / partition with the help of plastic rawl plugs at 450 mm center to center and 40 mm long dry wall S.S screws. The work shall be carried out as per specifications, drawing and as per directions of the Engineer-in-Charge. With 15 mm thick tegular edged light weight calcium silicate false ceiling tiles."					
60	"Providing and fixing Metal framed suspended ceiling comprises of G. I perimeter channel having 0.55 mm thickness, two unequal flanges of 20 and 30 mm and web of	sqm	681.66			

	<p>27 mm is fixed to surrounding walls/partition using nylon sleeves and screws at 450 mm centres. Then intermediate channel (0.91mm thick) having two equal flanges of 15 mm each and a web of 45 mm is suspended from the soffit at 1220 mm centre with ceiling angle of width 25 mm x 10 mm x 0.55 mm thick, fixed to soffit with G.I cleat and steel expansion fasteners. Ceiling section of 0.55 mm thickness having knurled web of 50.5 mm and flanges of 26 mm each with lips of 10.5 mm are then fixed to the intermediate channel with connecting clips across to the Intermediate channel at 610/457 mm centers. 8 mm thick square/tapered edge Calcium Silicate Boards are then screw fixed along/across the ceiling sections with 25 mm long self-drilling & tapping screws having Phillips head with under head cutter, at 200 mm centres through the Calcium Silicate Board fillets</p> <p>10 mm Calcium Silicate Board thickness"</p>					
61	<p>Providing wood work in frames of false ceiling, partitions etc. sawn and fixed in position with necessary stainless steel screws etc. (For Trap Door of Ductable Split AC Indoor Unit)</p>	cum	9.00			

	Neem wood					
62	Providing and fixing in wall lining medium density fibre board IS: 14587:1998 marked, Pre-laminated one side decorative lamination and other side balancing lamination, with necessary fixing arrangement and screws etc. complete. (For Trap Door of Ductable Split AC Indoor Unit) 12 mm thick	sqm	35.91			
Miscellaneous Items						
63	Providing and fixing manually operated roller blinds of approved make, shade and colour including all accessories track, chain etc. The blinds shall extend minimum by 100 mm beyond all four sides of the opening. all complete at all levels and as per approved manufacturer's specification and direction of Engineer-In-Charge. Area of opening shall be measured for payment.	sqm	137.32			
Electrical Works						
64	Supply and installation of distribution board for Lighting, Power, Emergency & UPS circuit having incomer and outgoing details as mentioned below:					
64.1	Supplying and fixing of double door MS MCB distribution	no	1.00			

	<p>board for Lighting Circuit (LDB) 12 way TPN, 415 V, surface/ recess mounting, dust protected, duly powder painted, inclusive of tinned copper bus bar, common neutral link, earth bar, din bar for mounting MCB's as per incoming and outgoing details mentioned below:</p> <p>Incoming 40 amps 4P MCB, 10 kA C curve- 1 Nos.</p> <p>Outgoing 40 amps 2P RCCB (sensitivity: 300mA)-3 Nos. 10 amps Single Pole MCB 10kA-30 Nos.</p>					
64.2	<p>Supplying and fixing of double door MS MCB distribution board for Power Circuit (PDB) 12 way TPN, 415 V, surface/ recess mounting, dust protected, duly powder painted, inclusive of tinned copper bus bar, common neutral link, earth bar, din bar for mounting MCB's as per incoming and outgoing details mentioned below:</p> <p>Incoming 63 amps 4P MCB, 10 kA C curve - 1 Nos.</p> <p>Outgoing 63 amps 2P RCCB (sensitivity: 300mA) -3 Nos. 25 amps Single Pole MCB 10kA C curve -4 Nos.</p>	no	1.00			

	16 amps Single Pole MCB 10kA C curve -26 Nos.					
64.3	<p>Supplying and fixing of double door MS MCB distribution board for Emergency Circuit (EDB) 8 way TPN, 415 V, surface/ recess mounting, dust protected, duly powder painted, inclusive of tinned copper bus bar, common neutral link, earth bar, din bar for mounting MCB's as per incoming and outgoing details mentioned below:</p> <p>Incoming 40 amps 4P MCB, 10 kA C curve - 1 Nos.</p> <p>Outgoing 40 amps 2P RCCB (sensitivity: 300mA) -3 Nos. 10 amps Single Pole MCB 10kA C curve -18 Nos.</p>	no	1.00			
64.4	<p>Supplying and fixing of double door MS MCB distribution board for UPS supply, 12 way TPN, 415 V, surface/ recess mounting, dust protected, duly powder painted, inclusive of tinned copper bus bar, common neutral link, earth bar, din bar for mounting MCB's as per incoming and outgoing details mentioned below:</p> <p>Incoming 63 amps 4P MCB, 10 kA C curve - 1 Nos.</p> <p>Outgoing</p>	no	1.00			

	63 amps 2P RCCB (sensitivity: 300mA) -3 Nos. 16 amps Single Pole MCB 10kA C curve -30 Nos.					
65	Supplying, laying & commissioning of following 1100 volt grade FRLS PVC insulated copper conductor armoured cables from MDB (main distribution board) to each MCB box (mentioned in pt. 1.0) as per latest indian standard in existing trenches/shaft, cable trays, through false ceiling, ducts, clamped to wall with suitable clamps, suitable lug and Nickel plated double compression heavy duty brass cable gland and other accessories, protective covering and complete as required.					
65.1	From MDB to Lighting DB 4 core 16 sq. mm copper conductor armoured cable	meter	40.00			
65.2	From MDB to Power DB 4 core 16 sq. mm copper conductor armoured cable	meter	45.00			
65.3	From MDB to Emergency DB 4 core 16 sq. mm copper conductor armoured cable	meter	40.00			
65.4	From MDB to UPS DB 4 core 16 sq. mm copper conductor armoured cable	meter	45.00			
66	Circuit Wiring					

66.1	Wiring for circuit/submain wiring alongwith earth wire with the following sizes of FRLS PVC insulated copper conductor, single core cable in surface/ recessed good quality steel conduit (including wall cutting & making good) as required as per latest indian std./ CPWD guidelines, inclusive of supply and fitting of all required materials accessories e.g.: Junction boxes, lugs, ferrule etc. complete in all respect.					
66.1.1	For Power circuit 2 X 4 sq. mm + 1 X 4 sq. mm earth wire	meter	1341.00			
66.1.2	For Lighting circuit 2 X 2.5 sq. mm + 1 X 2.5 sq. mm earth wire	meter	945.00			
66.1.3	For Emergency circuit 2 X 2.5 sq. mm + 1 X 2.5 sq. mm earth wire	meter	626.00			
66.1.4	For UPS circuit 2 X 2.5 sq. mm + 1 X 2.5 sq. mm earth wire	meter	1160.0			
66.2	"Wiring for group controlled (looped) light point (without independent switch etc.) with 1.5 sq. mm FRLS PVC insulated copper conductor single core cable in surface/ recessed steel conduit, and earthing the point with 1.5 sq. mm FRLS PVC insulated copper conductor single core cable	meter	510.00			

	etc as required.” 2 X 1.5 sq. mm + 1 X 1.5 sq. mm earth wire					
67	Installation & Fixing of LED Lights as mentioned below					
67.1	"Supply, installation, testing & commissioning of Recessed mounted downlight luminaire cool white LED light (Ultraslim round panel, input power: 18W, IP20, 6500K, system flux: 1500 lm minimum, LED ceiling recessed light) after making suitable slot in the false ceiling for the light and covering it completely. Note: Warranty period for LED Lights should be 2 years from the date of installation. "	no	39.00			
67.2	Supply, installation, testing & commissioning of Recessed mounted downlight luminaire cool white LED light 2x2 ft. square panel (input power: 40 W, IP20, 6500K, system flux : 4400 lm minimum, LED ceiling recessed light) after making suitable slot in the false ceiling for the light and covering it completely. Lights should be hanged from ceiling without having load on false ceiling. Note: Warranty period for LED Lights should be 2 years from the date of installation. "	no	27.00			
67.3	"Supply, installation, testing & commissioning of wall	no	6.00			

	mounted 2 ft cool white LED batten (input power: 9 W, 6500K, system flux: 900 lumens minimum) complete in all respect. Note: Warranty period for LED Lights should be 2 years from the date of installation."					
67.4	"Supply, installation, testing & commissioning of wall mounted 4 ft cool white LED batten (input power: 28 W, 6500K, system flux: 3000 lumens minimum) complete in all respect. Note: Warranty period for LED Lights should be 2 years from the date of installation."	no	41.00			
68	Switches and Sockets					
68.1	Supplying and fixing suitable size GI box with modular plate and cover in front on surface or in recess, including providing and fixing 6 pin 5/6 & 15/16 A modular socket outlet and 15/16 A modular switch, connections etc. as required.	no	40.00			
68.2	Supplying and fixing following modules, GI box along with modular base & cover plate for modular switches in recess etc. as required.					
68.2.1	2 Module (75mm X 75mm)	no	22.00			

68.2.2	3 Module (100mm X 75mm)	no	2.00			
68.2.3	6 Module (200mm X 75mm)	no	6.00			
68.2.4	8 Module	no	48.00			
68.3	Supplying and fixing following modular switch/ socket on the existing modular plate & switch box including connections but excluding modular plate etc. as required					
68.3.1	10 A switch	no	65.00			
68.3.2	16 A switch	no	48.00			
68.3.3	6 A Socket	no	144.00			
69	Connection with available Earthing					
69.1	Providing and fixing G.I. wire on surface or in recess for loop earthing along with existing surface/ recessed conduit/submain wiring/ cable as per latest Indian standard / CPWD Guidelines as per requirement.	meter	90.00			
70	Cable Tray					
70.1	Supplying and installing following size of perforated painted with powder coating M.S. cable trays with perforation not more than 17.5%, in convenient sections, joined with connectors, suspended from the ceiling with M.S. suspenders including bolts & nuts, painting suspenders etc as required.	meter	70.00			

	300 mm width x 50 mm depth x 1.6 mm thickness					
71	For Installation of Air-conditioning System					
71.1	<p>Supplying and fixing of double door MS MCB distribution board 6 way TPN, 415 V, surface/ recess mounting, dust protected, duly powder painted, inclusive of tinned copper bus bar, common neutral link, earth bar, din bar for mounting MCB's as per incoming and outgoing details mentioned below:</p> <p>Incoming 1 No. 125 Amps 4 P MCCB 25kA Including Box. for short circuit, over current and earth fault protection - 1 No.</p> <p>Outgoing 40 amps 4P MCB, 10 kA C curve with ON/OFF indication for Lab Equipment - 5 Nos.</p>	no	2.00			
71.2	Supplying, laying & commissioning of following 1100 volt grade XLPE insulated PVC sheathed aluminium conductor armoured cables from MDB (main distribution board) to each MCB box (mentioned in pt. 1.0) as per latest Indian standard in existing trenches/shaft, cable trays, through false ceiling, ducts, clamped to wall with suitable clamps, suitable lug and Nickel plated double compression heavy	meter	80.00			

	duty brass cable gland and other accessories, protective covering and complete as required. 3.1/2 core 35 sq. mm Al armoured					
71.3	Supplying, laying & commissioning of following 1100 volt grade XLPE insulated PVC sheathed copper conductor armoured cables from MCB box to Indoor Unit as per latest Indian standard in existing trenches/shaft, cable trays, through false ceiling, ducts, clamped to wall with suitable clamps, suitable lug and Nickel plated double compression heavy duty brass cable gland and other accessories, protective covering and complete as required. 4 core 6 sq. mm	meter	325.00			
71.4	Providing and fixing G.I. wire on surface or in recess for loop earthing along with existing surface/ recessed conduit/submain wiring/ cable as per latest Indian standard / CPWD Guidelines as per requirement.	meter	325.00			
Ductable Split AC						
72	For Air Conditioning in Cabin 1 to 5 as per details shown in drawing					
72.1	Supply of 1 X 8.5 TR having Air flow Rate 3400 CFM	no	1.00			
72.2	Installation, testing and commissioning of Units for Air	set	1.00			

	Conditioning in following area through required Nos. of square shaped air diffusers / Powder coated extruded Aluminum grilles of approved shade and color with VCD, including all requirement as mentioned in the scope of work, complete in all respect : Location Area in sq. ft. Cabin-1 165.92 Cabin-2 191.96 Cabin-3 225.96 Cabin-4 225.96 Cabin-5 225.96					
73	For Air Conditioning in Cabin 6 to 10 as per details shown in drawing					
73.1	Supply of 1 X 8.5 TR having Air flow Rate 3400 CFM	no	1.00			
73.2	Installation, testing and commissioning of Units for Air Conditioning in following area through required Nos. of square shaped air diffusers / Powder coated extruded Aluminum grilles of approved shade and color with VCD, including all requirement as mentioned in the scope of work, complete in all respect : Location Area in Sq. ft.	set	1.00			

	Cabin-6 225.96 Cabin-7 225.96 Cabin-8 225.96 Cabin-9 191.64 Cabin-10 160.22					
74	For Air Conditioning in Lab-1 as per details shown in drawing					
74.1	Supply of 1 X 5.5 TR having Air flow Rate 2200 CFM	no	1.00			
74.2	Installation, testing and commissioning of Units for Air Conditioning in following area through required Nos. of square shaped air diffusers / Powder coated extruded Aluminum grilles of approved shade and color with VCD, including all requirement as mentioned in the scope of work, complete in all respect : Location Area in Sq. ft. Lab-1 517.02	set	1.00			
75	For Air Conditioning in Lab-2 as per details shown in drawing					
75.1	Supply of 2 X 5.5 TR having Air flow Rate 2200 CFM	no	2.00			
75.2	Installation, testing and commissioning of Units for Air Conditioning in following area through required Nos. of	set	2.00			

	square shaped air diffusers / Powder coated extruded Aluminum grilles of approved shade and color with VCD, including all requirement as mentioned in the scope of work, complete in all respect : Location Area in Sq. ft. Lab-2 1256.23					
76	For Air Conditioning in Lab-3 as per details shown in drawing					
76.1	Supply of 1 X 11 TR having Air flow Rate 4400 CFM	no	1.00			
76.2	Supply of 1 X 8.5 TR having Air flow Rate 3400 CFM	no	1.00			
76.3	Installation, testing and commissioning of Units for Air Conditioning in following area through required Nos. of square shaped air diffusers / Powder coated extruded Aluminum grilles of approved shade and color with VCD, including all requirement as mentioned in the scope of work, complete in all respect : Location Area in Sq. ft. Lab-3 1819.52	set	1.00			
77	For Air Conditioning in Lab-4 as per details shown in drawing					
77.1	Supply of 1 X 5.5 TR having Air flow Rate 2200 CFM	no	1.00			

77.2	<p>Installation, testing and commissioning of Units for Air Conditioning in following area through required Nos. of square shaped air diffusers / Powder coated extruded Aluminum grilles of approved shade and color with VCD, including all requirement as mentioned in the scope of work, complete in all respect :</p> <p>Location Area in Sq. ft. Lab-4 517.02</p>	set	1.00			
78	Drain Piping (Common piping only)					
78.1	Supply, installation, testing and commissioning of rigid heavy duty UPVC drain piping (20/25/32 mm dia) suitable for 10 kg/ sqcm pressure rating for indoor units complete with necessary elbow, tees, reducers, brass connector between GI and PVC pipe etc. All drain piping shall be insulated with 6mm thick sleeve of nitrile rubber.	meter	65.00			
79	Refrigerant copper piping					
79.1	Supply, Installation and testing of Interconnecting refrigerant Copper piping with nitrile rubber insulation with proper clamping.	meter	200.00			
80	Interconnecting Cable					
80.1	Supply and installation of control and transmission wiring	meter	215.00			

	between indoor and outdoor units complete in all respect.					
LAN NETWORKING						
81	Supplying and drawing of UTP 4 pair CAT 6 LAN Cable in recessed PVC conduit along with required accessories complete in all respect :					
81.1	1 run of cable	meter	600.00			
81.2	2 run of cable	meter	1500.00			
81.3	3 run of cable	meter	140.00			
82	Supplying and fixing of connector suitable for LAN cable					
82.1	Cat 6 RJ 45 Cable connector	no.	200.00			
83	Supplying and fixing of LAN I/O Network port complete in all respect					
83.1	RJ45 CAT6E LAN I/O Network Keystone Jack inclusive of Gang Box and Single Port Face Plate (Combo)	no.	115.00			
84	Supplying and fixing of Managed POE switch					
84.1	Supplying and fixing of 24 port Managed POE Network Switch (Cisco make, Cat 2960-CX)	no.	1.00			
Fire Fighting						
85	Supply, installation, testing and commissioning of ISI	no	23.0			

	marked (IS:2878) Fire Extinguisher, Carbon-di-oxide type capacity 4.5 Kg. flat base with wheel, pressure gauge and complete in all respect including initial fill with CO2 gas conforming to IS:307-1966					
Sub-Total						
GST @ 12%						
Grand Total (Sub Total + GST)						
Amount in Words:						

Note: L1 will be decided on overall L1 basis, not on individual items basis.