

Ref. RGIPT/JAIS/IWD/QE/2022-23/24

Date: 27.12.2022

To,

M/s [ Name of Vendor/Contractor]

Address [ Complete Address of Vendor/Contractor]

Email- .....

Contact No.....

GSTIN: .....

**Sub: Quotation enquiry for Granite Counter Slab & Aluminium Partition Work in Renewable Energy Lab at AB-1, 4<sup>th</sup> Floor, RGIPT Jais campus.**

Dear Sir,

We request you to submit your competitive rates (quotation) for Granite Counter Slab & Aluminium Partition Work in Renewable Energy Lab at AB-1, 4<sup>th</sup> Floor at RGIPT Jais campus as per the attached BOQ as **Annexure - 1**.

**Terms & Conditions:**

- a) The rate & amount should be on FOR basis.
- b) Quoted rate should be inclusive of **GST & Freight charges**.
- c) Quoted rate shall be valid for period of 2 months from the last date of submission of quotation.
- d) The items should be as per specifications mentioned in the enclosed BOQ.
- e) List of preferred makes of materials approved by the Engineer-in-Charge is attached as **Annexure - 2**. In case of non-availability of these makes, the Engineer-in-Charge may allow use of alternative makes of material.
- f) The quotation should be sent to us duly **Signed and Stamped** only in **Sealed Envelope** and Super scribed as **Ref. No.: RGIPT/JAIS/IWD/QE/2022-23/24, Quotation for Granite Counter Slab & Aluminium Partition Work in Renewable Energy Lab at AB-1, 4<sup>th</sup> Floor at RGIPT Jais** by registered post or by hand to the office of The Chairman, Institute Works Department, RGIPT Jais, Amethi.
- g) The quotation should be submitted within 15 days from the date of quotation enquiry i.e., the quotation should be received on or before 10.01.2023 by 04:00 PM. Quotation received after the due date, for whatever reason, will not be considered for evaluation.
- h) The order will be awarded to the vendor, whose rate will be lowest in grand total.
- i) The Institute reserves the right to accept/reject all or any part of the offer without assigning any reason thereof.
- j) Your sealed quotation should be addressed to: **The Chairman, Institute Works Department, Rajiv Gandhi Institute of Petroleum Technology Jais, Mukhetiya More, Harbanshganj, Tiloi, Amethi, UP - 229304.**

  
Executive Engineer (Civil)

Page 1 of 2

**BOQ for Granite Counter Slab & Aluminium Partition Work in Renewable Energy Lab, AB-1, RGIPT, Jais Campus**

S. No.	Description	Unit	Quantity	Rate (Rs.)	Total Amount (Rs.)
	<b>Granite Counter Slab</b>				
1	Steel reinforcement for R.C.C. work including straightening, cutting, bending, placing in position and binding all complete above plinth level. Thermo-Mechanically Treated bars of grade Fe-500D or more.	kg.	17.78		
2	Centering and shuttering including strutting, propping etc. and removal of form for Lintels, beams, plinth beams, girders, bressumers and cantilevers	sqm.	0.47		
3	Reinforced cement concrete work in beams, suspended floors, roofs having slope up to 15° landings, balconies, shelves, chajjas, lintels, bands, plain window sills, staircases and spiral stair cases above plinth level up to floor five level, excluding the cost of centering, shuttering, finishing and reinforcement, with 1:1.5:3 (1 cement : 1.5 coarse sand(zone-III) derived from natural sources: 3 graded stone aggregate 20 mm nominal size derived from natural sources).	cum.	0.42		
4	Half brick masonry with common burnt clay F.P.S. (non modular) bricks of class designation 7.5 in superstructure above plinth level up to floor V level Cement mortar 1:3 (1 cement :3 coarse sand)	sqm.	2.16		
5	12 mm cement plaster of mix : 1:4 (1 cement: 4 fine sand)	sqm.	2.16		
6	15 mm cement plaster on the rough side of single or half brick wall of mix : 1:4 (1 cement: 4 fine sand)	sqm.	2.16		
7	Providing and fixing 18 mm thick gang saw cut, mirror polished, premoulded and prepolished, machine cut for kitchen platforms, vanity counters, window sills, facias and similar locations of required size, approved shade, colour and texture laid over 20 mm thick base cement mortar 1:4 (1 cement : 4 coarse sand), joints treated with white cement, mixed with matching pigment, epoxy touch ups, including rubbing, curing, moulding and polishing to edges to give high gloss finish etc. complete at all levels. Granite stone slab all colour and texture except black, Cherry/Ruby red Area of slab over 0.50 sqm	sqm.	0.36		
8	Providing and applying white cement based putty of average thickness 1 mm, of approved brand and manufacturer, over the plastered wall surface to prepare the surface even and smooth complete.	sqm.	4.32		





**BOQ for Granite Counter Slab & Aluminium Partition Work in Renewable Energy Lab, AB-1, RGIPT, Jais Campus**

S. No.	Description	Unit	Quantity	Rate (Rs.)	Total Amount (Rs.)
9	Applying one coat of water thinnable cement primer of approved brand and manufacture on wall surface : Water thinnable cement primer	sqm.	4.32		
10	Wall painting with acrylic emulsion paint of approved brand and manufacture to give an even shade : Two or more coats on new work	sqm.	4.32		
	<b>Full Height Pre-laminated particle board aluminium partitions</b>				
11	Providing and fixing aluminium extruded section body tubular type universal hydraulic door closer (having brand logo with ISI, IS : 3564, embossed on the body, door weight upto 36 kg to 80 kg and door width from 701 mm to 1000 mm), with double speed adjustment with necessary accessories and screws etc. complete.	each	1.00		
12	Providing and fixing aluminium handles, ISI marked, anodised (anodic coating not less than grade AC 10 as per IS : 1868) transparent or dyed to required colour or shade, with necessary screws etc. complete : 125mm	each	2.00		
13	Providing and fixing aluminium hanging floor door stopper, ISI marked, anodised (anodic coating not less than grade AC 10 as per IS : 1868) transparent or dyed to required colour and shade, with necessary screws etc. complete. Twin rubber stopper	each	1.00		
14	Providing and fixing false ceiling at all heights with integral densified calcium silicate reinforced with fibre and natural filler false ceiling tiles of Size 595x595mm of approved texture, design and patterns as per CPWD Specification 2019, to be laid in true horizontal level suspended on inter-locking metal T-Grid of hot dipped galvanised iron section of 0.33mm thick (galvanized @ 120 grams per sqm including both sides) comprising of main-T runners of size 24x38 mm of length 3000 mm, cross - T of size 24x32 mm of length 1200 mm and secondary intermediate cross-T of size 24x32 mm of length 600mm to form grid module of size 600 x 600 mm, suspended from ceiling using galvanised mild steel items (galvanizing @ 80 grams per sqm) i.e. 12x50 mm long dash fasteners, 6 mm dia fully threaded hanger rod upto 1000 mm length and L-shape level adjuster of size 76x25x25x1.6 mm fixed with grid and Z cleat of size 25x37x25x1.6mm thick with precut hole on both 25mm flange to pierce into 12x50mm or even bigger size dash fastener if require, fixed with Glavanised iron perimeter wall angle or size 24x24x0.40 mm of length 3000 mm to be fixed on periphery wall / partition with the help of plastic rawl plugs at 450mm center to center and 40 mm long dry wall S.S screws. The work shall be carried out as per specifications, drawing and as per directions of the Engineer-in- Charge. With 15 mm thick Tegular edged light weight calcium silicate false ceiling tiles	sqm.	3.00		

**BOQ for Granite Counter Slab & Aluminium Partition Work in Renewable Energy Lab, AB-1, RGIPT, Jais Campus**

S. No.	Description	Unit	Quantity	Rate (Rs.)	Total Amount (Rs.)
15	Providing and fixing aluminium work for doors, windows, ventilators and partitions with extruded built up standard tubular sections/ appropriate Z sections and other sections of approved make conforming to IS: 733 and IS: 1285, fixing with dash fasteners of required dia and size, including necessary filling up the gaps at junctions, i.e. at top, bottom and sides with required EPDM rubber/ neoprene gasket etc. Aluminium sections shall be smooth, rust free, straight, mitred and jointed mechanically wherever required including cleat angle, Aluminium snap beading for glazing / paneling, C.P. brass / stainless steel screws, all complete as per architectural drawings and the directions of Engineer-in-charge. (Glazing, paneling and dash fasteners to be paid for separately) : For fixed portion Anodised aluminium (anodised transparent or dyed to required shade according to IS: 1868, Minimum anodic coating of grade AC 15)	kg.	116.02		
16	For shutters of doors, windows & ventilators including providing and fixing hinges/ pivots and making provision for fixing of fittings wherever required including the cost of EPDM rubber / neoprene gasket required (Fittings shall be paid for separately) Anodised aluminium (anodised transparent or dyed to required shade according to IS: 1868, Minimum anodic coating of grade AC 15)	kg.	10.95		
17	Providing and fixing 12 mm thick prelaminated particle board flat pressed three layer or graded wood particle board conforming to IS: 12823 Grade I Type II, in paneling fixed in aluminium doors, windows shutters and partition frames with C.P. brass / stainless steel screws etc. complete as per architectural drawings and directions of engineer-in-charge. Pre-laminated particle board with decorative lamination on both sides	sqm.	21.83		
18	Providing and fixing glazing in aluminium door, window, ventilator shutters and partitions etc. with EPDM rubber / neoprene gasket etc. complete as per the architectural drawings and the directions of engineer-in-charge . (Cost of aluminium snap beading shall be paid in basic item): With float glass panes of 5 mm thickness (weight not less than 12.50 kg/sqm)	sqm.	6.46		
A	<b>Sub-total Amount (Sr. No. 1 to 18)</b>				
B	<b>GST @18%</b>				
	<b>Total Amount inclusive of GST (Sr. No. A + B)</b>				



**LIST OF PREFERRED MAKES**

<b>SL.NO.</b>	<b>MATERIALS</b>	<b>MANUFACTURER/BRAND/MAKE</b>
1	CEMENT (OPC / PPC)	A.C.C., ULTRATECH, BIRLA, LAFARGE, JAYPEE CEMENT, SHREE CEMENT, J.K. CEMENT
2	WHITE CEMENT	J. K., BIRLA WHITE
3	REINFORCEMENT STEEL TMT Bars – Fe 500D or more	SAIL, RINL, JINDAL, ESSAR, JSW STEEL LTD, ISPAT, PARAS GOLD, KAMDHENU
4	CEMENT BASED WALL PUTTY	BIRLA WALL CARE, JK WHITE, ASIAN PAINTS, BERGER
5	ACRYLIC EMULSION PAINTS	ASIAN PAINTS/ ICI DULUX / NEROLAC/BERGER
6	CEMENT PRIMER	NEROLAC/BP WHITE (BERGER)/DECOPRIME-WT (ASIAN)/WHITE PRIMER (ICI)
7	ALUMINIUM SECTION	HINDALCO, JINDAL & INDIAN ALUMINIUM CO.
8	PRELAMINATED PARTICLE BOARD	GOOD QUALITY
9	HYDRAULIC DOOR CLOSER	GODREJ, OZONE, DORSET, DORMAKABA
10	CLEAR GLASS	SAINT GOBAIN, MODIGUARD, AIS
11	CALCIUM SILICATE BOARD	HILUX (RAMCO), PROMAT

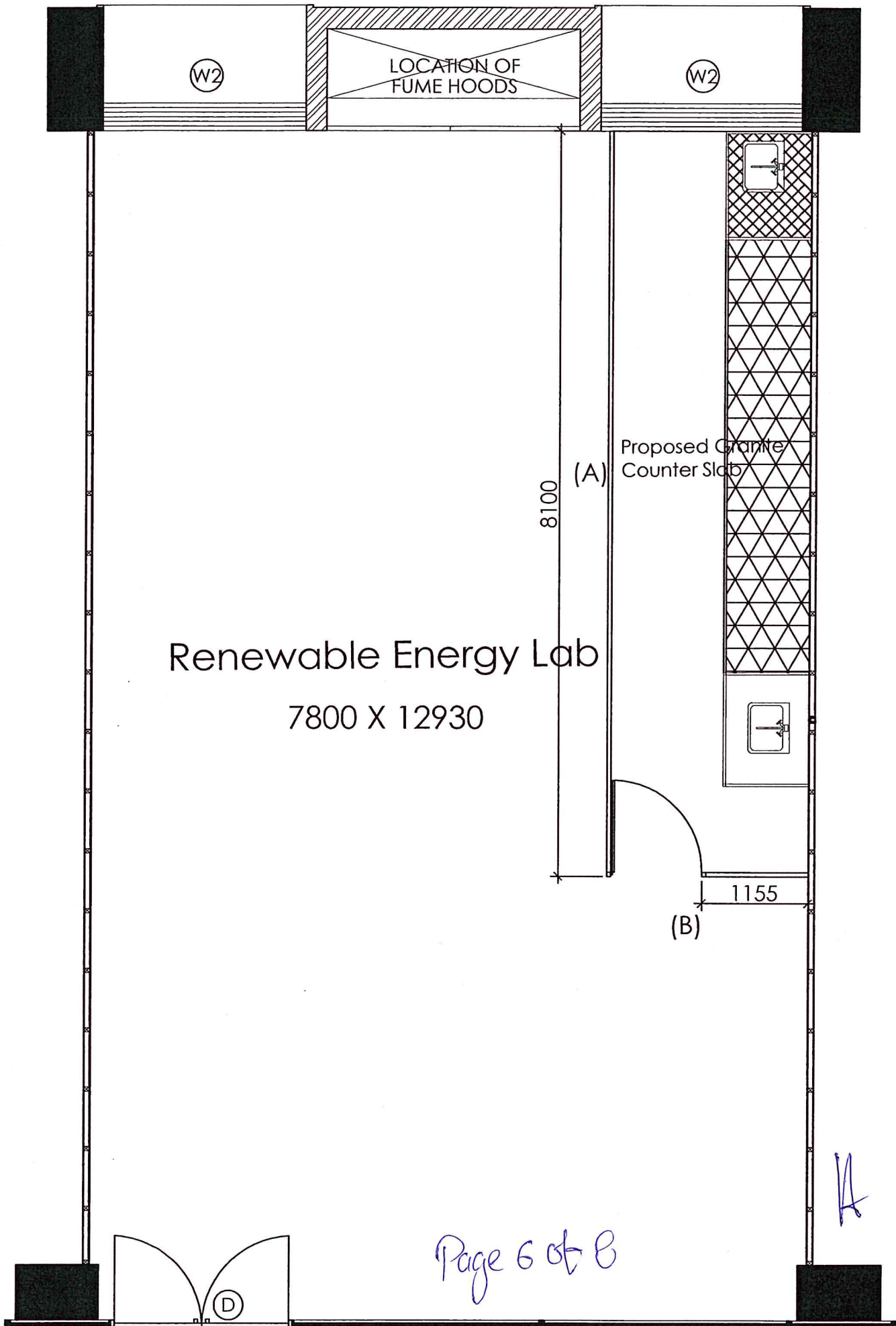

W2

LOCATION OF FUME HOODS

W2

8100

(A)

Proposed Granite Counter Slab

Renewable Energy Lab

7800 X 12930

1155

(B)

D

Page 6 of 8

A

Elevation (A) of Aluminium Partition work

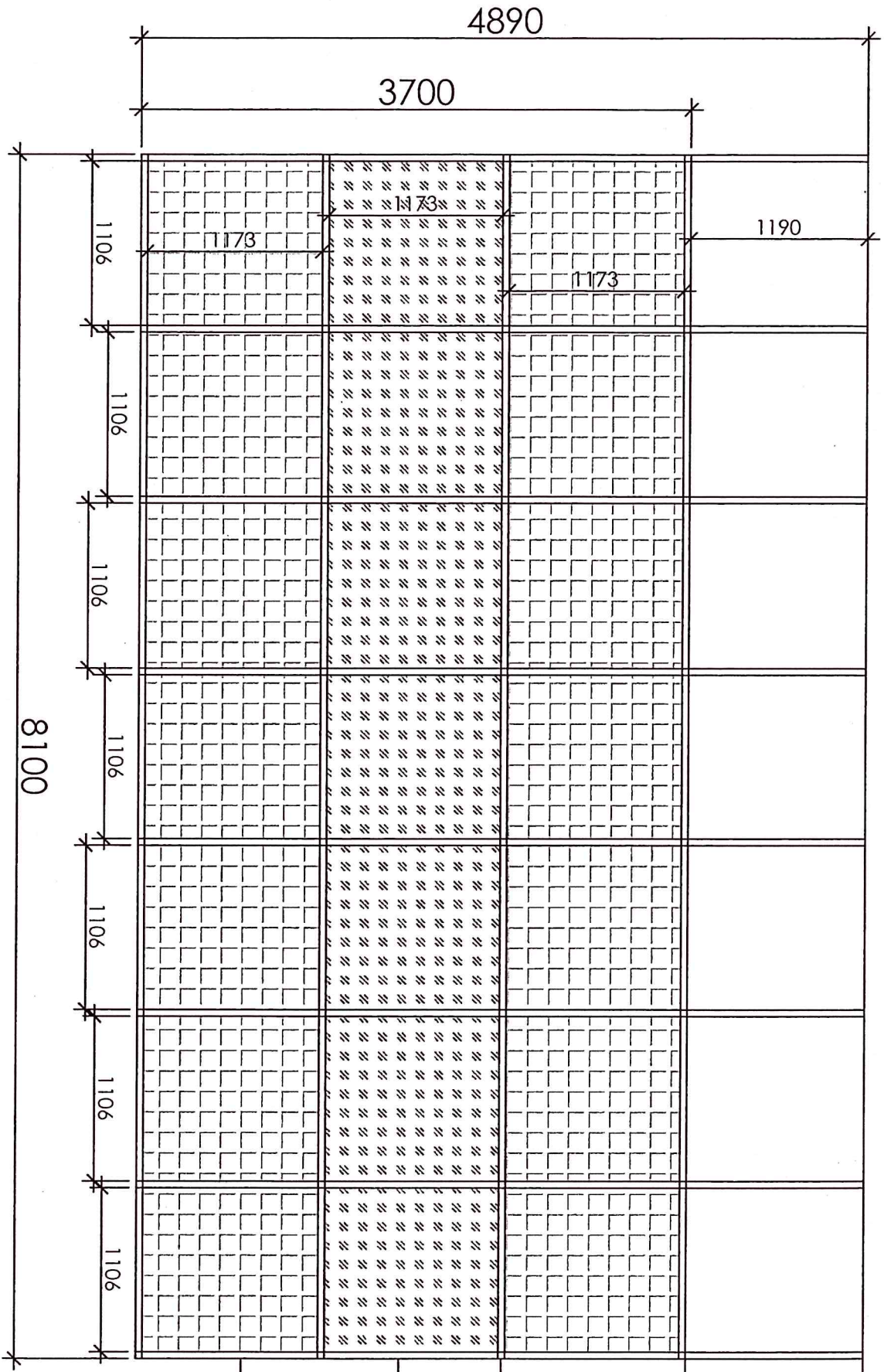

RCC Slab Level

False Ceiling Level

49.91 x 44.45 x 2 mm

5 mm thick clear glass

12 mm Thick  
Pre Laminated  
Particle Board



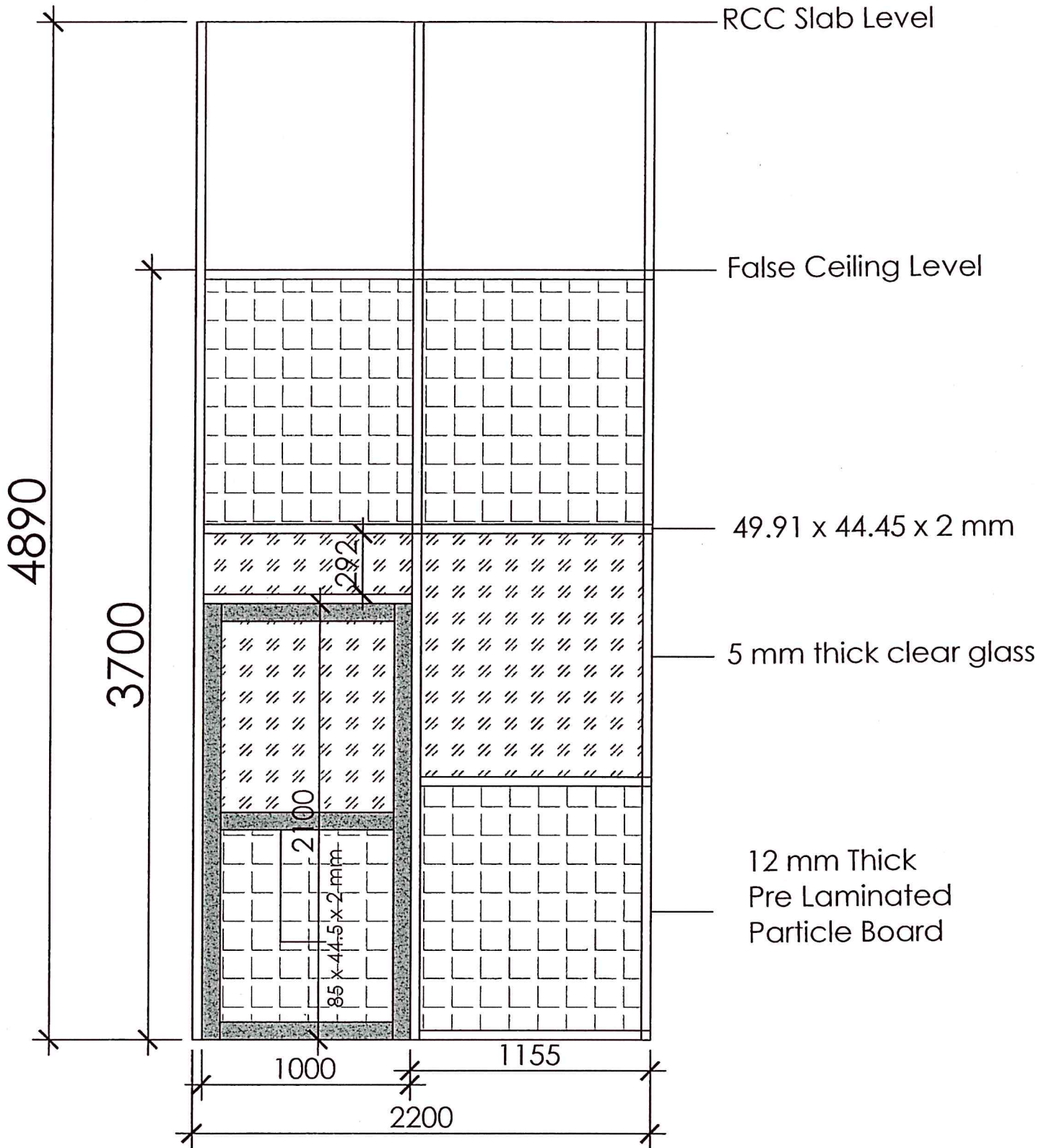

Elevation (B) of  
Aluminium  
Partition Work