



Ref. RGIPT/JAIS/IWD/QE/2025-26/10

Date: 08.08.2025

To,

M/s [Name of Agency/Contractor],

Address:

Email-

Contact No.

GSTIN:

Sub: Quotation enquiry for Aluminium Partition Work in Research Lab at RGIPT, Jais Campus.

Dear Sir,

We request you to submit your competitive rates (quotation) for Aluminium Partition work in Research Lab at RGIPT, Jais campus as per the attached BOQ as **Annexure – 1**.

Terms & Conditions:

- The quoted rate should be inclusive of **GST & Freight charges**. Agency is requested to only fill the required data in BOQ, no extra terms and condition should be mentioned by the Agency. If he does so, then the quotation of that agency will be summarily rejected.
- The quoted rate shall be valid for a period of 60 days from the last date of submission of quotation.
- GST number should be mentioned in the quotation.
- The total time for completion of work will be 15 days. The date of commencement shall be reckoned from the date of acceptance of Work Order.
- No advance payment will be made. The agency should inspect the site before quoting the rate.
- The quantity of items in BOQ is tentative which may change depending upon the site conditions.
- The work will be carried out as per technical specification, drawings & satisfaction of Engineer-in-Charge.
- In case of any damage and delay in completion of work, liquidated damages (LD) at the rate of 0.5% of the work order value per week of delay or part thereof, subject to a maximum of 10% of the work order value shall be recovered from the agency/contractor bills.
- The quotation should be sent to us duly **Signed and Stamped** only in **Sealed Envelope** and Super scribed as **Ref. No. RGIPT/JAIS/IWD/QE/2025-26/10, Quotation for Aluminium Partition Work in Research Lab at RGIPT, Jais Campus** by registered post or by hand to the office of The Chairman, Institute Works Department, Rajiv Gandhi Institute of Petroleum Technology Jais, Mukhetiya More, Harbanshganj, Tiloi, Amethi, UP – 229304.
- The quotation should be submitted within 10 days from the date of quotation enquiry i.e., the quotation should be received on or before 18.08.2025 by 04:00 PM. Quotation received after the due date, for whatever reason, will not be considered for evaluation.
- The order will be awarded to the Agency/Contractor, whose rate will be lowest in terms of the grand total.
- The Institute reserves the right to accept/reject all or any part of the offer without assigning any reason thereof.

Executive Engineer (Civil)

Page 1 of 6

Rajiv Gandhi Institute of Petroleum Technology ,Jais, Amethi

Aluminium Partition Work in Research Lab

S.No.	Description	Unit	Qty.	Rate (Rs.)	Amount (Rs.)
1	Aluminium partition work as per technical specification, attached drawing and complete as per direction of Engineer-in-Charge	Sqft	500.88		
2	GST @ 18% on S . No. "1"				
Total Amount (S. No. 1 + 2)					



Page 2 of 6

Rajiv Gandhi Institute of Petroleum Technology ,Jais, Amethi

Technical Specification for Aluminium Partition Work in Research Lab

S. No.	Description	Unit	Approx Qty
1	Providing and fixing aluminium handles, ISI marked, anodised (anodic coating not less than grade AC 10 as per IS : 1868) transparent or dyed to required colour or shade, with necessary screws etc. complete : 125mm	each	2.00
2	Providing and fixing bright finished 100 mm mortice lock with 6 levers without pair of handles of approved quality for aluminum door , with necessary screws etc complete as per direction of Engineer-in-charge	each	1.00
3	Providing and fixing aluminium work for doors, windows, ventilators and partitions with extruded built up standard tubular sections/ appropriate Z sections and other sections of approved make conforming to IS: 733 and IS: 1285, fixing with dash fasteners of required dia and size, including necessary filling up the gaps at junctions, i.e. at top, bottom and sides with required EPDM rubber/ neoprene gasket etc. Aluminium sections shall be smooth, rust free, straight, mitred and jointed mechanically wherever required including cleat angle, Aluminium snap beading for glazing / paneling, C.P. brass / stainless steel screws, all complete as per architectural drawings and the directions of Engineer-in-charge. (Glazing, paneling and dash fasteners to be paid for separately) : For fixed portion Powder coated aluminium (minimum thickness of powder coating 50 micron)	kg.	171.68
4	For shutters of doors, windows & ventilators including providing and fixing hinges/ pivots and making provision for fixing of fittings wherever required including the cost of EPDM rubber / neoprene gasket required (Fittings shall be paid for separately) Powder coated aluminium (minimum thickness of powder coating 50 micron)	kg.	14.24
5	Providing and fixing glazing in aluminium door, window, ventilator shutters and partitions etc. with EPDM rubber / neoprene gasket etc. complete as per the architectural drawings and the directions of engineer-in-charge . (Cost of aluminium snap beading shall be paid in basic item): With float glass panes of 5 mm thickness (weight not less than 12.50 kg/sqm)	sqm.	19.74
6	Providing and fixing 4 mm thick aluminium composite panel (ACP), in panelling fixed in aluminum doors, windows shutters and partition frames with C.P. brass / stainless steel screws etc. complete as per architectural drawings and directions of engineer-in-charge.	sqm.	22.68
7	Providing and fixing good quality PVC sliding roller with SS screws etc. complete as per direction of Engineer-in-charge	each	2.00
8	Providing and fixing of good quality PVC door buffer with SS screws etc. complete as per direction of Engineer-in-charge	each	1.00
Area of Aluminium Partition			
	Elevation A	Sqm.	10.94
	Elevation B	Sqm.	22.69
	Ceiling	Sqm.	12.92
	Total Area (Sqmt)		46.55
	Total Area (Sqft)		500.88



Page 3 of 6

LIST OF PREFERRED MAKES

SL.NO.	MATERIALS	MANUFACTURER/BRAND/MAKE
1	ALUMINIUM SECTION	HINDALCO, JINDAL & INDIAN ALUMINIUM CO.
2	CLEAR GLASS, TOUGHENED GLASS	SAINT GOBAIN, MODIGUARD, AIS
3	HYDRAULIC DOOR CLOSER	GODREJ, OZONE, DORSET, DORMAKABA
4	MORTICE LOCK	GODREJ, OZONE, DORSET, DORMAKABA
5	WEATHER SILICON SEALANT	DOW CORNING, WAKER, PIDILITE (DR. FIXIT/ROFF), BASF

Note: Makes of misc. raw material items to be used by agency/contractor for construction of aluminium partition work will be according to the list of above preferred make given. No other make will be used by bidder. In case any material/ product is not available in the market, alternate product as per decision and approval of Rajiv Gandhi Institute of Petroleum Technology (RGPT) shall be used by the bidder.



Page 4 of 6

101.60 x 44.50 x 2 mm

3530 [11'-9 $\frac{1}{4}$ "]

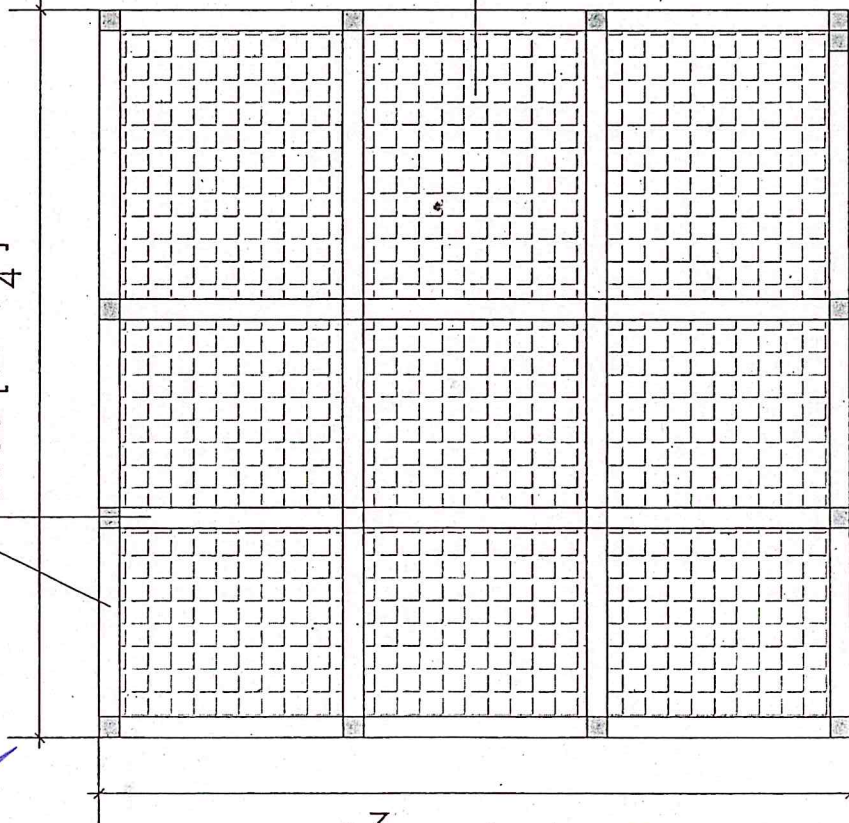

Ceiling Plan

3660 [12'-2 $\frac{1}{2}$ "]

Page 5 of 6

3530 [11'-9 $\frac{1}{4}$ "]

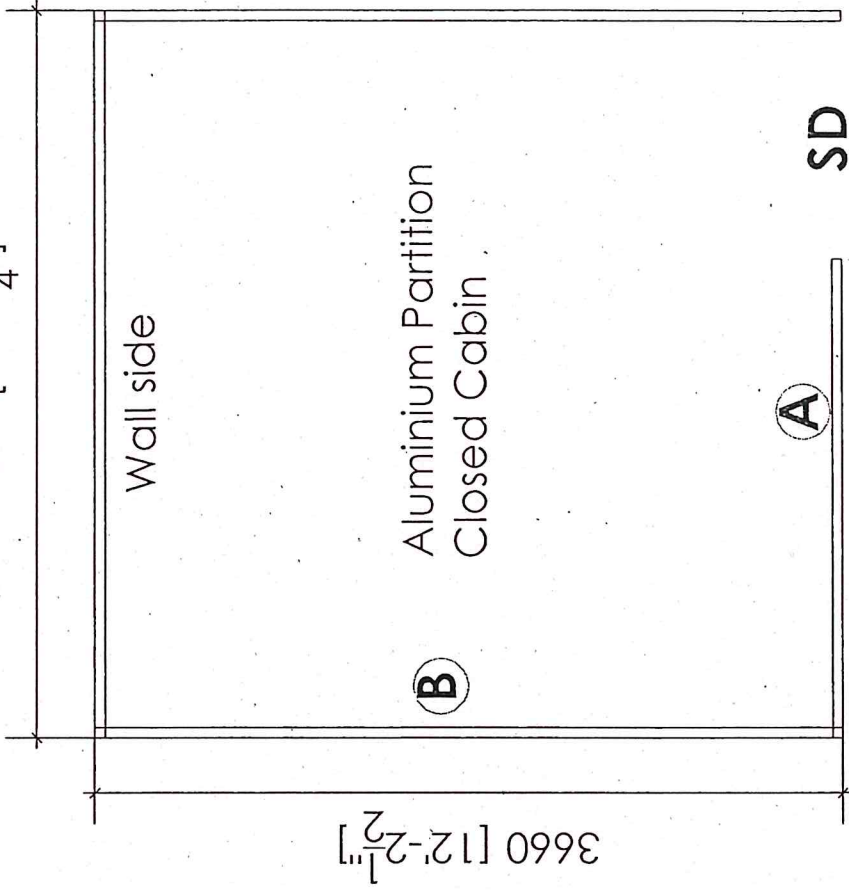

8

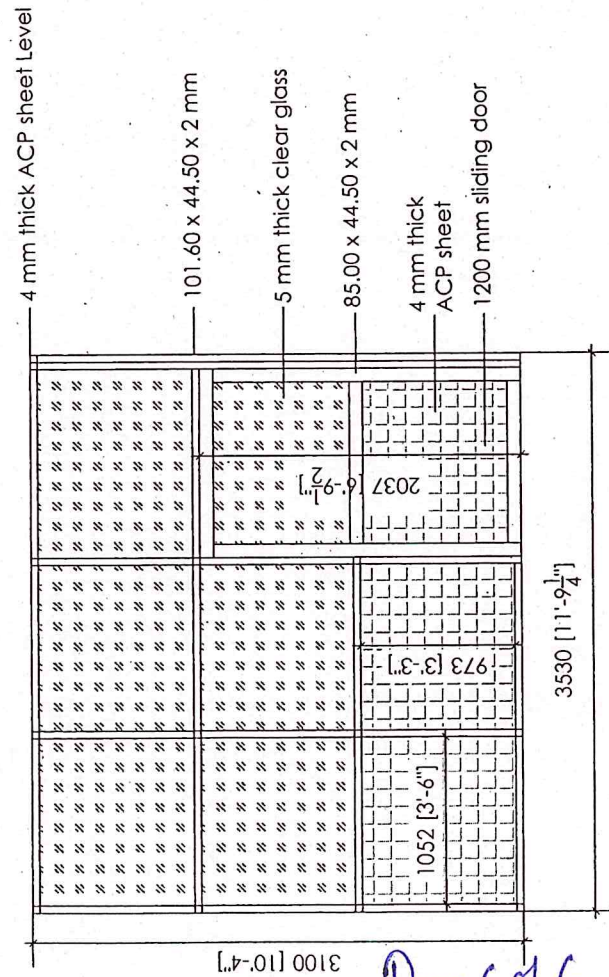

Elevation (A) of Aluminium Partition work

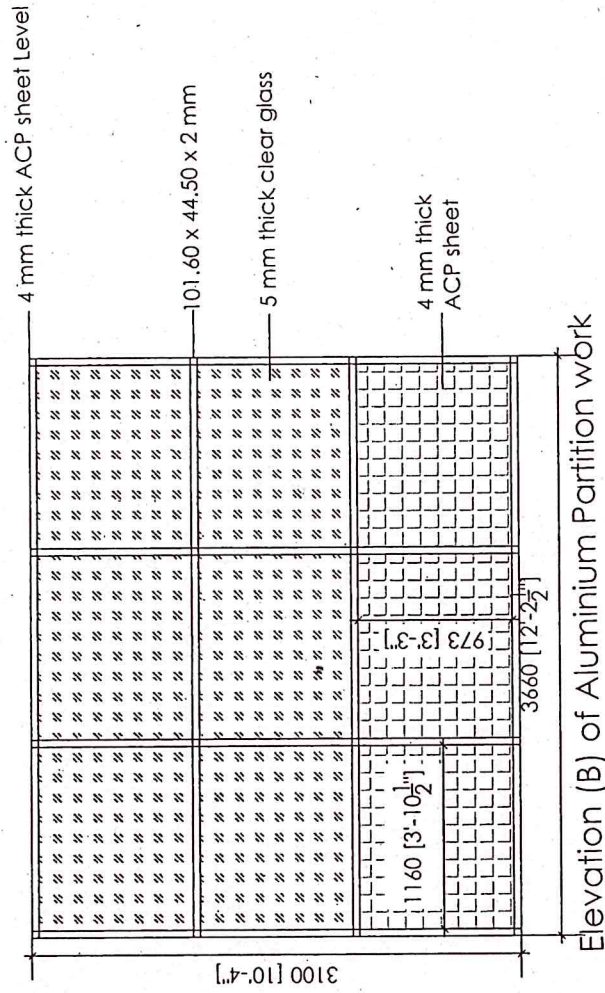

Elevation (B) of Aluminium Partition work

18